



**BOURNS®**

**Features**

- Integrated digital contacting encoder
- Mounts directly to the PCB
- Can be integrated into any circuit
- Detented versions available
- Long operating life

**Applications**

- Medical instrumentation
- Test and measurement equipment
- Audio equipment
- Climate control
- Home lighting
- Home automation

**01943-1 Series Front Mount Module**

Bourns 01943-1 Series Front Mount Module is designed for integration into any Printed Circuit Board and completes the value-added solution for Integrated Panel Control applications. Competitive features result in cost savings, reduced inventory, and improved reliability.

**Encoder Characteristics**

Closed Circuit Resistance .....	5 ohms maximum
Open Circuit Resistance .....	100 K ohms minimum
Contact Rating .....	.10 milliamps @ 10 VDC
Electrical Travel .....	Continuous

**Environmental Characteristics**

Operating Temperature Range .....	-40 °C to +125 °C
Storage Temperature Range .....	-40 °C to +140 °C
Life .....	.200 K revolutions
Vibration .....	15 G
Humidity .....	Per MIL-STD-202, Method 103B, Condition B

**Product Dimensions**

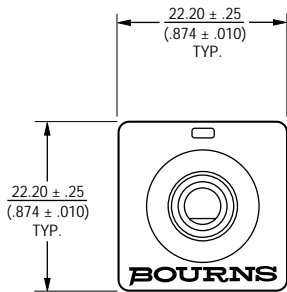

FRONT VIEW

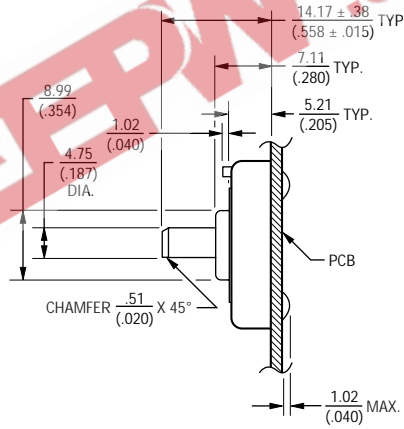

SIDE VIEW

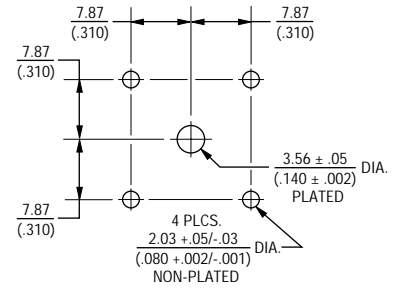

PCB HOLE DIMENSIONS

DIMENSIONS:  $\frac{MM}{(IN.)}$

# 01943-1 Series Front Mount Module

**BOURNS®**

## How To Order

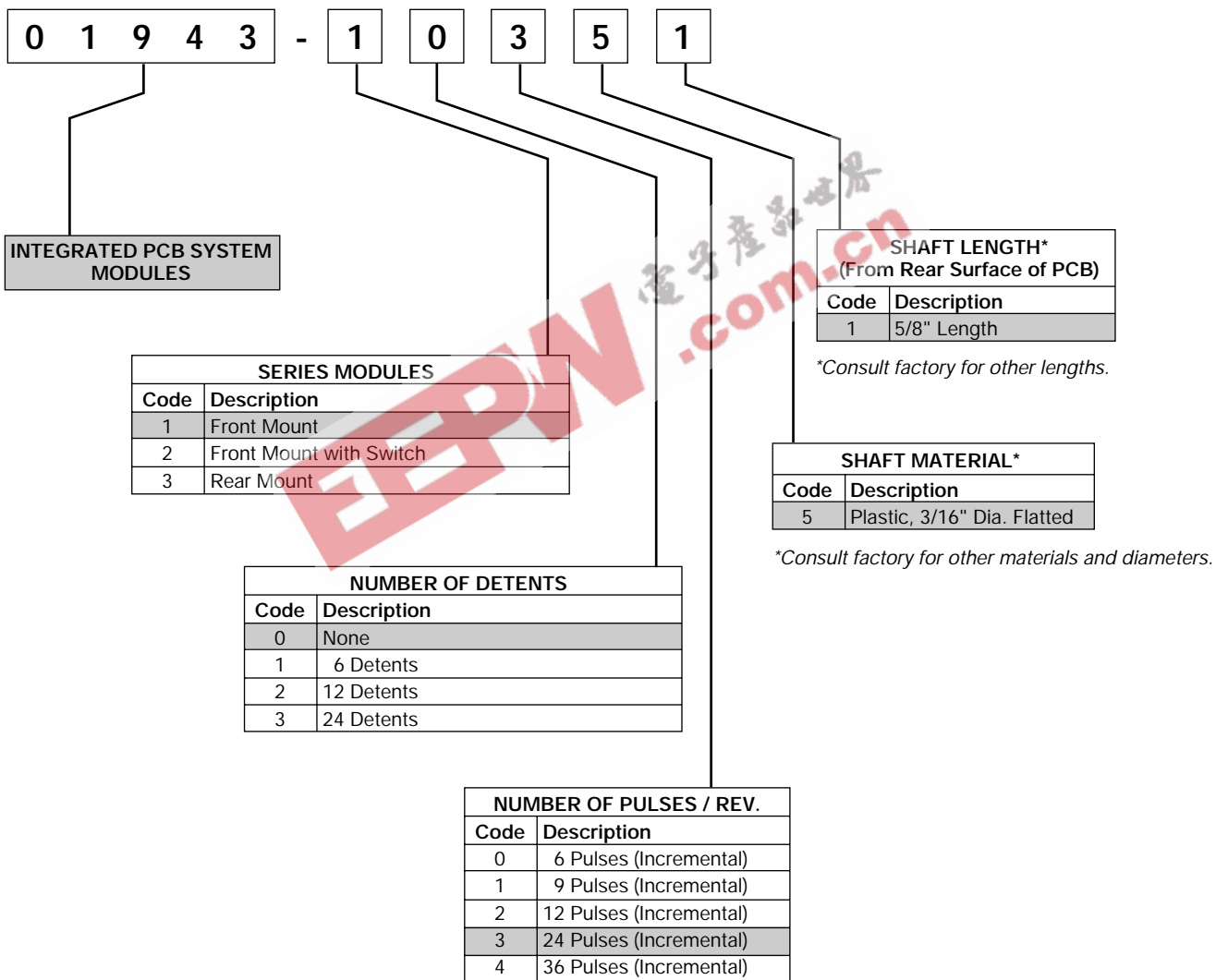

**NOTE:** This chart illustrates the numbering system for the module level only. Each Integrated PCB system will require several modules in addition to the PCB and electronic components that are unique to each application.