

200 V - 1,000 V Single Phase Bridge

3.0 A Forward Current

70 ns - 3000 ns Recovery Time

1202A - 1210A
1202FA - 1210FA
1202UFA - 1210UFA

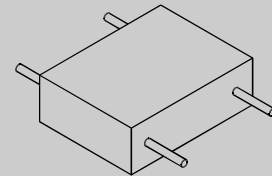

ELECTRICAL CHARACTERISTICS AND MAXIMUM RATINGS

Part Number	Working Reverse Voltage (Vrwm)	Average Rectified Current @TC (Io)		Reverse Current @ Vrwm (Ir)		Forward Voltage (Vf)		1 Cycle Surge Current tp=8.3ms (Ifsm)	Repetitive Surge Current (Ifrm)	Reverse Recovery Time (1) (Trr)	Thermal Impd. θ_{J-C}
		55°C	100°C	25°C	100°C	25°C	25°C	25°C	25°C	25°C	°C/W
	Volts	Amps	Amps	µA	µA	Volts	Amps	Amps	Amps	ns	
1202A	200	3.0	1.8	1.0	25	1.1	3.0	150	25	3000	21
1206A	600	3.0	1.8	1.0	25	1.1	3.0	150	25	3000	21
1210A	1000	3.0	1.8	1.0	25	1.1	3.0	150	25	3000	21
1202FA	200	3.0	1.8	1.0	25	1.5	3.0	100	20	150	21
1206FA	600	3.0	1.8	1.0	25	1.5	3.0	100	20	150	21
1210FA	1000	3.0	1.8	1.0	25	1.5	3.0	100	20	150	21
1202UFA	200	3.0	1.8	1.0	25	1.7	3.0	100	20	70	21
1206UFA	600	3.0	1.8	1.0	25	1.7	3.0	100	20	70	21
1210UFA	1000	3.0	1.8	1.0	25	1.7	3.0	100	20	70	21

(1)Trr Testing: If=0.5A, Ir=1.0A, Irr=0.25A *Op. Temp.= -55°C to +150°C Stg. Temp.= -55°C to +150°C

10

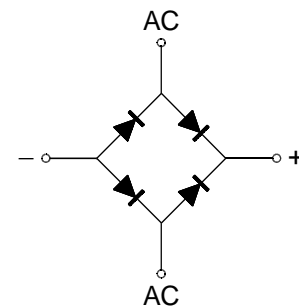
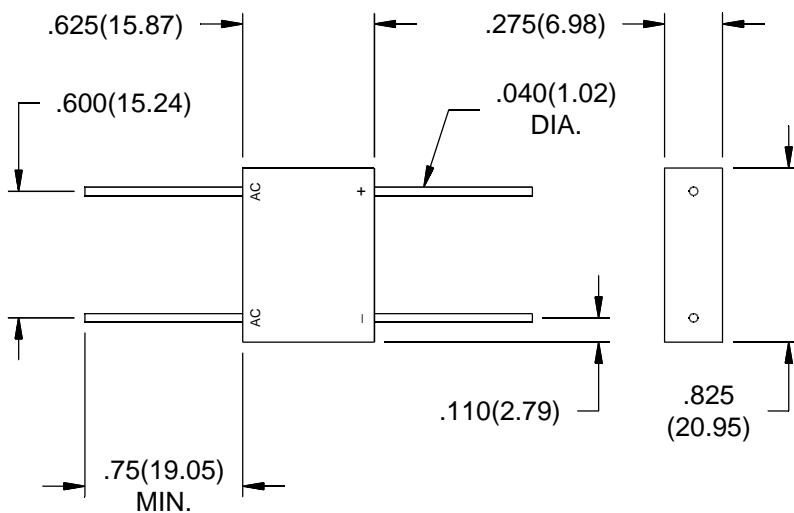

Dimensions: In. (mm) • All temperatures are ambient unless otherwise noted. • Data subject to change without notice.



VOLTAGE MULTIPLIERS INC.
 8711 W. Roosevelt Ave.
 Visalia, CA 93291

TEL 559-651-1402
 FAX 559-651-0740
 www.voltagemultipliers.com

1202A - 1210A • 1202FA - 1210FA • 1202UFA - 1210UFA

