

# 2.00mm (0.079") PITCH CONNECTOR

Board-In  
Housing

YBH200 Series

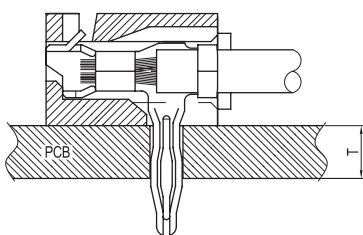
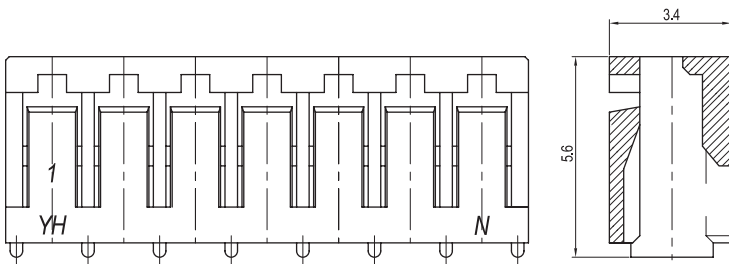
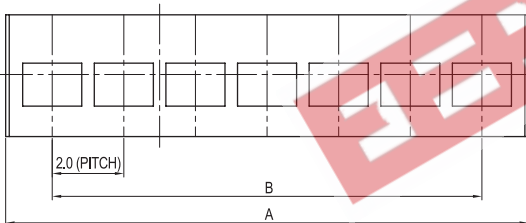
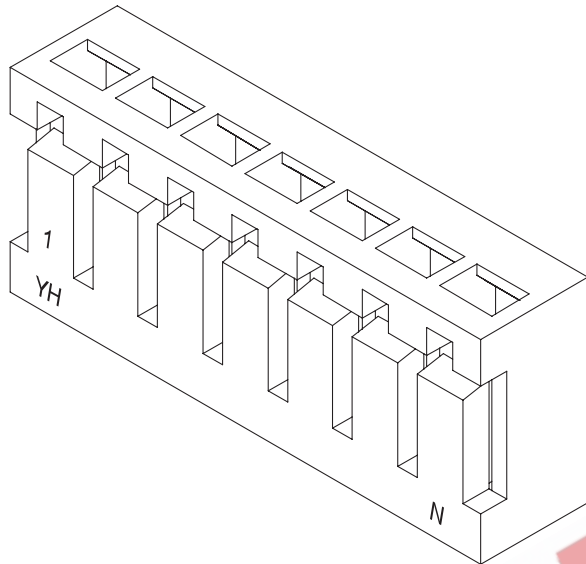

TERMINAL ASSEMBLY DRAWING

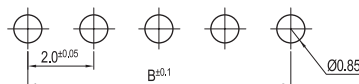

PCB LAYOUT

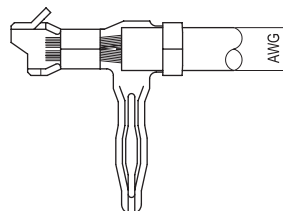

AWG : #26 ~ #30

## Material

I/NO	DESCRIPTION	TITLE	MATERIAL
1	HOUSING	YBH200	PA66, UL 94V Grade

## Available Pin

PARTS NO.	A	B
YBH200-02	4.5	2.0
YBH200-03	6.5	4.0
YBH200-04	8.5	6.0
YBH200-05	10.5	8.0
YBH200-06	12.5	10.0
YBH200-07	14.5	12.0
YBH200-08	16.5	14.0
YBH200-09	18.5	16.0
YBH200-10	20.5	18.0
YBH200-11	22.5	20.0
YBH200-12	24.5	22.0
YBH200-13	26.5	24.0
YBH200-14	28.5	26.0
YBH200-15	30.5	28.0

## Specification

ITEM	SPEC
Voltage Rating	AC/DC 250V
Current Rating	AC/DC 2A
Operating Temperature	-25°C~+85°C
Contact Resistance	-
Withstanding Voltage	AC1000V/1min
Insulation Resistance	1000MΩ MIN
Applicable Wire	AWG #26~#30
Applicable P.C.B	1.2mm~1.6mm
Applicable FPC/FFC	-
Solder Height	-
Crimp Tensile Strength	-
UL FILE NO	E108706

Application Terminal : YBAT200 (110 page)