

Silicon PNP Power Transistors

2SA1216

DESCRIPTION

- With MT-200 package
- Complement to type 2SC2922

APPLICATIONS

- Audio and general purpose

PINNING(see Fig.2)

PIN	DESCRIPTION
1	Base
2	Collector;connected to mounting base
3	Emitter

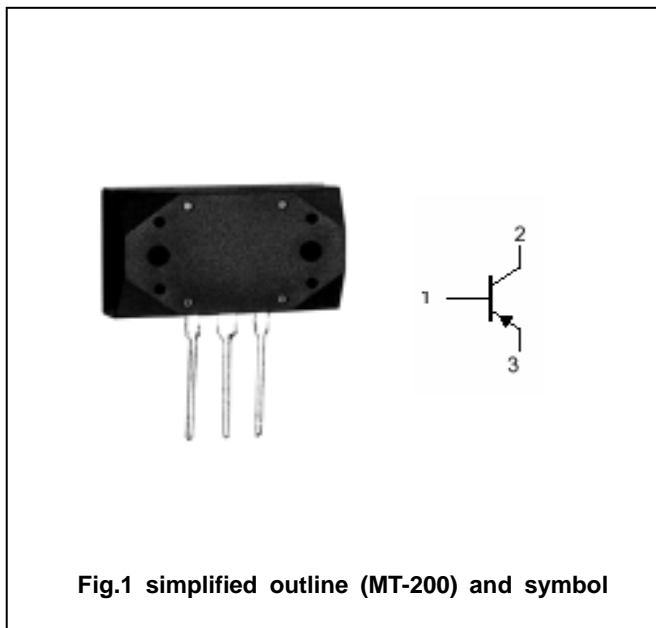

Fig.1 simplified outline (MT-200) and symbol

Absolute maximum ratings(Ta=25)

SYMBOL	PARAMETER	CONDITIONS	VALUE	UNIT
V_{CBO}	Collector-base voltage	Open emitter	-180	V
V_{CEO}	Collector-emitter voltage	Open base	-180	V
V_{EBO}	Emitter-base voltage	Open collector	-5	V
I_C	Collector current		-17	A
I_B	Base current		-5	A
P_C	Collector power dissipation	$T_C=25$	200	W
T_j	Junction temperature		150	
T_{stg}	Storage temperature		-55~150	

Silicon PNP Power Transistors

2SA1216

CHARACTERISTICS

T_j=25 unless otherwise specified

SYMBOL	PARAMETER	CONDITIONS	MIN	TYP.	MAX	UNIT
V _{(BR)CEO}	Collector-emitter breakdown voltage	I _C =-25mA ; I _B =0	-180			V
V _{CEsat}	Collector-emitter saturation voltage	I _C =-8A ; I _B =-0.8A			-2.0	V
I _{CBO}	Collector cut-off current	V _{CB} =-180V ; I _E =0			-100	μ A
I _{EBO}	Emitter cut-off current	V _{EB} =-5V ; I _C =0			-100	μ A
h _{FE}	DC current gain	I _C =-8A ; V _{CE} =-4V	30			
C _{ob}	Output capacitance	I _E =0 ; V _{CB} =-10V ; f=1MHz		500		pF
f _T	Transition frequency	I _C =-2A ; V _{CE} =-12V		40		MHz

Switching times

t _{on}	Turn-on time	I _C =-10A ; R _L = I _{B1} =-I _{B2} =-1A V _{CC} =-40V		0.30		μ s
t _s	Storage time			0.70		μ s
t _f	Fall time			0.20		μ s

◆ h_{FE} classifications

O	Y	P	G
30-60	50-100	70-140	90-180

Silicon PNP Power Transistors

2SA1216

PACKAGE OUTLINE

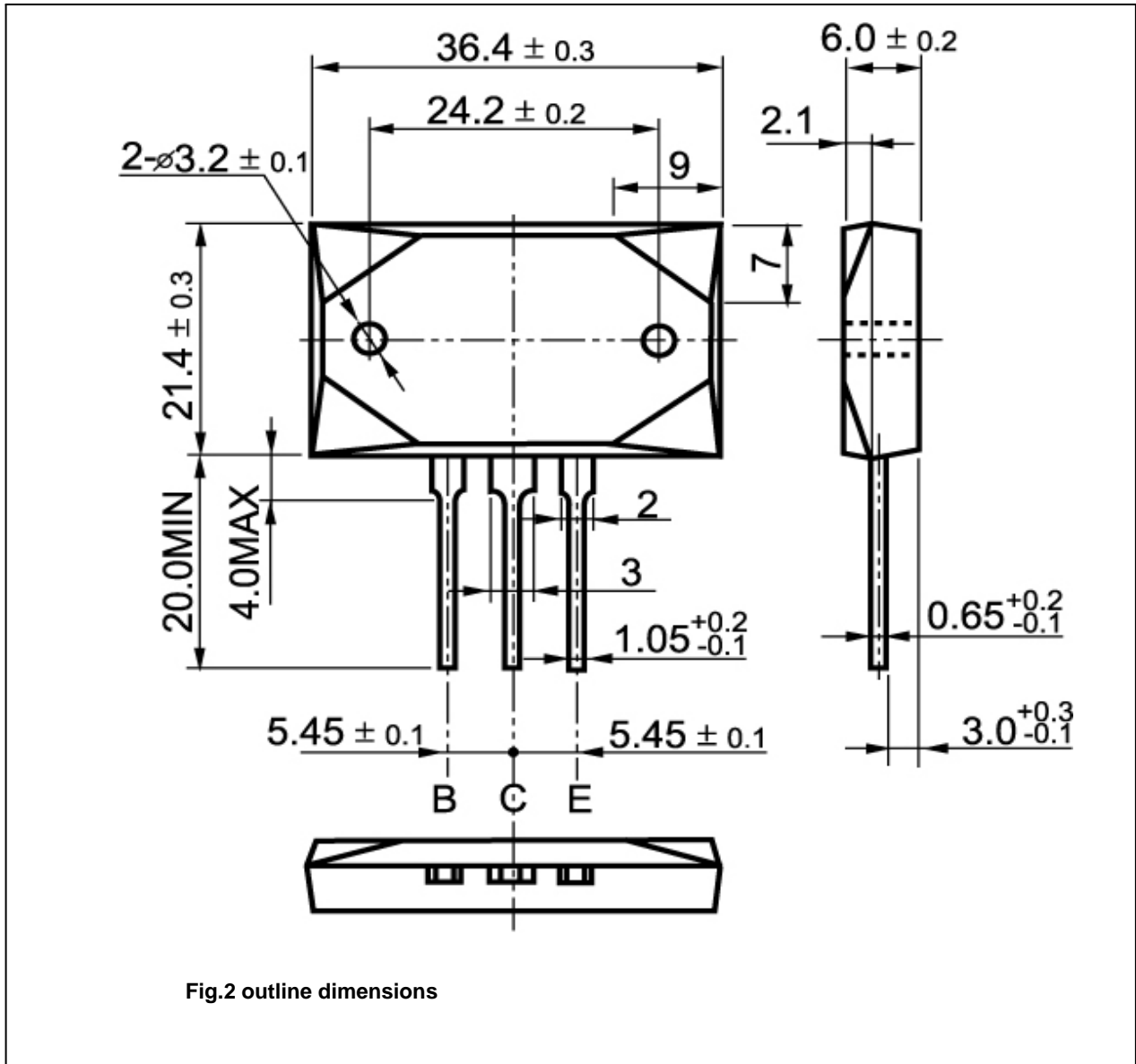

Silicon PNP Power Transistors

2SA1216

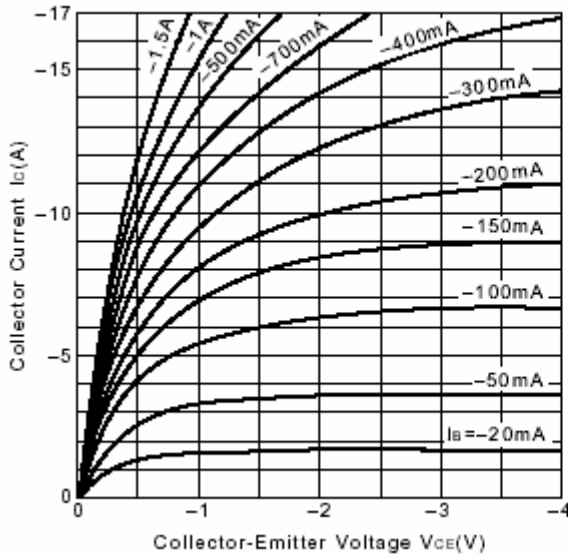

Fig.3 Static Characteristic

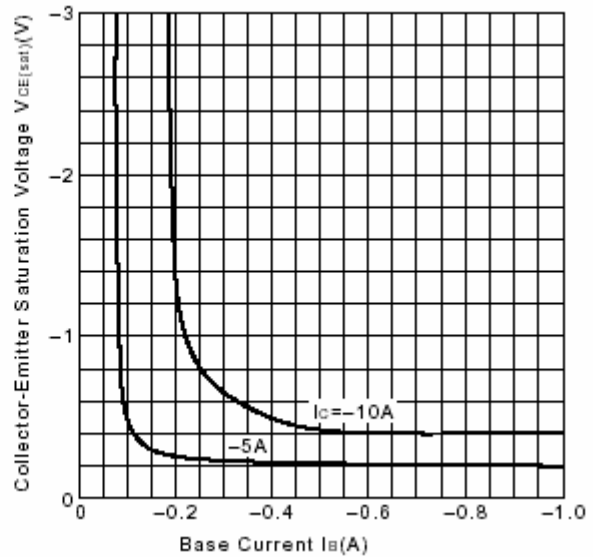

Fig.4 $V_{CE(sat)}$ - I_B Characteristics

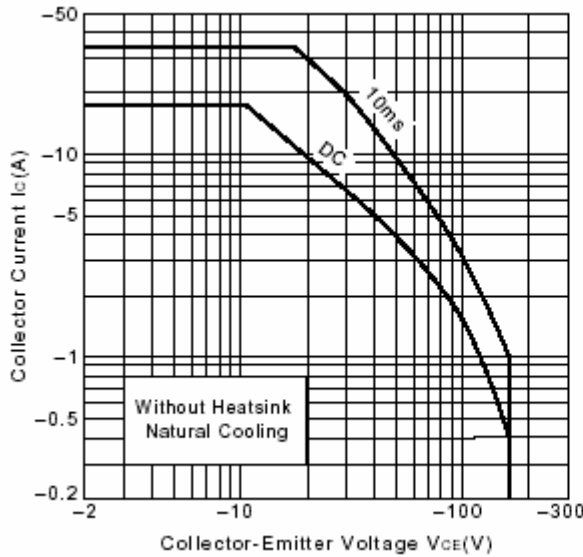

Fig.5 Safe Operating Area

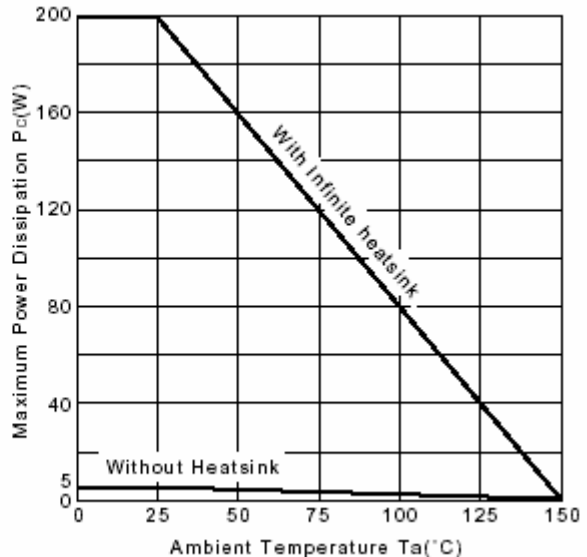

Fig.6 P_c - T_a Derating

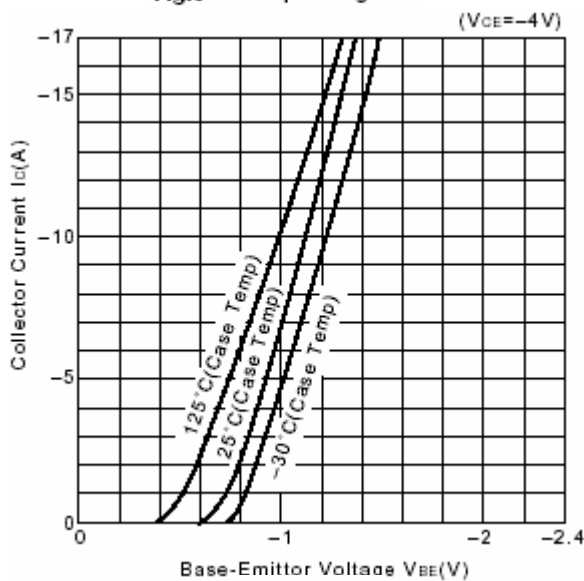

Fig.7 I_C - V_{BE}

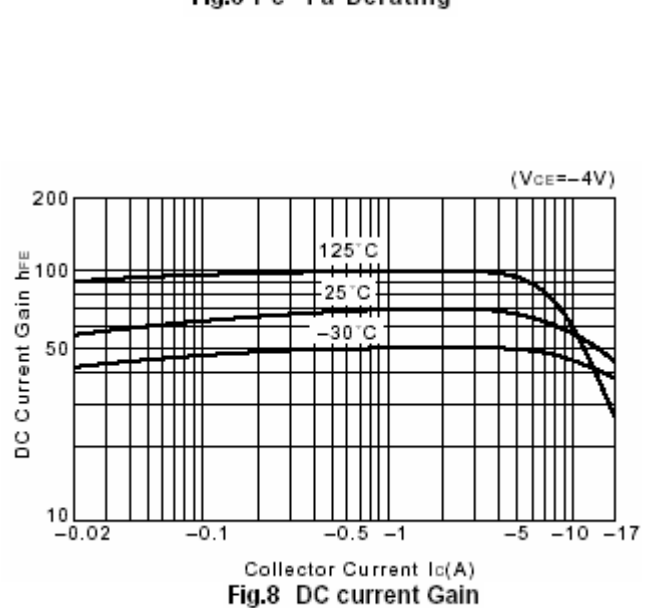

Fig.8 DC current Gain