

|                 |                    |                         |                                      |
|-----------------|--------------------|-------------------------|--------------------------------------|
| REV<br><b>A</b> | AUTH<br><b>JLE</b> | DATE<br><b>10/17/02</b> | INITIAL RELEASE                      |
| REV<br><b>B</b> | AUTH<br><b>RL</b>  | DATE<br><b>10/30/06</b> | ILLUSTRATION, NOTES, FORMAT UPDATED. |

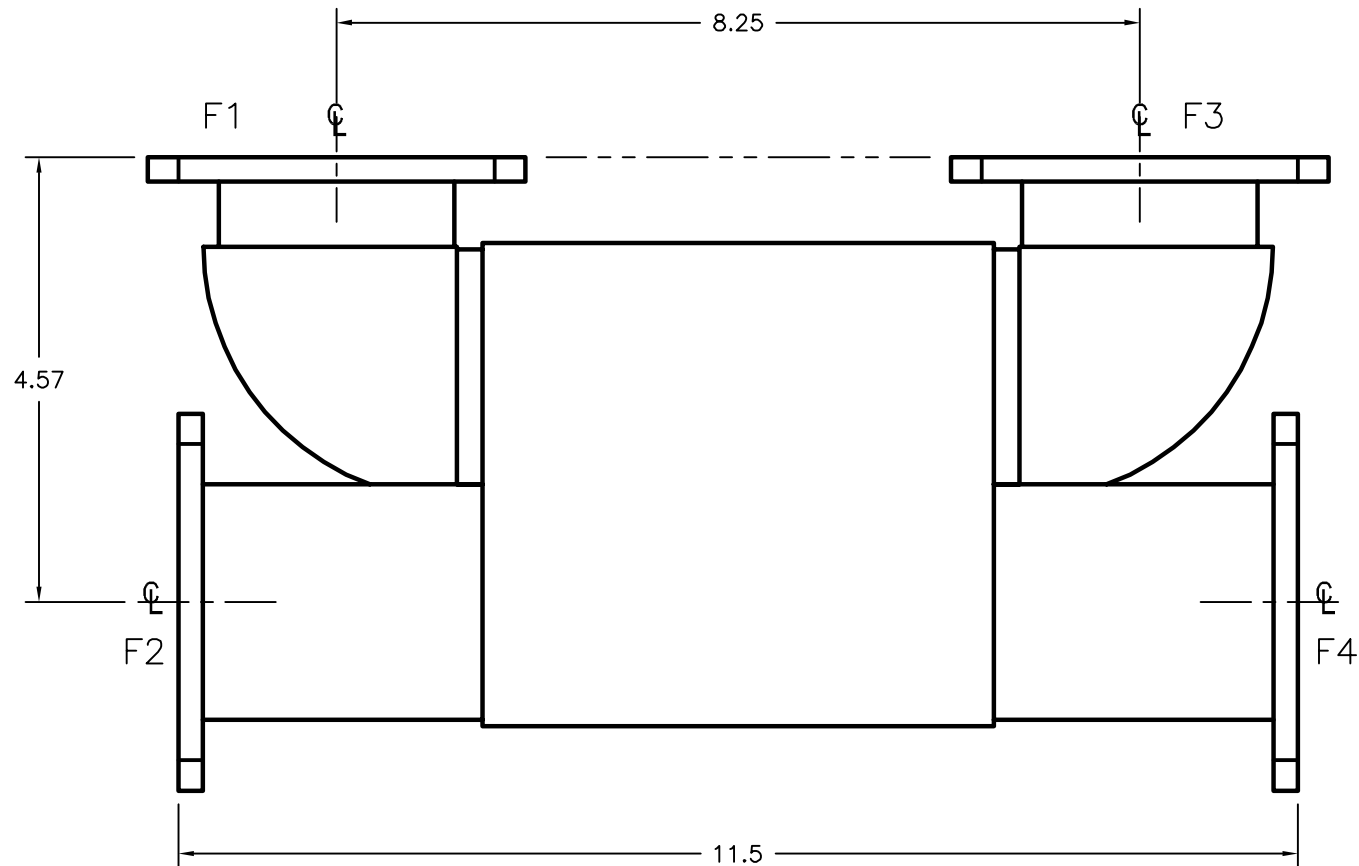

| FLANGE TYPE |
|-------------|
| 1 = CPRG    |
| 2 = CPRF    |
| 3 = CMR     |

FREQUENCY  
3.70-4.20 GHz

MODEL  
229-261X-Z-F1-F2-F3-F4

NOTE: REPLACE "F1, F2, F3, & F4" NOTATION WITH NUMBER CORRESPONDING TO FLANGE TYPE DESIRED, AS SHOWN ON TABLE ABOVE.

|   |                               |                             |                 |  |   |
|---|-------------------------------|-----------------------------|-----------------|--|---|
| THIRD ANGLE PROJECTION:   |                               | APPROVALS                   | DATE            | <b>ADVANCED TECHNICAL MATERIALS, INC.</b><br>TEL: (631) 289-0363 FAX: (631) 289-0358<br>www.atmmicrowave.com | <small>THE INFORMATION IN THIS DRAWING IS PROPRIETARY AND SHALL NOT BE USED OR DISCLOSED WITHOUT THE PRIOR WRITTEN CONSENT OF ATM, INC. DO NOT SCALE DWG.</small> |
| UNLESS OTHERWISE NOTED, DIMENSIONS ARE IN INCHES. TOLERANCES ARE:<br>FRACTIONS: ±1/64 ANGLES: ±1/2° |                               | DRAWN <b>JLE</b>            | <b>10/17/02</b> |  |   |
| BASIC DIMENSION   | DECIMALS<br>2 PLACE   3 PLACE | CHKD.                       | APRVD.          | <b>OUTLINE, WR229</b><br><b>'Z'-STYLE COMBINER-DIVIDER (HYBRID-COUP.)</b>                                    |   |
| UNDER 6"  | <b>±.02</b>   <b>±.005</b>    | MATERIAL <b>PER ORDER</b>   |                 |  |   |
| 6" - 12"  | <b>±.03</b>   <b>±.010</b>    | TREATMENT <b>-</b>          |                 |  |   |
| OVER 12"  | <b>±.06</b>   <b>±.015</b>    | FINISH <b>ATM STD. GRAY</b> |                 | SIZE <b>A</b>  | CAGE CODE <b>0R8N4</b>  |
|   |                               |                             |                 | ATM DWG # <b>5234W</b>   | REVISION <b>B</b>   |
|   |                               |                             |                 | SCALE <b>1 : 2</b>   | SHEET <b>1/1</b>  |