

Technical Data:

Material

- HOUSING: PBT (Glass filled). UL 94 V-0.
- Metal Housing: Brass (Cu Zn) Cu, Tin plated.
- Screw: Steel galvanized and chromated.
- Wire guard: Stainless steel Tin plated.

Electrical:

- Current rating: 10 Amps/way max.
- Contact resistance: 20m Ω (Max).
- Insulation resistance: 5000M Ω /1000V.
- Withstanding Voltage: 1500VAC (1min). test time= 60sec/1pcs.
- Operation Voltage: 300 VAC.
- Wire Stripping length:
- Wire Range: 14-22 AWG.
- Wire type: both sol and Str.

Mechanical:

- Screw Torque: 4 Kg. cm (Max).
- Operating temperature: -55°C to +105°C
- Solderability: 95 % coverage (min). test temperature= 230°C \pm 10°C. test time= 3sec \pm 0.5sec.

Application and

Features:

- This is the most standard version which is an economic and reliable solution for Cable to PC-Board connection.
- Standard sizes are 2 and 3 way-block, but every number of contact can be combined, by simply plugging them together and can be ordered as required.
- Holes for test-pins.
- With wire guard for wire protection (for that the screw doesn't press directly on the wire)

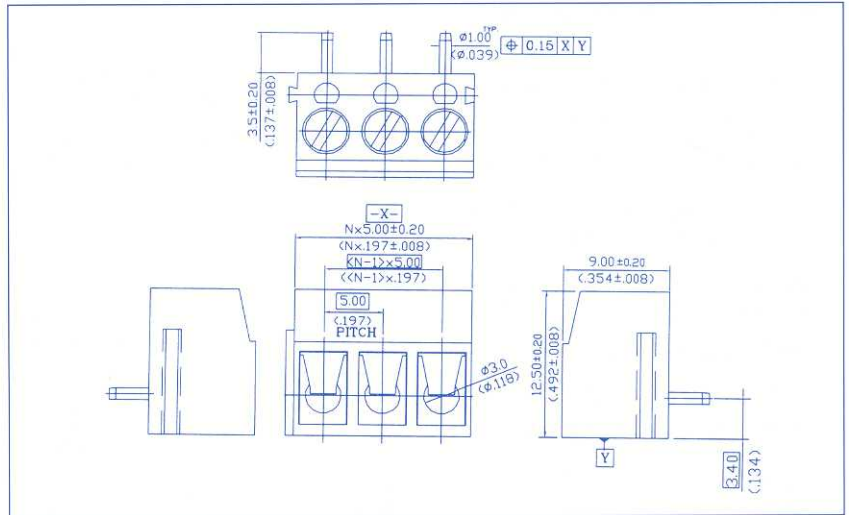

Notes: Please replace 'X' with appropriate coding listed in the tables below

3 1 0 - X X X - X X 0 2 - 0 0 X 0

Number of contact

| | |
|----------|------|
| 02-24 po | 02 |
| | 03 |
| | etc. |

Pitch

| | |
|---------------|---|
| 5.00mm/.197" | 1 |
| 10.00mm/.394" | 2 |
| 15.00mm/.591" | 3 |

Wire Guard

| | |
|---------|---|
| With | 0 |
| Without | 1 |

Color

| | |
|-------|---|
| Black | 0 |
| Blue | 6 |
| Gray | 8 |

Screw Type

| | |
|-------|---|
| " - " | 0 |
| " + " | 1 |