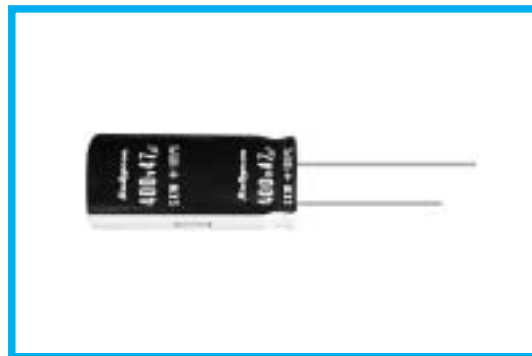

SXW SERIES
**105°C Overvoltage Vent Operation Facility,
Lead Wire Type**
◆FEATURES

- Load Life : 105°C 2000 hours.
- Body diameter of ϕ 10mm to ϕ 18mm with high ripple current capability.
- This series has specification of vent operation in overvoltage situation. Please consult us for any further details.
- RoHS compliance.

◆SPECIFICATIONS

Items	Characteristics							
Category Temperature Range	-25~+105°C							
Rated Voltage Range	200 · 400V.DC							
Capacitance Tolerance	±20% (20°C, 120Hz)							
Leakage Current(MAX)	$I=3\sqrt{CV}$ (After 5 minutes application of rated voltage) I=Leakage Current(μ A) C=Rated Capacitance(μ F) V=Rated Voltage(V)							
Dissipation Factor(MAX) (tan δ)	0.15 (20°C, 120Hz)							
Impedance Ratio(MAX)	<table border="1"> <tr> <td>Rated Voltage (V)</td> <td>200</td> <td>400</td> <td rowspan="2">(120Hz)</td> </tr> <tr> <td>Z(-25°C)/Z(20°C)</td> <td>3</td> <td>8</td> </tr> </table>	Rated Voltage (V)	200	400	(120Hz)	Z(-25°C)/Z(20°C)	3	8
Rated Voltage (V)	200	400	(120Hz)					
Z(-25°C)/Z(20°C)	3	8						
Endurance	After applying rated voltage with rated ripple current for 2000 hrs at 105°C, the capacitors shall meet the following requirements. <table border="1"> <tr> <td>Capacitance Change</td> <td>Within ±20% of the initial value.</td> </tr> <tr> <td>Dissipation Factor</td> <td>Not more than 200% of the specified value.</td> </tr> <tr> <td>Leakage Current</td> <td>Not more than the specified value.</td> </tr> </table>	Capacitance Change	Within ±20% of the initial value.	Dissipation Factor	Not more than 200% of the specified value.	Leakage Current	Not more than the specified value.	
Capacitance Change	Within ±20% of the initial value.							
Dissipation Factor	Not more than 200% of the specified value.							
Leakage Current	Not more than the specified value.							

◆MULTIPLIER FOR RIPPLE CURRENT

Frequency coefficient

Frequency (Hz)		60(50)	120	500	1k	10k \leq
Coefficient	200WV	0.8	1.0	1.10	1.14	1.18
	400WV	0.8	1.0	1.05	1.10	1.15

◆PART NUMBER

□□□	SXW	□□□□□	□	□□□	□□	DXL
Rated Voltage	Series	Rated Capacitance	Capacitance Tolerance	Option	Lead Forming	Case Size

◆ DIMENSIONS

(mm)

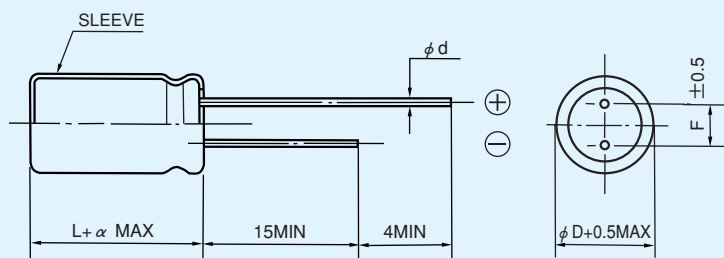

ϕD	10	12.5	16	18
ϕd	0.6		0.8	
F	5.0		7.5	
α	1.5			

◆ STANDARD SIZE, RATED RIPPLE CURRENT

WV Cap (μF)	200			
	$\phi 16$		$\phi 18$	
68	16×20	0.32		
82	16×20	0.36	18×20	0.37
	16×25	0.38		
100	16×25	0.43	18×20	0.43
	16×30	0.45		
120	16×25	0.48	18×20	0.46
	16×30	0.50	18×25	0.48
130			18×20	0.46
150	16×30	0.57	18×20	0.50
			18×25	0.53
	16×35	0.59	18×30	0.58
180	16×40	0.66	18×25	0.60
			18×30	0.62
220			18×30	0.71
			18×35	0.74
			18×35	0.77
270			18×45	0.89
330			18×40	0.91

WV Cap (μF)	400							
	$\phi 10$		$\phi 12.5$		$\phi 16$		$\phi 18$	
4.7	10×10	0.060						
10	10×16	0.087	12.5×20	0.10				
					16×20	0.17		
22					16×25	0.18		
					16×25	0.22		
27					16×25	0.22		
					16×25	0.22		
33					16×25	0.22	18×20	0.23
					16×30	0.24	18×25	0.25
36							18×20	0.24
39					16×30	0.27	18×25	0.27
47					16×30	0.30	18×20	0.28
							18×25	0.30
					16×35	0.32	18×30	0.32
56					16×35	0.34	18×30	0.35
					16×40	0.36	18×35	0.37
68							18×35	0.40
					16×40	0.39	18×40	0.42
82							18×40	0.46
							18×45	0.48
100							18×45	0.52

Size $\phi D \times L$ (mm)
Ripple Current (A r.m.s./120Hz, 105°C)