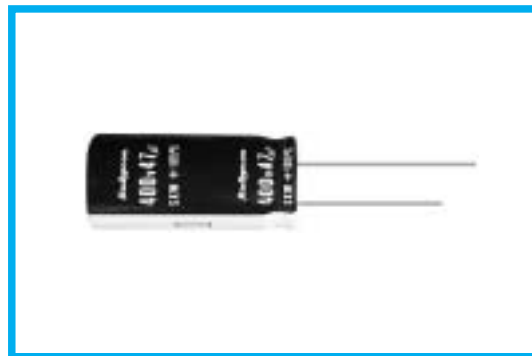

SXW SERIES
**105°C Overvoltage Vent Operation Facility,
Lead Wire Type**
◆FEATURES

- Load Life : 105°C 2000 hours.
- Body diameter of ϕ 10mm to ϕ 18mm with high ripple current capability.
- This series has specification of vent operation in overvoltage situation. Please consult us for any further details.
- RoHS compliance.

◆SPECIFICATIONS

| Items | Characteristics | | | | | | | |
|--|--|--------------------|-----------------------------------|--------------------|--|------------------|------------------------------------|---|
| Category Temperature Range | -25~+105°C | | | | | | | |
| Rated Voltage Range | 200 · 400V.DC | | | | | | | |
| Capacitance Tolerance | ±20% (20°C, 120Hz) | | | | | | | |
| Leakage Current(MAX) | $I=3\sqrt{CV}$ (After 5 minutes application of rated voltage) I=Leakage Current(μ A) C=Rated Capacitance(μ F) V=Rated Voltage(V) | | | | | | | |
| Dissipation Factor(MAX) (tan δ) | 0.15 (20°C, 120Hz) | | | | | | | |
| Impedance Ratio(MAX) | <table border="1"> <tr> <td>Rated Voltage (V)</td> <td>200</td> <td>400</td> <td rowspan="2">(120Hz)</td> </tr> <tr> <td>Z(-25°C)/Z(20°C)</td> <td>3</td> <td>8</td> </tr> </table> | Rated Voltage (V) | 200 | 400 | (120Hz) | Z(-25°C)/Z(20°C) | 3 | 8 |
| Rated Voltage (V) | 200 | 400 | (120Hz) | | | | | |
| Z(-25°C)/Z(20°C) | 3 | 8 | | | | | | |
| Endurance | After applying rated voltage with rated ripple current for 2000 hrs at 105°C, the capacitors shall meet the following requirements. <table border="1"> <tr> <td>Capacitance Change</td> <td>Within ±20% of the initial value.</td> </tr> <tr> <td>Dissipation Factor</td> <td>Not more than 200% of the specified value.</td> </tr> <tr> <td>Leakage Current</td> <td>Not more than the specified value.</td> </tr> </table> | Capacitance Change | Within ±20% of the initial value. | Dissipation Factor | Not more than 200% of the specified value. | Leakage Current | Not more than the specified value. | |
| Capacitance Change | Within ±20% of the initial value. | | | | | | | |
| Dissipation Factor | Not more than 200% of the specified value. | | | | | | | |
| Leakage Current | Not more than the specified value. | | | | | | | |

◆MULTIPLIER FOR RIPPLE CURRENT

Frequency coefficient

| Frequency (Hz) | | 60(50) | 120 | 500 | 1k | 10k \leq |
|----------------|-------|--------|-----|------|------|------------|
| Coefficient | 200WV | 0.8 | 1.0 | 1.10 | 1.14 | 1.18 |
| | 400WV | 0.8 | 1.0 | 1.05 | 1.10 | 1.15 |

◆PART NUMBER

| | | | | | | |
|---------------|--------|-------------------|-----------------------|--------|--------------|-----------|
| □□□ | SXW | □□□□□ | □ | □□□ | □□ | DXL |
| Rated Voltage | Series | Rated Capacitance | Capacitance Tolerance | Option | Lead Forming | Case Size |

◆ DIMENSIONS

(mm)

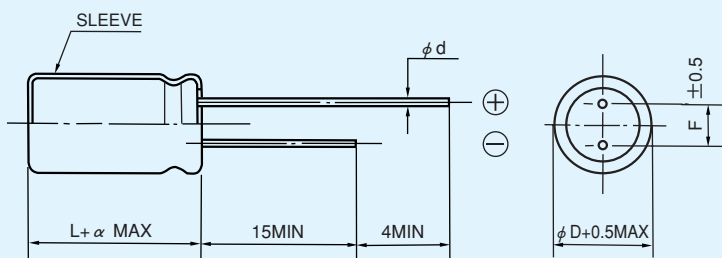

| | | | | |
|----------|-----|------|-----|----|
| ϕD | 10 | 12.5 | 16 | 18 |
| ϕd | 0.6 | | 0.8 | |
| F | 5.0 | | 7.5 | |
| α | 1.5 | | | |

◆ STANDARD SIZE, RATED RIPPLE CURRENT

| WV Cap (μF) | 200 | | | |
|--------------------------|-----------|------|-----------|------|
| | $\phi 16$ | | $\phi 18$ | |
| 68 | 16×20 | 0.32 | | |
| 82 | 16×20 | 0.36 | 18×20 | 0.37 |
| | 16×25 | 0.38 | | |
| 100 | 16×25 | 0.43 | 18×20 | 0.43 |
| | 16×30 | 0.45 | | |
| 120 | 16×25 | 0.48 | 18×20 | 0.46 |
| | 16×30 | 0.50 | 18×25 | 0.48 |
| 130 | | | 18×20 | 0.46 |
| 150 | 16×30 | 0.57 | 18×20 | 0.50 |
| | | | 18×25 | 0.53 |
| | 16×35 | 0.59 | 18×30 | 0.58 |
| 180 | 16×40 | 0.66 | 18×25 | 0.60 |
| | | | 18×30 | 0.62 |
| 220 | | | 18×30 | 0.71 |
| | | | 18×35 | 0.74 |
| | | | 18×35 | 0.77 |
| 270 | | | 18×45 | 0.89 |
| | | | | |
| 330 | | | 18×40 | 0.91 |

| WV Cap (μF) | 400 | | | | | | | |
|--------------------------|-----------|-------|-------------|------|-----------|------|-----------|------|
| | $\phi 10$ | | $\phi 12.5$ | | $\phi 16$ | | $\phi 18$ | |
| 4.7 | 10×10 | 0.060 | | | | | | |
| 10 | 10×16 | 0.087 | 12.5×20 | 0.10 | | | | |
| | | | | | 16×20 | 0.17 | | |
| 22 | | | | | 16×25 | 0.18 | | |
| | | | | | 16×25 | 0.22 | | |
| 27 | | | | | 16×25 | 0.22 | | |
| | | | | | 16×25 | 0.22 | 18×20 | 0.23 |
| 33 | | | | | 16×30 | 0.24 | 18×25 | 0.25 |
| | | | | | | | 18×20 | 0.24 |
| 36 | | | | | | | 18×20 | 0.24 |
| 39 | | | | | 16×30 | 0.27 | 18×25 | 0.27 |
| | | | | | | | | |
| 47 | | | | | 16×30 | 0.30 | 18×20 | 0.28 |
| | | | | | 16×35 | 0.32 | 18×25 | 0.30 |
| | | | | | 16×35 | 0.32 | 18×30 | 0.32 |
| 56 | | | | | 16×35 | 0.34 | 18×30 | 0.35 |
| | | | | | 16×40 | 0.36 | 18×35 | 0.37 |
| 68 | | | | | 16×40 | 0.39 | 18×35 | 0.40 |
| | | | | | | | 18×40 | 0.42 |
| 82 | | | | | | | 18×40 | 0.46 |
| | | | | | | | 18×45 | 0.48 |
| 100 | | | | | | | 18×45 | 0.52 |

Size $\phi D \times L$ (mm)
Ripple Current (A r.m.s./120Hz, 105°C)