

5.00mm (0.196") PITCH CONNECTOR

Wire-to-Board
Housing

YPH500 Series

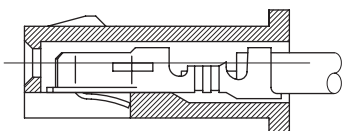
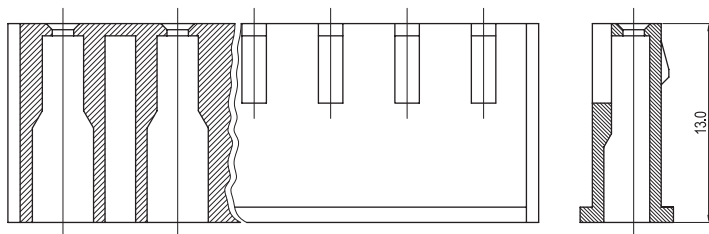
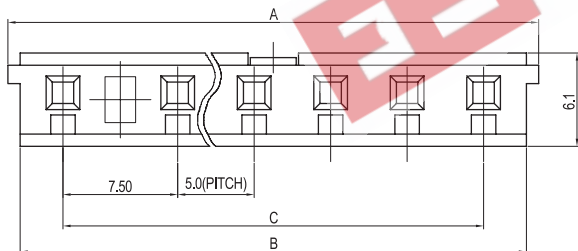
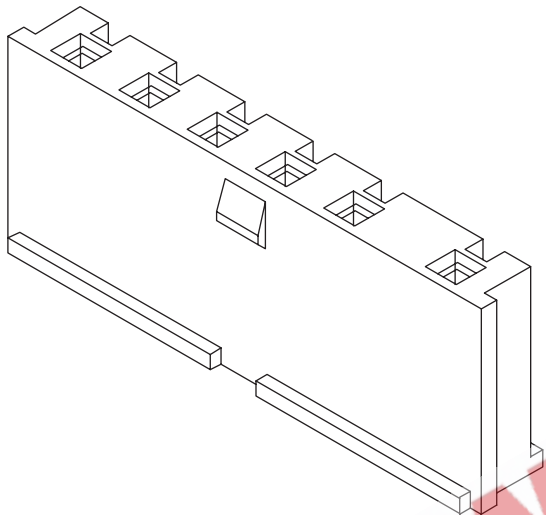

TERMINAL ASSEMBLY DRAWING

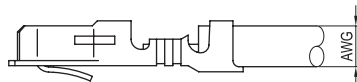

YLT500
AWG : #22 ~ #26

Material

I/NO	DESCRIPTION	TITLE	MATERIAL
1	HOUSING	YPH500	PA66, UL94 V Grade

Available Pin

PARTS NO.	DIM. A	DIM. B	DIM. C
YPH500-02	13.9	13.1	7.5
YPH500-03	18.9	18.1	12.5
YPH500-04	23.9	23.1	17.5
YPH500-05	28.9	28.1	22.5
YPH500-06	33.9	33.1	27.5

Specification

ITEM	SPEC
Voltage Rating	AC/DC 250V
Current Rating	AC/DC 5A
Operating Temperature	-25℃~+85℃
Contact Resistance	30mΩ MAX
Withstanding Voltage	AC1000V/1min
Insulation Resistance	1000MΩ MIN
Applicable Wire	AWG #22~#26
Applicable P.C.B	-
Applicable FPC/FFC	-
Solder Height	-
Crimp Tensile Strength	-
UL FILE NO	E108706

Application Terminal : YLT500 (212 page)