

7mm TYPE 7KLL

Frequency Range: 2-120MHz

Inductance Range: 0.03-50μH

Temperature Coefficient: Inductor TC (L) 220+220ppm/°C
With Internal Capacitor TC (F) 0±250ppm/°C

Internal Capacitance Values: 5-100pF

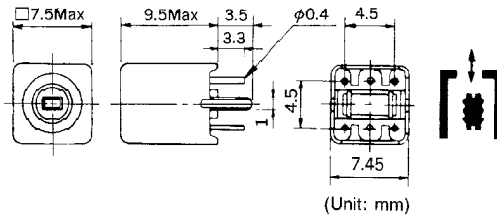

Features

- Type 7KL is a low profile version of 7KM.
- Spiral wound with high number of closely spaced slots on form yields low distributed capacitance, low temperature coefficient, and added stability in humid conditions.

STANDARD COILS SELECTION GUIDE

TYPE 7KLL Frequency Range: 2 ~ 30MHz

TOKO Part Number	Inductance (μH)	Q min.	Test Frequency (MHz)
600BNS-8001 Z	0.10 ± 6%	40 min	50
600BNS-8002 Z	0.12 ± 6%	40 min	50
600BNS-8003 Z	0.15 ± 6%	45 min	50
600BNS-8004 Z	0.18 ± 6%	45 min	50
600BNS-8005 Z	0.22 ± 6%	50 min	50
600BNS-8006 Z	0.27 ± 6%	50 min	50
600BNS-8007 Z	0.33 ± 6%	55 min	50
600BNS-8008 Z	0.39 ± 6%	55 min	50
600BNS-8009 Z	0.47 ± 6%	55 min	50
600BNS-8010 Z	0.56 ± 6%	55 min	50
600BNS-8011 Z	0.68 ± 6%	55 min	50
600BNS-8012 Z	0.82 ± 6%	55 min	50
600BNS-8013 Z	1.0 ± 6%	49 ± 20%	7.96
600BNS-8014 Z	1.2 ± 6%	50 ± 20%	7.96
600BNS-8015 Z	1.5 ± 6%	47 ± 20%	7.96
600BNS-8016 Z	1.8 ± 6%	49 ± 20%	7.96
600BNS-8017 Z	2.2 ± 6%	46 ± 20%	7.96
600BNS-8018 Z	2.7 ± 6%	48 ± 20%	7.96
600BNS-8019 Z	3.3 ± 6%	48 ± 20%	7.96
600BNS-8020 Z	3.9 ± 6%	47 ± 20%	7.96
600BNS-8021 Z	4.7 ± 6%	47 ± 20%	7.96
600BNS-8022 Z	5.6 ± 6%	46 ± 20%	7.96
600BNS-8023 Z	6.8 ± 6%	45 ± 20%	7.96
600BNS-8024 Z	8.2 ± 6%	45 ± 20%	7.96
600BNS-8025 Z	10.0 ± 6%	40 ± 20%	2.52
600BNS-8026 Z	12.0 ± 6%	42 ± 20%	2.52
600BNS-8027 Z	15.0 ± 6%	43 ± 20%	2.52
600BNS-8028 Z	18.0 ± 6%	45 ± 20%	2.52
600BNS-8029 Z	22.0 ± 6%	46 ± 20%	2.52
F600BNS-8030 Z	27.0 ± 6%	33 ± 20%	2.52
F600BNS-8031 Z	33.0 ± 6%	32 ± 20%	2.52
F600BNS-8032 Z	39.0 ± 6%	37 ± 20%	2.52
F600BNS-8033 Z	47.0 ± 6%	36 ± 20%	2.52

STANDARD COILS SELECTION GUIDE

TYPE 7KLL Frequency Range: 30 ~ 80MHz

TOKO Part Number	Inductance (μ H)	Q min.	Test Frequency (MHz)
600GNS-8034 Z	0.10 \pm 6%	60 \pm 20%	50
600GNS-8035 Z	0.12 \pm 6%	65 \pm 20%	50
600GNS-8036 Z	0.15 \pm 6%	62 \pm 20%	50
600GNS-8037 Z	0.18 \pm 6%	68 \pm 20%	50
600GNS-8038 Z	0.22 \pm 6%	71 \pm 20%	50
600GNS-8039 Z	0.27 \pm 6%	77 \pm 20%	50
600GNS-8040 Z	0.33 \pm 6%	85 \pm 20%	50
600GNS-8041 Z	0.39 \pm 6%	84 \pm 20%	50
600GNS-8042 Z	0.47 \pm 6%	92 \pm 20%	50
600GNS-8043 Z	0.56 \pm 6%	88 \pm 20%	50
600GNS-8044 Z	0.68 \pm 6%	88 \pm 20%	50
600GNS-8045 Z	0.82 \pm 6%	87 \pm 20%	50
600GNS-8046 Z	1.0 \pm 6%	43 \pm 20%	7.96
600GNS-8047 Z	1.2 \pm 6%	42 \pm 20%	7.96
600GNS-8048 Z	1.5 \pm 6%	46 \pm 20%	7.96
600GNS-8049 Z	1.8 \pm 6%	45 \pm 20%	7.96
600GNS-8050 Z	2.2 \pm 6%	47 \pm 20%	7.96
600GNS-8051 Z	2.7 \pm 6%	45 \pm 20%	7.96
600GNS-8052 Z	3.3 \pm 6%	47 \pm 20%	7.96
600GNS-8053 Z	3.9 \pm 6%	47 \pm 20%	7.96
600GNS-8054 Z	4.7 \pm 6%	50 \pm 20%	7.96
600GNS-8055 Z	5.6 \pm 6%	48 \pm 20%	7.96
600GNS-8056 Z	6.8 \pm 6%	47 \pm 20%	7.96
600GNS-8057 Z	8.2 \pm 6%	47 \pm 20%	7.96
600GNS-8058 Z	10.0 \pm 6%	41 \pm 20%	2.52
600GNS-8059 Z	12.0 \pm 6%	42 \pm 20%	2.52
600GNS-8060 Z	15.0 \pm 6%	44 \pm 20%	2.52
600GNS-8061 Z	18.0 \pm 6%	45 \pm 20%	2.52
600GNS-8062 Z	22.0 \pm 6%	45 \pm 20%	2.52
F600GNS-8063 Z	27.0 \pm 6%	41 \pm 20%	2.52
F600GNS-8064 Z	33.0 \pm 6%	38 \pm 20%	2.52
F600GNS-8065 Z	39.0 \pm 6%	41 \pm 20%	2.52
F600GNS-8066 Z	47.0 \pm 6%	41 \pm 20%	2.52

STANDARD COILS SELECTION GUIDE

TYPE 7KLL Frequency Range: 80 ~ 120MHz

TOKO Part Number	Inductance (μH)	Q min.	Test Frequency (MHz)
600ENS-8067 Z	0.10 \pm 6%	56 \pm 20%	50
600ENS-8068 Z	0.12 \pm 6%	64 \pm 20%	50
600ENS-8069 Z	0.15 \pm 6%	67 \pm 20%	50
600ENS-8070 Z	0.18 \pm 6%	73 \pm 20%	50
600ENS-8071 Z	0.22 \pm 6%	73 \pm 20%	50
600ENS-8072 Z	0.27 \pm 6%	81 \pm 20%	50
600ENS-8073 Z	0.33 \pm 6%	87 \pm 20%	50
600ENS-8074 Z	0.39 \pm 6%	88 \pm 20%	50
600ENS-8075 Z	0.47 \pm 6%	90 \pm 20%	50
600ENS-8076 Z	0.56 \pm 6%	93 \pm 20%	50
600ENS-8077 Z	0.68 \pm 6%	92 \pm 20%	50
600ENS-8078 Z	0.82 \pm 6%	94 \pm 20%	50
600ENS-8079 Z	1.0 \pm 6%	39 \pm 20%	7.96
600ENS-8080 Z	1.2 \pm 6%	45 \pm 20%	7.96
600ENS-8081 Z	1.5 \pm 6%	45 \pm 20%	7.96
600ENS-8082 Z	1.8 \pm 6%	45 \pm 20%	7.96
600ENS-8083 Z	2.2 \pm 6%	45 \pm 20%	7.96
600ENS-8084 Z	2.7 \pm 6%	45 \pm 20%	7.96
600ENS-8085 Z	3.3 \pm 6%	44 \pm 20%	7.96
600ENS-8086 Z	3.9 \pm 6%	44 \pm 20%	7.96
600ENS-8087 Z	4.7 \pm 6%	45 \pm 20%	7.96
600ENS-8088 Z	5.6 \pm 6%	45 \pm 20%	7.96
600ENS-8089 Z	6.8 \pm 6%	44 \pm 20%	7.96
600ENS-8090 Z	8.2 \pm 6%	47 \pm 20%	7.96
600ENS-8091 Z	10.0 \pm 6%	38 \pm 20%	2.52
600ENS-8092 Z	12.0 \pm 6%	40 \pm 20%	2.52
600ENS-8093 Z	15.0 \pm 6%	44 \pm 20%	2.52
600ENS-8094 Z	18.0 \pm 6%	35 \pm 20%	2.52
600ENS-8095 Z	22.0 \pm 6%	34 \pm 20%	2.52
F600ENS-8096 Z	27.0 \pm 6%	33 \pm 20%	2.52
F600ENS-8097 Z	33.0 \pm 6%	37 \pm 20%	2.52
F600ENS-8098 Z	39.0 \pm 6%	37 \pm 20%	2.52
F600ENS-8099 Z	47.0 \pm 6%	36 \pm 20%	2.52