

**7mm TYPE 7KLL**

Frequency Range: 2-120MHz

 Inductance Range: 0.03-50 $\mu$ H

 Temperature Coefficient: Inductor TC (L) 220+220ppm/ $^{\circ}$ C

 With Internal Capacitor TC (F) 0 $\pm$ 250ppm/ $^{\circ}$ C

Internal Capacitance Values: 5-100pF

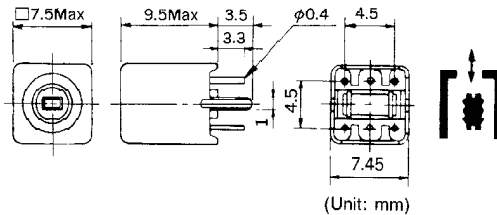
**Features**

- Type 7KL is a low profile version of 7KM.
- Spiral wound with high number of closely spaced slots on form yields low distributed capacitance, low temperature coefficient, and added stability in humid conditions.

**STANDARD COILS SELECTION GUIDE**
**TYPE 7KLL Frequency Range: 2 ~ 30MHz**

TOKO Part Number	Inductance ( $\mu$ H)	Q min.	Test Frequency (MHz)
600BNS-8001 Z	0.10 $\pm$ 6%	40 min	50
600BNS-8002 Z	0.12 $\pm$ 6%	40 min	50
600BNS-8003 Z	0.15 $\pm$ 6%	45 min	50
600BNS-8004 Z	0.18 $\pm$ 6%	45 min	50
600BNS-8005 Z	0.22 $\pm$ 6%	50 min	50
600BNS-8006 Z	0.27 $\pm$ 6%	50 min	50
600BNS-8007 Z	0.33 $\pm$ 6%	55 min	50
600BNS-8008 Z	0.39 $\pm$ 6%	55 min	50
600BNS-8009 Z	0.47 $\pm$ 6%	55 min	50
600BNS-8010 Z	0.56 $\pm$ 6%	55 min	50
600BNS-8011 Z	0.68 $\pm$ 6%	55 min	50
600BNS-8012 Z	0.82 $\pm$ 6%	55 min	50
600BNS-8013 Z	1.0 $\pm$ 6%	49 $\pm$ 20%	7.96
600BNS-8014 Z	1.2 $\pm$ 6%	50 $\pm$ 20%	7.96
600BNS-8015 Z	1.5 $\pm$ 6%	47 $\pm$ 20%	7.96
600BNS-8016 Z	1.8 $\pm$ 6%	49 $\pm$ 20%	7.96
600BNS-8017 Z	2.2 $\pm$ 6%	46 $\pm$ 20%	7.96
600BNS-8018 Z	2.7 $\pm$ 6%	48 $\pm$ 20%	7.96
600BNS-8019 Z	3.3 $\pm$ 6%	48 $\pm$ 20%	7.96
600BNS-8020 Z	3.9 $\pm$ 6%	47 $\pm$ 20%	7.96
600BNS-8021 Z	4.7 $\pm$ 6%	47 $\pm$ 20%	7.96
600BNS-8022 Z	5.6 $\pm$ 6%	46 $\pm$ 20%	7.96
600BNS-8023 Z	6.8 $\pm$ 6%	45 $\pm$ 20%	7.96
600BNS-8024 Z	8.2 $\pm$ 6%	45 $\pm$ 20%	7.96
600BNS-8025 Z	10.0 $\pm$ 6%	40 $\pm$ 20%	2.52
600BNS-8026 Z	12.0 $\pm$ 6%	42 $\pm$ 20%	2.52
600BNS-8027 Z	15.0 $\pm$ 6%	43 $\pm$ 20%	2.52
600BNS-8028 Z	18.0 $\pm$ 6%	45 $\pm$ 20%	2.52
600BNS-8029 Z	22.0 $\pm$ 6%	46 $\pm$ 20%	2.52
F600BNS-8030 Z	27.0 $\pm$ 6%	33 $\pm$ 20%	2.52
F600BNS-8031 Z	33.0 $\pm$ 6%	32 $\pm$ 20%	2.52
F600BNS-8032 Z	39.0 $\pm$ 6%	37 $\pm$ 20%	2.52
F600BNS-8033 Z	47.0 $\pm$ 6%	36 $\pm$ 20%	2.52

## STANDARD COILS SELECTION GUIDE

## TYPE 7KLL Frequency Range: 30 ~ 80MHz

TOKO Part Number	Inductance ( $\mu$ H)	Q min.	Test Frequency (MHz)
600GNS-8034 Z	0.10 $\pm$ 6%	60 $\pm$ 20%	50
600GNS-8035 Z	0.12 $\pm$ 6%	65 $\pm$ 20%	50
600GNS-8036 Z	0.15 $\pm$ 6%	62 $\pm$ 20%	50
600GNS-8037 Z	0.18 $\pm$ 6%	68 $\pm$ 20%	50
600GNS-8038 Z	0.22 $\pm$ 6%	71 $\pm$ 20%	50
600GNS-8039 Z	0.27 $\pm$ 6%	77 $\pm$ 20%	50
600GNS-8040 Z	0.33 $\pm$ 6%	85 $\pm$ 20%	50
600GNS-8041 Z	0.39 $\pm$ 6%	84 $\pm$ 20%	50
600GNS-8042 Z	0.47 $\pm$ 6%	92 $\pm$ 20%	50
600GNS-8043 Z	0.56 $\pm$ 6%	88 $\pm$ 20%	50
600GNS-8044 Z	0.68 $\pm$ 6%	88 $\pm$ 20%	50
600GNS-8045 Z	0.82 $\pm$ 6%	87 $\pm$ 20%	50
600GNS-8046 Z	1.0 $\pm$ 6%	43 $\pm$ 20%	7.96
600GNS-8047 Z	1.2 $\pm$ 6%	42 $\pm$ 20%	7.96
600GNS-8048 Z	1.5 $\pm$ 6%	46 $\pm$ 20%	7.96
600GNS-8049 Z	1.8 $\pm$ 6%	45 $\pm$ 20%	7.96
600GNS-8050 Z	2.2 $\pm$ 6%	47 $\pm$ 20%	7.96
600GNS-8051 Z	2.7 $\pm$ 6%	45 $\pm$ 20%	7.96
600GNS-8052 Z	3.3 $\pm$ 6%	47 $\pm$ 20%	7.96
600GNS-8053 Z	3.9 $\pm$ 6%	47 $\pm$ 20%	7.96
600GNS-8054 Z	4.7 $\pm$ 6%	50 $\pm$ 20%	7.96
600GNS-8055 Z	5.6 $\pm$ 6%	48 $\pm$ 20%	7.96
600GNS-8056 Z	6.8 $\pm$ 6%	47 $\pm$ 20%	7.96
600GNS-8057 Z	8.2 $\pm$ 6%	47 $\pm$ 20%	7.96
600GNS-8058 Z	10.0 $\pm$ 6%	41 $\pm$ 20%	2.52
600GNS-8059 Z	12.0 $\pm$ 6%	42 $\pm$ 20%	2.52
600GNS-8060 Z	15.0 $\pm$ 6%	44 $\pm$ 20%	2.52
600GNS-8061 Z	18.0 $\pm$ 6%	45 $\pm$ 20%	2.52
600GNS-8062 Z	22.0 $\pm$ 6%	45 $\pm$ 20%	2.52
F600GNS-8063 Z	27.0 $\pm$ 6%	41 $\pm$ 20%	2.52
F600GNS-8064 Z	33.0 $\pm$ 6%	38 $\pm$ 20%	2.52
F600GNS-8065 Z	39.0 $\pm$ 6%	41 $\pm$ 20%	2.52
F600GNS-8066 Z	47.0 $\pm$ 6%	41 $\pm$ 20%	2.52

## STANDARD COILS SELECTION GUIDE

## TYPE 7KLL Frequency Range: 80 ~ 120MHz

TOKO Part Number	Inductance ( $\mu\text{H}$ )	Q min.	Test Frequency (MHz)
600ENS-8067 Z	0.10 $\pm$ 6%	56 $\pm$ 20%	50
600ENS-8068 Z	0.12 $\pm$ 6%	64 $\pm$ 20%	50
600ENS-8069 Z	0.15 $\pm$ 6%	67 $\pm$ 20%	50
600ENS-8070 Z	0.18 $\pm$ 6%	73 $\pm$ 20%	50
600ENS-8071 Z	0.22 $\pm$ 6%	73 $\pm$ 20%	50
600ENS-8072 Z	0.27 $\pm$ 6%	81 $\pm$ 20%	50
600ENS-8073 Z	0.33 $\pm$ 6%	87 $\pm$ 20%	50
600ENS-8074 Z	0.39 $\pm$ 6%	88 $\pm$ 20%	50
600ENS-8075 Z	0.47 $\pm$ 6%	90 $\pm$ 20%	50
600ENS-8076 Z	0.56 $\pm$ 6%	93 $\pm$ 20%	50
600ENS-8077 Z	0.68 $\pm$ 6%	92 $\pm$ 20%	50
600ENS-8078 Z	0.82 $\pm$ 6%	94 $\pm$ 20%	50
600ENS-8079 Z	1.0 $\pm$ 6%	39 $\pm$ 20%	7.96
600ENS-8080 Z	1.2 $\pm$ 6%	45 $\pm$ 20%	7.96
600ENS-8081 Z	1.5 $\pm$ 6%	45 $\pm$ 20%	7.96
600ENS-8082 Z	1.8 $\pm$ 6%	45 $\pm$ 20%	7.96
600ENS-8083 Z	2.2 $\pm$ 6%	45 $\pm$ 20%	7.96
600ENS-8084 Z	2.7 $\pm$ 6%	45 $\pm$ 20%	7.96
600ENS-8085 Z	3.3 $\pm$ 6%	44 $\pm$ 20%	7.96
600ENS-8086 Z	3.9 $\pm$ 6%	44 $\pm$ 20%	7.96
600ENS-8087 Z	4.7 $\pm$ 6%	45 $\pm$ 20%	7.96
600ENS-8088 Z	5.6 $\pm$ 6%	45 $\pm$ 20%	7.96
600ENS-8089 Z	6.8 $\pm$ 6%	44 $\pm$ 20%	7.96
600ENS-8090 Z	8.2 $\pm$ 6%	47 $\pm$ 20%	7.96
600ENS-8091 Z	10.0 $\pm$ 6%	38 $\pm$ 20%	2.52
600ENS-8092 Z	12.0 $\pm$ 6%	40 $\pm$ 20%	2.52
600ENS-8093 Z	15.0 $\pm$ 6%	44 $\pm$ 20%	2.52
600ENS-8094 Z	18.0 $\pm$ 6%	35 $\pm$ 20%	2.52
600ENS-8095 Z	22.0 $\pm$ 6%	34 $\pm$ 20%	2.52
F600ENS-8096 Z	27.0 $\pm$ 6%	33 $\pm$ 20%	2.52
F600ENS-8097 Z	33.0 $\pm$ 6%	37 $\pm$ 20%	2.52
F600ENS-8098 Z	39.0 $\pm$ 6%	37 $\pm$ 20%	2.52
F600ENS-8099 Z	47.0 $\pm$ 6%	36 $\pm$ 20%	2.52