

**RBV601G – RBV608G  
D5SB10 – D5SB80**

6.0A 桥式整流器

6.0A BRIDGE RECTIFIERS

最大额定值、电性 MAXIMUM RATINGS AND ELECTRICAL CHARACTERISTICS  
Ratings at 25°C ambient temperature unless otherwise specified. Single phase, half wave, 60Hz, resistive or inductive load. For capacitive load, derate current by 20%.

| 型号<br>TYPE |        | 最大反向<br>峰值电压<br>Maximum<br>Peak<br>Reverse<br>Voltage | 最大平均<br>正向电流<br>Maximum<br>Average<br>Forward<br>Output<br>Current<br>@T <sub>A</sub> =70°C | 最大正向<br>浪涌电流<br>Maximum<br>Forward Peak<br>Surge Current<br>@ 8.3ms<br>Superimposed | 最大正向<br>峰值电压<br>Maximum DC<br>Forward Voltage<br>drop per element<br>at I <sub>F</sub> =3.0ADC | 最大反向<br>电 流<br>Maximum DC<br>Reverse Current<br>at rated DC<br>Blocking Voltage<br>per element | 结 温<br>Operating<br>Junction<br>Temperature | 外型尺寸<br>Package<br>Dimensions |
|------------|--------|---|---|---|--|--|---|-------------------------------|
|            |        | PRV   | I <sub>O</sub>  | I <sub>FM</sub> (Surge)   | V <sub>F</sub>   | I <sub>R</sub>   | T <sub>J</sub>                              | D5 – SB                       |
|            |        | V <sub>PK</sub>                                       | A <sub>AV</sub>   | A <sub>PK</sub>   | V <sub>PK</sub>  | 25°CCTA<br>μADC  | 125°CCTA<br>μADC                            |                               |
| RBV601G    | D5SB10 | 100   | 6.0   | 150   | 1.1  | 10   | 500   | 150                           |
| RBV602G    | D5SB20 | 200   |   |   |  |  |   |                               |
| RBV604G    | D5SB40 | 400   |   |   |  |  |   |                               |
| RBV606G    | D5SB60 | 600   |   |   |  |  |   |                               |
| RBV608G    | D5SB80 | 800   |   |   |  |  |   |                               |

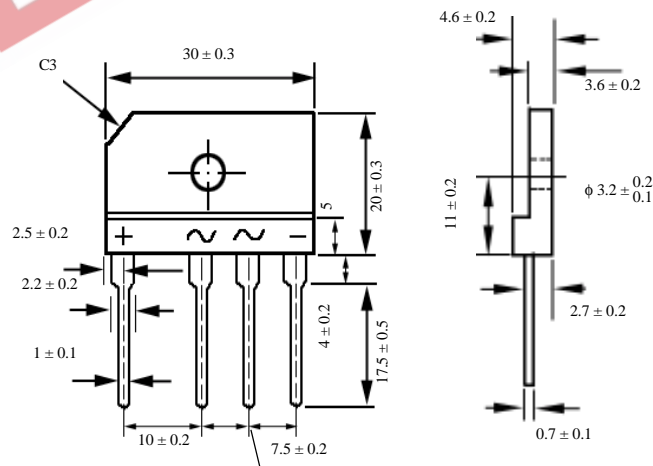

D5 – SB

RBV601G-RBV608G D5SB10-D5SB80

桥式整流器额定值与特性曲线

BRIDGE RECTIFIERS RATING AND CHARACTERISTIC CURVES

FIG. 1 - TYPICAL FORWARD CURRENT DERATING CURVE

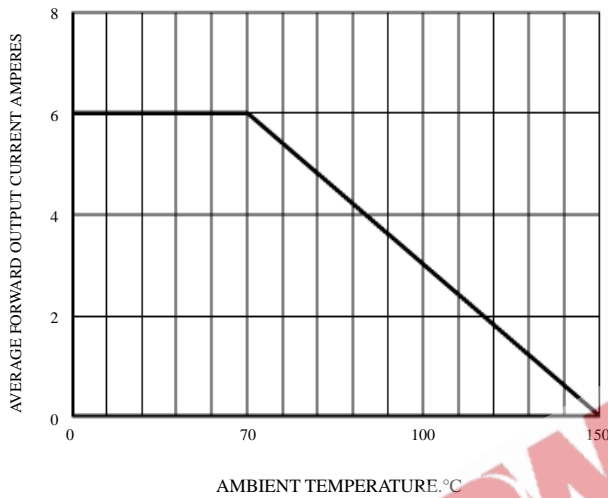

FIG. 2 - MAXIMUM NON-REPETITIVE SURGE CURRENT

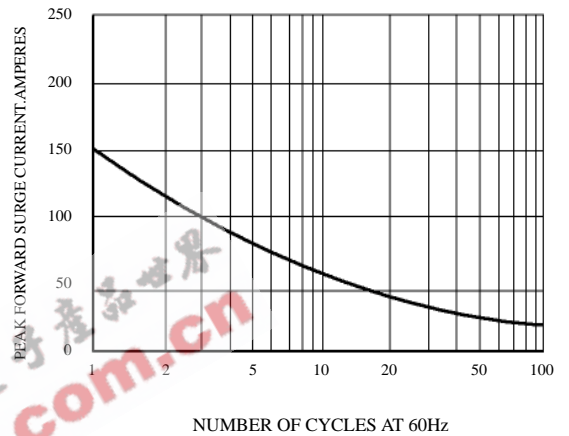

FIG. 3 - TYPICAL REVERSE CHARACTERISTICS

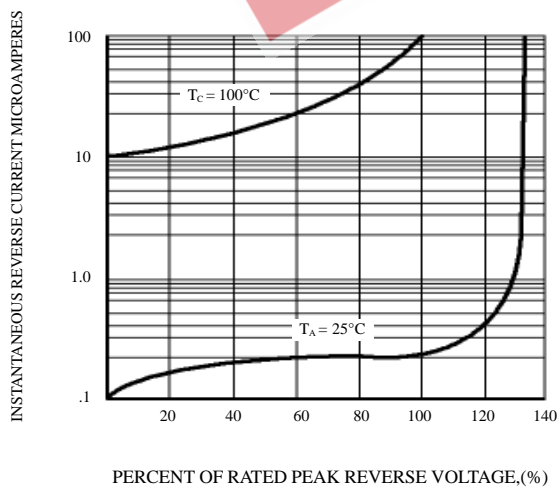

FIG. 4 - TYPICAL INSTANTANEOUS FORWARD PER BRIDGE ELEMENT

