

REV <b>A</b>	AUTH <b>JLE</b>	DATE <b>10/15/02</b>	INITIAL RELEASE
REV <b>B</b>	AUTH <b>RL</b>	DATE <b>10/26/06</b>	FREQ. NOTES CORRECTED; ILLUSTRATION, FORMAT UPDATED.

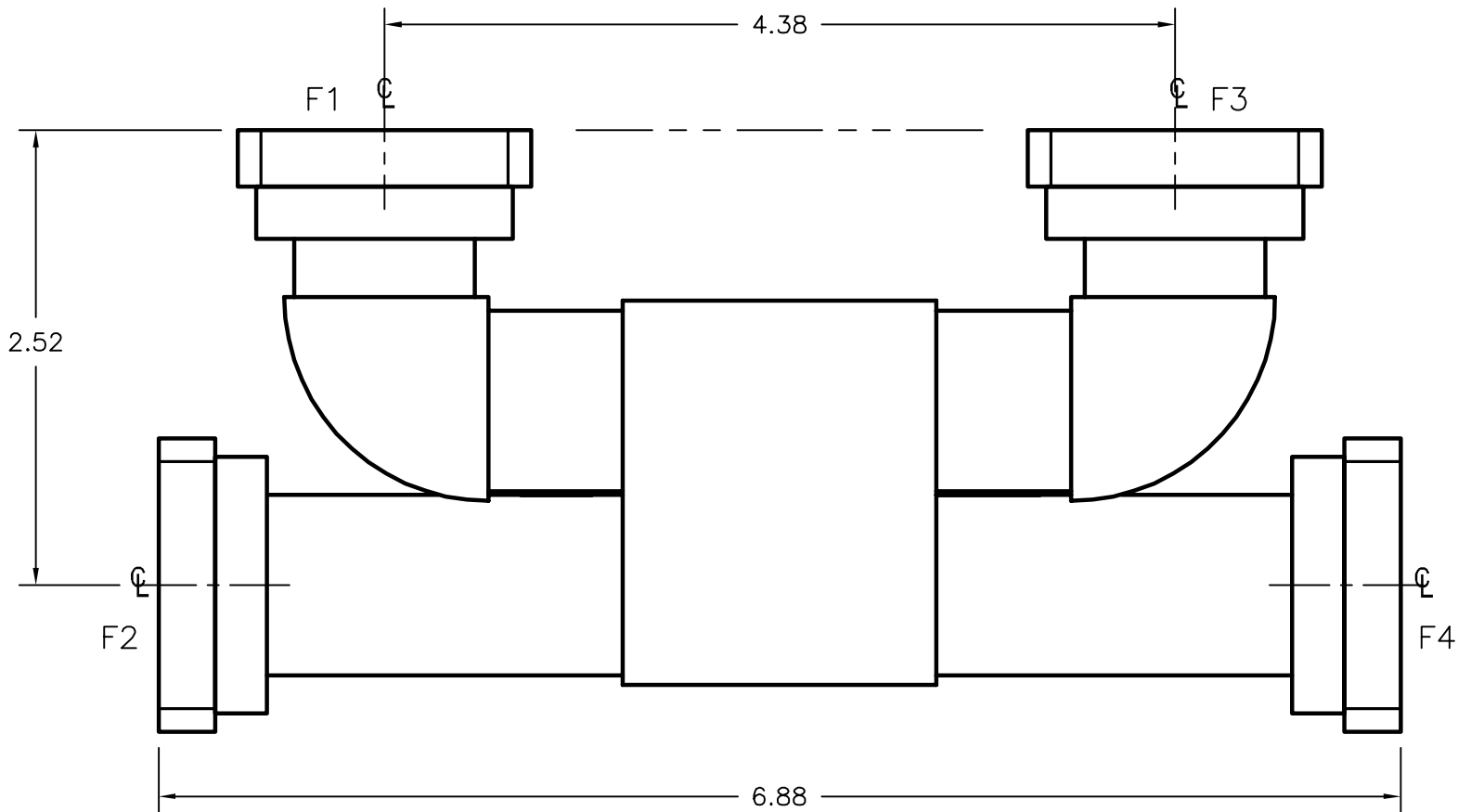

FLANGE TYPE
1 = CPRG
2 = CPRF
3 = CMR STANDARD
4 = CMR CLEAR
5 = CMR TAP
6 = UG COVER
7 = UG CHOKE
8 = COVER-GRV.

FREQUENCY	MODEL
8.10-9.30 GHz	90-261X-Z-X-X-X-X
9.10-10.2 GHz	90-262X-Z-X-X-X-X
9.40-10.8 GHz	90-263X-Z-X-X-X-X
10.5-11.9 GHz	90-264X-Z-X-X-X-X

NOTE: REPLACE "F1, F2, F3, & F4" NOTATION WITH NUMBER CORRESPONDING TO FLANGE TYPE DESIRED, AS SHOWN ON TABLE ABOVE.

THIRD ANGLE PROJECTION:		APPROVALS	DATE	<b>ADVANCED TECHNICAL MATERIALS, INC.</b> TEL: (631) 289-0363 FAX: (631) 289-0358 www.atmmicrowave.com	<small>THE INFORMATION IN THIS DRAWING IS PROPRIETARY AND SHALL NOT BE USED OR DISCLOSED WITHOUT THE PRIOR WRITTEN CONSENT OF ATM, INC. DO NOT SCALE DWG.</small>
UNLESS OTHERWISE NOTED, DIMENSIONS ARE IN INCHES, TOLERANCES ARE: FRACTIONS: ±1/64 ANGLES: ±1/2°		DRAWN <b>JLE</b>	<b>10/15/02</b>		
BASIC DIMENSION	DECIMALS 2 PLACE 3 PLACE	CHKD.	APRVD.	<b>OUTLINE, WR90</b> <b>'Z'-STYLE COMBINER-DIVIDER (HYBRID-COUP.)</b>	
UNDER 6"	<b>±.02 ±.005</b>	MATERIAL <b>PER ORDER</b>			
6" - 12"	<b>±.03 ±.010</b>	TREATMENT <b>-</b>			
OVER 12"	<b>±.06 ±.015</b>	FINISH <b>ATM STD. GRAY</b>		SIZE <b>A</b>	CAGE CODE <b>0R8N4</b>
				ATM DWG # <b>5225W</b>	REVISION <b>B</b>
				SCALE <b>1 : 1</b>	MODEL # <b>SEE NOTES</b>
				SHEET <b>1/1</b>	