

|       |          |               |  |
|-------|----------|---------------|--|
| REV A | AUTH JLE | DATE 10/15/02 | INITIAL RELEASE                                      |
| REV B | AUTH RL  | DATE 10/26/06 | FREQ. NOTES CORRECTED; ILLUSTRATION, FORMAT UPDATED. |

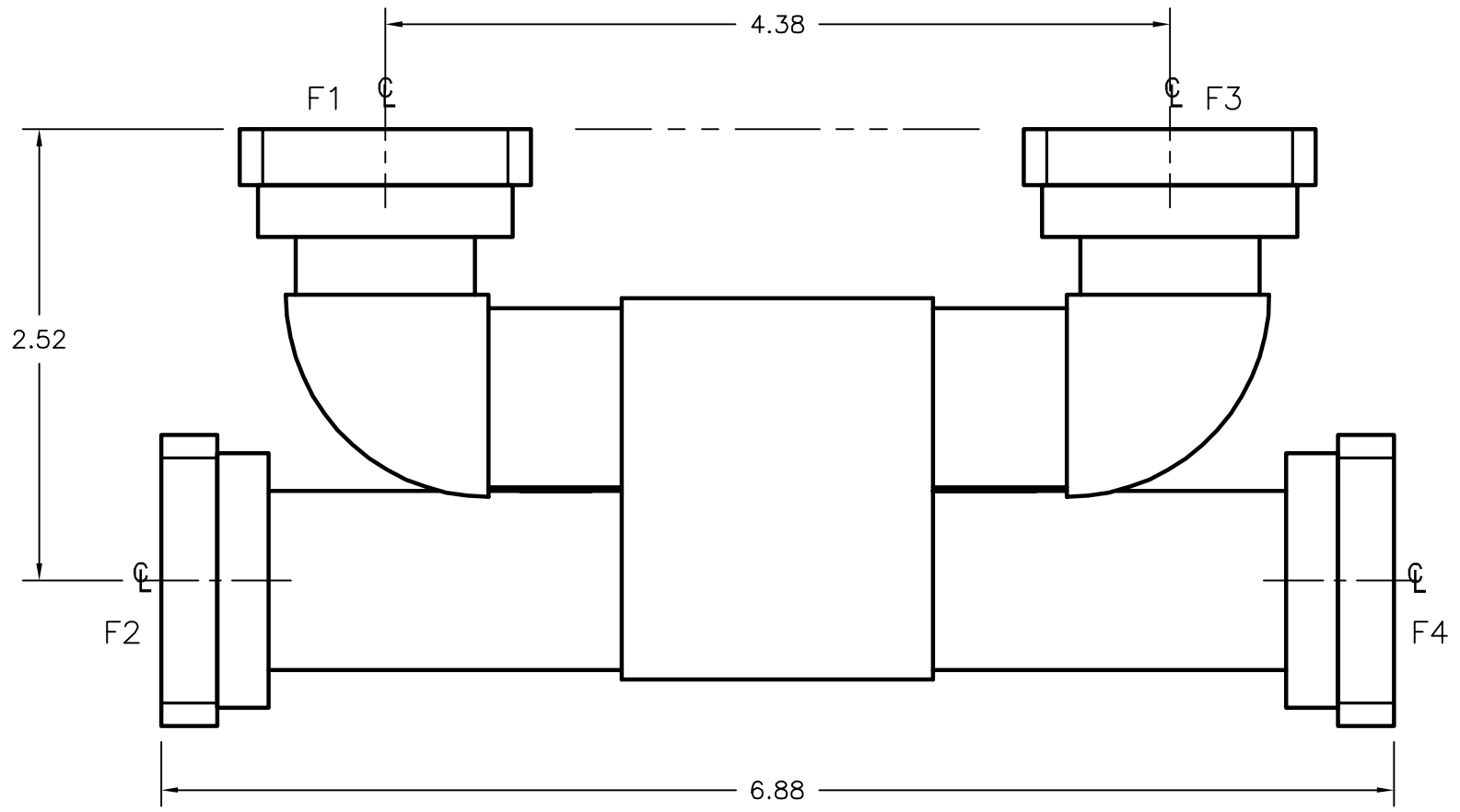

| FLANGE TYPE      |
|------------------|
| 1 = CPRG         |
| 2 = CPRF         |
| 3 = CMR STANDARD |
| 4 = CMR CLEAR    |
| 5 = CMR TAP      |
| 6 = UG COVER     |
| 7 = UG CHOKE     |
| 8 = COVER-GRV.   |

| FREQUENCY     | MODEL             |
|---------------|-------------------|
| 8.10-9.30 GHz | 90-261X-Z-X-X-X-X |
| 9.10-10.2 GHz | 90-262X-Z-X-X-X-X |
| 9.40-10.8 GHz | 90-263X-Z-X-X-X-X |
| 10.5-11.9 GHz | 90-264X-Z-X-X-X-X |

NOTE: REPLACE "F1, F2, F3, & F4" NOTATION WITH NUMBER CORRESPONDING TO FLANGE TYPE DESIRED, AS SHOWN ON TABLE ABOVE.

|   |                             |                             |  |  |   |                   |
|---|-----------------------------|-----------------------------|--|--|---|-------------------|
| THIRD ANGLE PROJECTION:   |                             | APPROVALS                   | DATE   | <b>ADVANCED TECHNICAL MATERIALS, INC.</b><br>TEL: (631) 289-0363 FAX: (631) 289-0358<br>www.atmmicrowave.com | <small>THE INFORMATION IN THIS DRAWING IS PROPRIETARY AND SHALL NOT BE USED OR DISCLOSED WITHOUT THE PRIOR WRITTEN CONSENT OF ATM, INC. DO NOT SCALE DWG.</small> |                   |
| UNLESS OTHERWISE NOTED, DIMENSIONS ARE IN INCHES, TOLERANCES ARE:<br>FRACTIONS: ±1/64 ANGLES: ±1/2° |                             | DRAWN <b>JLE</b>            | <b>10/15/02</b>  |  |   |                   |
| BASIC DIMENSION   | DECIMALS<br>2 PLACE 3 PLACE | APRVD.                      | <b>OUTLINE, WR90</b><br><b>'Z'-STYLE COMBINER-DIVIDER (HYBRID-COUP.)</b> |  |   |                   |
| UNDER 6"  | ±.02 ±.005                  | MATERIAL <b>PER ORDER</b>   |  |  |   |                   |
| 6" - 12"  | ±.03 ±.010                  | TREATMENT <b>-</b>          |  |  |   |                   |
| OVER 12"  | ±.06 ±.015                  | FINISH <b>ATM STD. GRAY</b> | SIZE <b>A</b>  | CAGE CODE 0R8N4  | ATM DWG # <b>5225W</b>  | REVISION <b>B</b> |
|   |                             |                             | SCALE <b>1 : 1</b>   | MODEL # <b>SEE NOTES</b>   | SHEET <b>1/1</b>  |                   |