

REV A	AUTH JLE	DATE 10/15/02	INITIAL RELEASE
REV B	AUTH RL	DATE 10/26/06	FREQ. NOTES CORRECTED; ILLUSTRATION, FORMAT UPDATED.

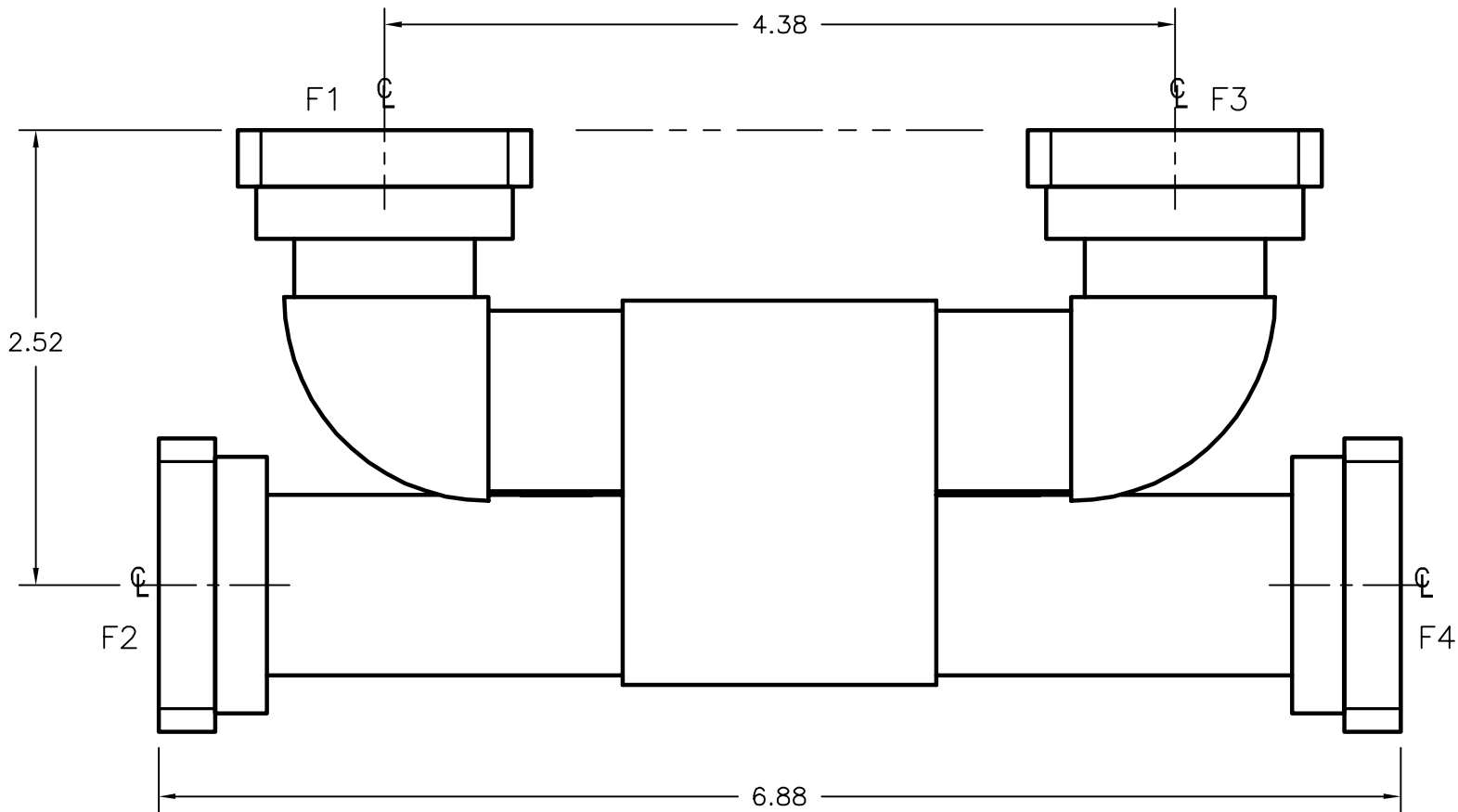

FLANGE TYPE
1 = CPRG
2 = CPRF
3 = CMR STANDARD
4 = CMR CLEAR
5 = CMR TAP
6 = UG COVER
7 = UG CHOKE
8 = COVER-GRV.

FREQUENCY	MODEL
8.10-9.30 GHz	90-261X-Z-X-X-X-X
9.10-10.2 GHz	90-262X-Z-X-X-X-X
9.40-10.8 GHz	90-263X-Z-X-X-X-X
10.5-11.9 GHz	90-264X-Z-X-X-X-X

NOTE: REPLACE "F1, F2, F3, & F4" NOTATION WITH NUMBER CORRESPONDING TO FLANGE TYPE DESIRED, AS SHOWN ON TABLE ABOVE.

THIRD ANGLE PROJECTION:		APPROVALS	DATE	ADVANCED TECHNICAL MATERIALS, INC. TEL: (631) 289-0363 FAX: (631) 289-0358 www.atmmicrowave.com	<small>THE INFORMATION IN THIS DRAWING IS PROPRIETARY AND SHALL NOT BE USED OR DISCLOSED WITHOUT THE PRIOR WRITTEN CONSENT OF ATM, INC. DO NOT SCALE DWG.</small>	
UNLESS OTHERWISE NOTED, DIMENSIONS ARE IN INCHES, TOLERANCES ARE: FRACTIONS: ±1/64 ANGLES: ±1/2°		DRAWN JLE	10/15/02			
BASIC DIMENSION	DECIMALS 2 PLACE 3 PLACE	APRVD.	OUTLINE, WR90 'Z'-STYLE COMBINER-DIVIDER (HYBRID-COUP.)			
UNDER 6"	±.02 ±.005	MATERIAL PER ORDER				
6" - 12"	±.03 ±.010	TREATMENT -				
OVER 12"	±.06 ±.015	FINISH ATM STD. GRAY	SIZE A	CAGE CODE 0R8N4	ATM DWG # 5225W	REVISION B
			SCALE 1 : 1	MODEL # SEE NOTES	SHEET 1/1	