

ADC-007

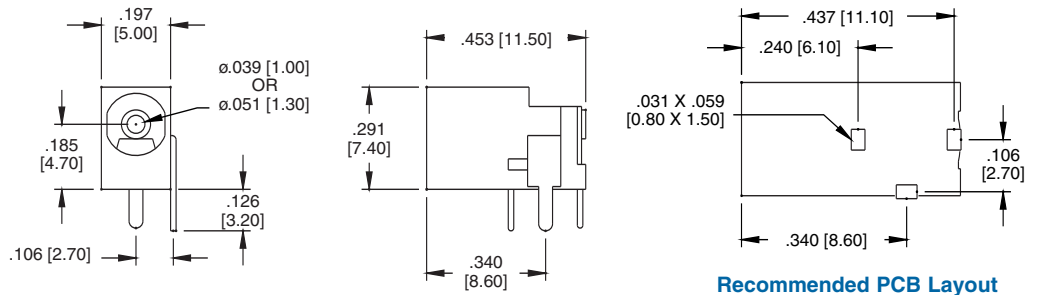

ADC-007-3



ADC-009



ADC-009-3

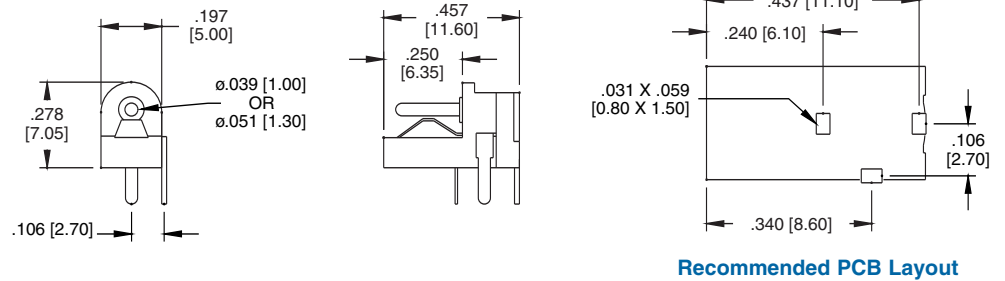

ADC-011

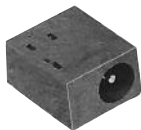

ADC-011-3

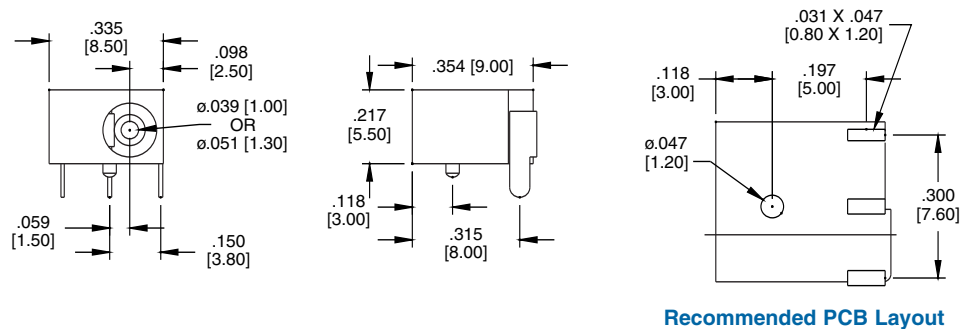

ADC-021



ADC-021-3

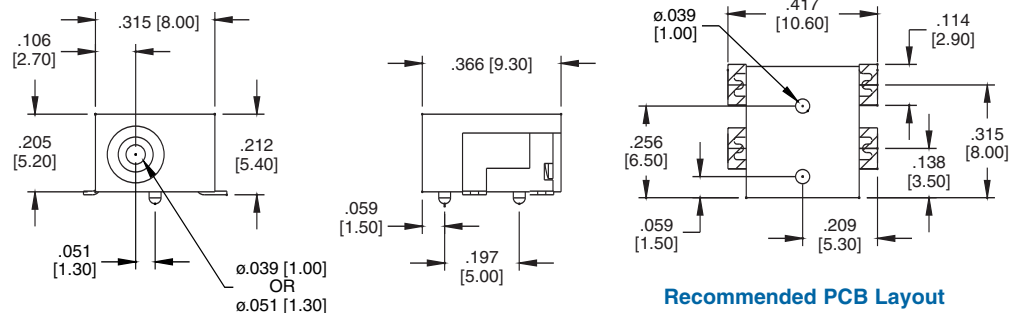

ADC-029



ADC-029-1

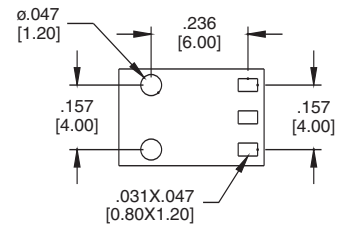
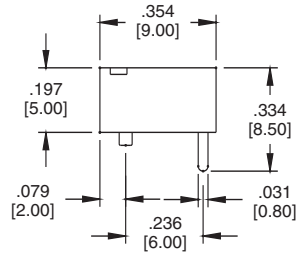
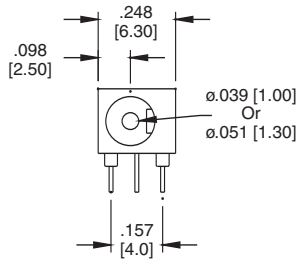

Recommended PCB Layout

ADC-002



ADC-002-2

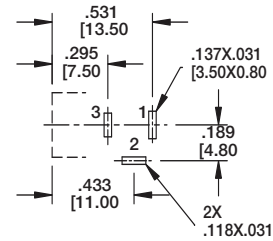
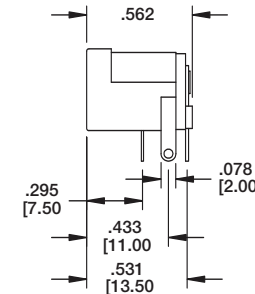
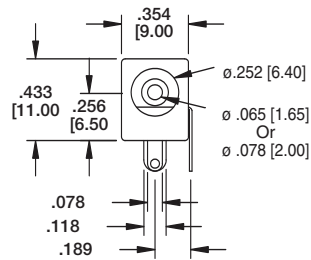

Recommended PCB Layout

ADC-024



ADC-024-8

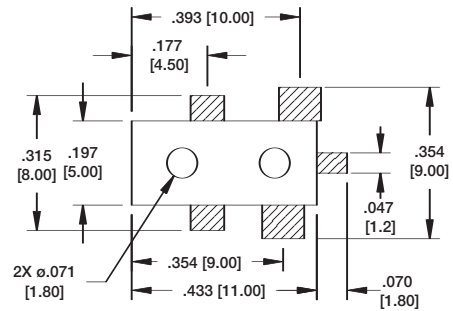
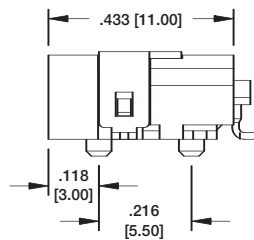
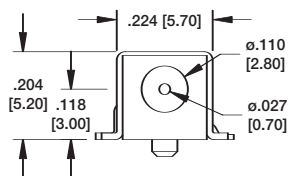

Recommended PCB Layout

ADC-028



ADC-028-2

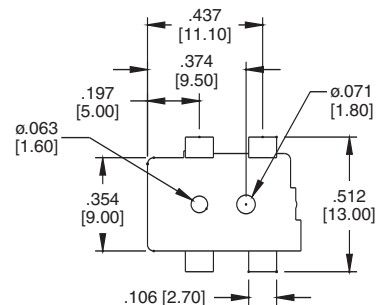
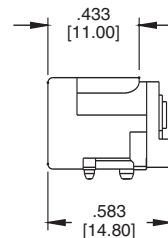
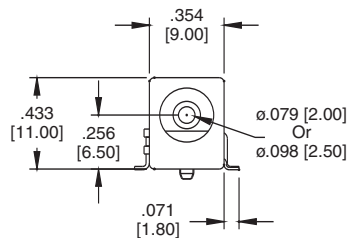

Recommended PCB Layout

ADC-010



ADC-010-1

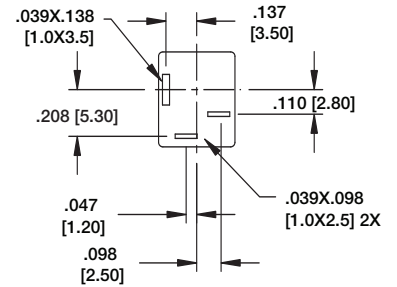
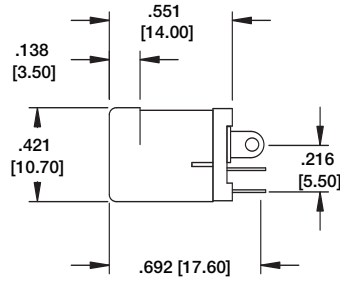
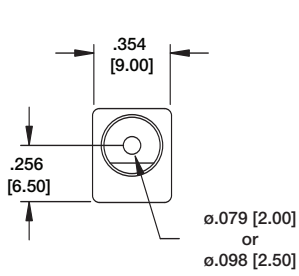

Recommended PCB Layout

ADC-015



ADC-015-2

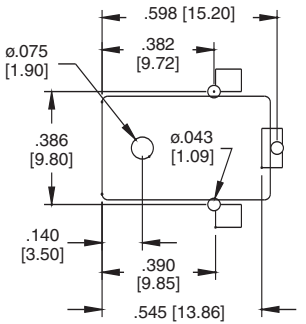
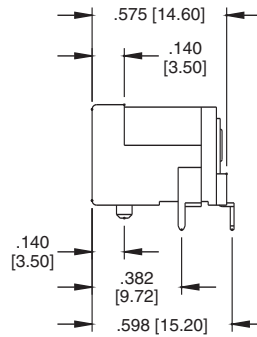
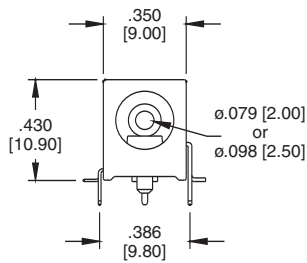

Recommended PCB Layout

ADC-045A



ADC-045A-1

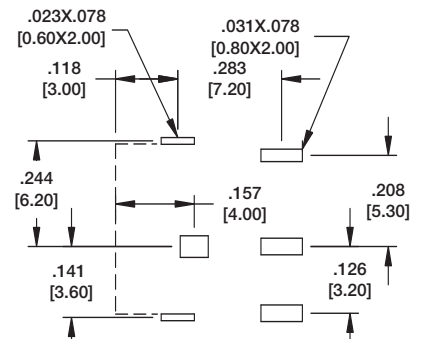
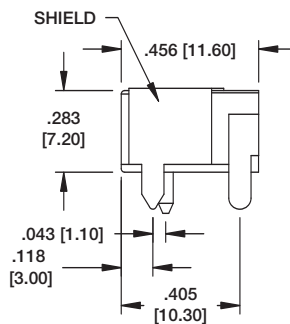
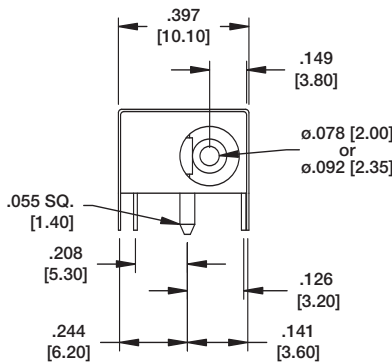

Recommended PCB Layout

DC POWER PLUG WITH STRAIN RELIEF

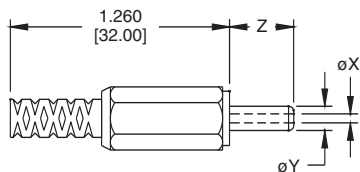

PLUG WITH STRAIN RELIEF	X	Y	Z
ADP-X/Y/Z-SR	$\phi.039 [1.00]$	$\phi.137 [3.50]$.374 [9.50]
ADP-X/Y/Z-SR	$\phi.082 [2.10]$	$\phi.216 [5.50]$.374 [9.50]
ADP-X/Y/Z-SR	$\phi.098 [2.50]$	$\phi.216 [5.50]$.374 [9.50]

DC POWER PLUG WITHOUT STRAIN RELIEF

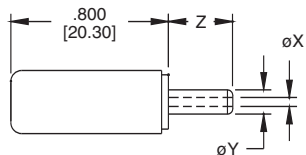

PLUG WITHOUT STRAIN RELIEF	X	Y	Z
ADP-X/Y/Z	$\phi.039 [1.00]$	$\phi.137 [3.50]$.374 [9.50]
ADP-X/Y/Z	$\phi.082 [2.10]$	$\phi.216 [5.50]$.374 [9.50]
ADP-X/Y/Z	$\phi.098 [2.50]$	$\phi.216 [5.50]$.374 [9.50]