

# POWER TRANSFORMER

## DCS8-36 (F) SERIES

### 1. CONFIGURATION & DIMENSIONS :

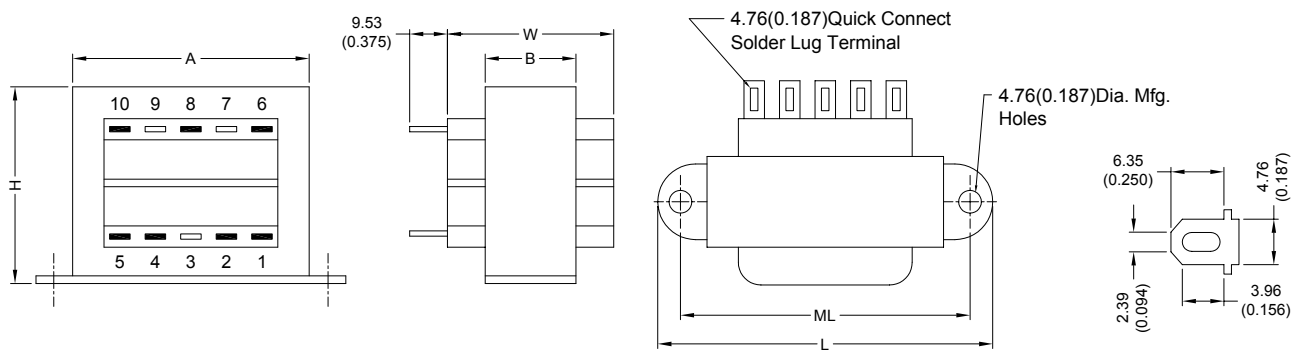

UNIT : mm (inch)

| SIZE | VA  | L                 | W                | H                | A                | B                | ML               | gram    |
|------|-----|-------------------|------------------|------------------|------------------|------------------|------------------|---------|
| 8    | 100 | 102.40<br>(4.031) | 57.15<br>(2.250) | 65.10<br>(2.563) | 77.80<br>(3.063) | 33.35<br>(1.313) | 90.50<br>(3.563) | 1247.38 |

### 2. SCHEMATIC :

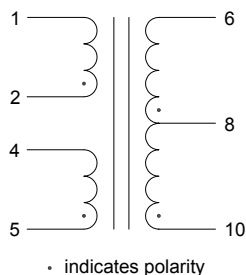

### 3. ELECTRICAL CHARACTERISTICS (@ 25°C) :

- |                                      |                              |
|--------------------------------------|------------------------------|
| a. Primary Voltage                   | AC 115/230 V 50/60 Hz .      |
| b. No Load Primary Current           | Less Than 85mA / 130mA .     |
| c. Secondary Voltage (±5%)           |                              |
| Pin 6-10 C.T. Pin 8                  | AC 40.10 V / 40.00 V .       |
| d. Secondary Load Current            | 2.80A .                      |
| e. Full Load Primary Current         | Less Than 1.10mA / 0.60mA .  |
| f. Full Load Secondary Voltage (±5%) | 36.00V / 36.00V .            |
| Pin 6-10 C.T. Pin 8                  |                              |
| g. DC Resistance                     |                              |
| Pin 1-2                              | Primary-1 = 7.93 Ohm .       |
| Pin 4-5                              | Primary-2 = 9.48 Ohm .       |
| Pin 6-8                              | Secondary-1 = 0.249 Ohm .    |
| Pin 8-10                             | Secondary-2 = 0.280 Ohm .    |
| h. Insulation Resistance             | DC 500V 100Meg Ohm Of More . |
| i. Withstand Voltage (Hi-Pot)        | AC 2500V 60Hz 1 Minutes .    |
| j. Temperature Rise                  | Less Than 60 Deg C .         |
| k. Core Size                         | EI-76 x 32.50 m/m .          |

#### l. Turns & Wire Gauge

|           |            |          |                |         |
|-----------|------------|----------|----------------|---------|
| Primary-1 | Pin 1-2    | 40S      | Turns Diameter | 0.40 mm |
| Primary-2 | Pin 4-5    | 40S      | Turns Diameter | 0.40 mm |
|           | Pin 6-8-10 | 0-72-144 | Turns Diameter | 0.80 mm |



**RoHS Compliant**

NOTE : Specifications subject to change without notice. Please check our website for latest information.

25.02.2008



**SUPERWORLD ELECTRONICS (S) PTE LTD**

PG. 1