

MS-228-6

Mains switching Reed Sensor • M8 thread



Electrical Characteristics

Contact form		A
Contact rating max.	W / VA	50
Switching current max.	A	1.5
Carry current max.	A	2.0
Switching voltage max.	VDC	200
	VAC	250
Breakdown voltage min.	VDC	400
Contact resistance (initial) max.	mΩ	100
Insulation resistance min.	Ω	10 ¹⁰
Capacitance typ.	pF	0.5

Magnetical Characteristics

Pull in range available ¹	AT	25-40
---	----	-------

¹ AT range stated for **unmodified** Reed Switch

Operating Characteristics

Operate time (incl. bounce) max.	ms	1.0
Release time max.	ms	0.4
Switching frequency max.	Hz	300
Resonant frequency typ.	Hz	2,600
Vibration (50-2000 Hz)	g	20
Shock (1/2 sin 11 ms)	g	50
Operating temperature	°C	-20 to +85

Dimensions

in mm

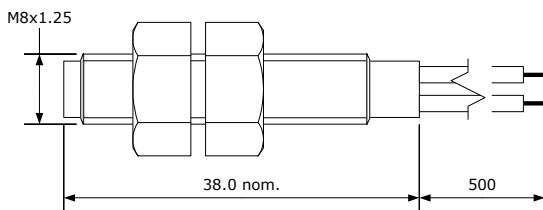

Wire: AWG 24, black, stripped and tinned

Ordering Information

Series	AT Range
MS-228-6	3 = 20-25 / 4 = 25-30 / 5 = 30-35 / 6 = 35-40

Ordering example: MS-228-6-4 describes MS-228-6 with 25-30 AT

Customized types available.

MS-228-6

Mains switching Reed Sensor • M8 thread



Matching Actuator MSM-228

in mm

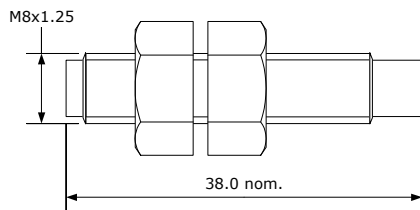

Customized types and other magnet orientations available.