

# D Series (Standard D-Sub)

# Dual Port Solder Dip

## Specifications

Insulation Resistance: 5,000MΩ min.  
 Withstanding Voltage: 1,000 V AC  
 Contact Resistance: 10mΩ max.  
 Current Rating: 5A  
 Operating Temp. Range: -55°C to +105°C

## Materials and Finish

Shell: Steel, Tin plated  
 Insulator: Polyester Resin (glass filled)  
 Fiber reinforced, UL94V-0  
 Contacts: Stamped Copper Alloy  
 Plating: Gold over Nickel

## Part Number (Details)

**D DP - 01 \* \* 1**

Series

Connector Version:  
 DP = Dual Port

No. of Contacts (Top / Bottom):  
 01 = 9 / 9  
 02 = 15 / 15  
 03 = 25 / 25  
 10 = 37 / 37

Connector Types (Top / Bottom):  
 1 = Male / Male  
 2 = Male / Female  
 3 = Female / Male  
 4 = Female / Female

Vertical Distance between Connectors:  
 S = 15.88mm, M = 19.05mm, L = 22.86mm

Assembly:  
 1 = Snap-in + 4-40 Clinch Nut (Standard)  
 2 = 4-40 Threaded

## Applicable Dimensions (Reference Only)

### Outline Connector Dimensions

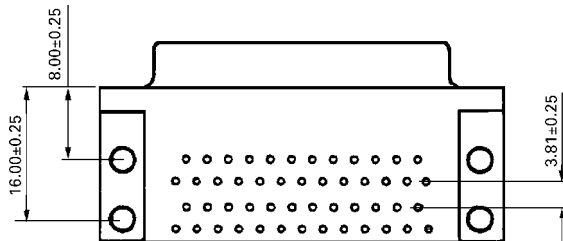

### Recommended PCB Layouts

Top View

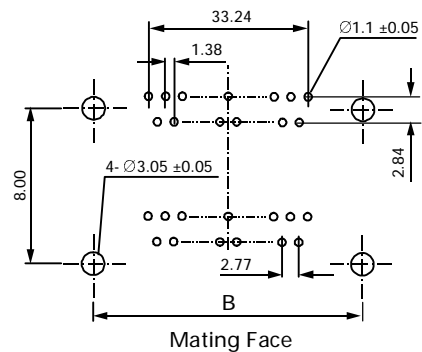

| Part Number | No. of Contacts | A     | B     | C     | Vertical Distances | E     | F     |
|-------------|-----------------|-------|-------|-------|--------------------|-------|-------|
| DDP-01**1   | 9 / 9           | 30.81 | 24.99 | 16.33 | Type S             | 15.88 | 28.42 |
| DDP-02**1   | 15 / 15         | 39.14 | 33.32 | 24.66 | Type M             | 19.05 | 31.60 |
| DDP-03**1   | 25 / 25         | 53.04 | 47.04 | 38.38 | Type L             | 22.86 | 35.41 |
| DDP-10**1   | 37 / 37         | 69.32 | 63.50 | 54.84 |                    |       |       |