

D Series (Standard D-Sub)

Dual Port Solder Dip

Specifications

Insulation Resistance: 5,000MΩ min.
 Withstanding Voltage: 1,000 V AC
 Contact Resistance: 10mΩ max.
 Current Rating: 5A
 Operating Temp. Range: -55°C to +105°C

Materials and Finish

Shell: Steel, Tin plated
 Insulator: Polyester Resin (glass filled)
 Fiber reinforced, UL94V-0
 Contacts: Stamped Copper Alloy
 Plating: Gold over Nickel

Part Number (Details)

D DP - 01 * * 1

Series

Connector Version:
 DP = Dual Port

No. of Contacts (Top / Bottom):
 01 = 9 / 9
 02 = 15 / 15
 03 = 25 / 25
 10 = 37 / 37

Connector Types (Top / Bottom):
 1 = Male / Male
 2 = Male / Female
 3 = Female / Male
 4 = Female / Female

Vertical Distance between Connectors:
 S = 15.88mm, M = 19.05mm, L = 22.86mm

Assembly:
 1 = Snap-in + 4-40 Clinch Nut (Standard)
 2 = 4-40 Threaded

Applicable Dimensions (Reference Only)

Outline Connector Dimensions

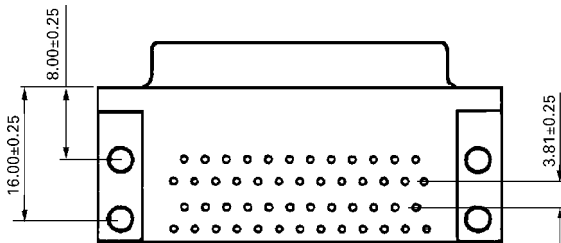
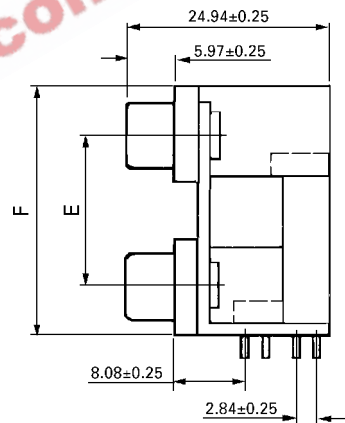
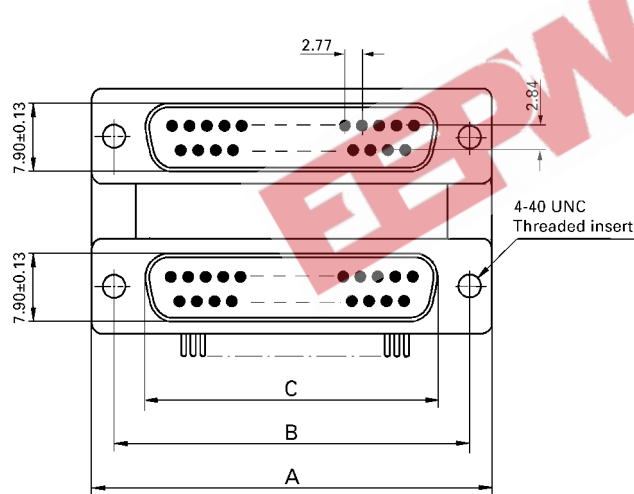

Recommended PCB Layouts

Top View

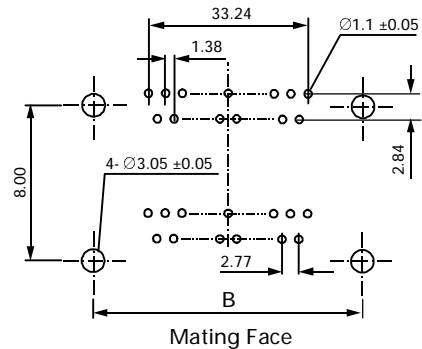

Mating Face

Part Number	No. of Contacts	A	B	C	Vertical Distances	E	F
DDP-01**1	9 / 9	30.81	24.99	16.33	Type S	15.88	28.42
DDP-02**1	15 / 15	39.14	33.32	24.66	Type M	19.05	31.60
DDP-03**1	25 / 25	53.04	47.04	38.38	Type L	22.86	35.41
DDP-10**1	37 / 37	69.32	63.50	54.84			