

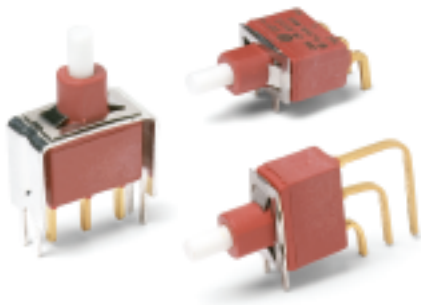

Pushbutton

# C&K E010 Series Sealed Momentary Pushbutton Switches



## Features/Benefits

- **Process sealed, withstands soldering and cleaning**
- **Long life contact design**
- **Snap-fitting plunger available, accepts a variety of caps**
- **RoHS compliant models available**

## Typical Applications

- **Instrumentation**
- **Telecommunications and networking equipment**
- **Computers and peripherals**



## Specifications

CONTACT RATING: Q contact material: 4 AMPS @ 125 V AC or 28 V DC. See page A-48 for additional ratings.

ELECTRICAL LIFE: 40,000 make-and-break cycles at full load.

CONTACT RESISTANCE: Below 20 mΩ typ. initial @ 2-4 V DC, 100 mA, for both silver and gold plated contacts.

INSULATION RESISTANCE: 10<sup>9</sup>Ω min.

DIELECTRIC STRENGTH: 1000 Vrms min. @ sea level.

OPERATING TEMPERATURE: -30°C to 75°C.

CAP INSTALLATION FORCE: 10 lbs. max. permissible.

SOLDERABILITY: Per MIL-STD-202F method 208D, or EIA RS-186E method 9 (1 hour steam aging).

**NOTE:** Any models supplied with P, Q, B or G contact material are RoHS compliant. For the latest information regarding RoHS compliance, please go to: [www.ittcannon.com/rohs](http://www.ittcannon.com/rohs).

**NOTE:** Specifications and materials listed above are for switches with standard options. For information on specific and custom switches, consult Customer Service Center.

## Materials

CASE & BUSHING: Glass filled nylon 6/6, flame retardant (UL 94V-0).

PLUNGER: Glass filled nylon or glass filled polyester (PBT) (UL 94V-0), with internal o-ring seal standard.

SWITCH SUPPORT: Brass or steel, matte-tin plated.

SWITCH SUPPORT RETAINER: Stainless steel.

END CONTACTS: Q contact material: Coin silver, silver plated. See A-48 for additional ratings.

CENTER CONTACTS & ALL TERMINALS: Q contact material: Copper alloy, silver plated. See page A-48 for additional ratings.

TERMINAL SEAL: Epoxy.

HARDWARE: Nut & locking ring-Brass, nickel plated. Lockwasher-Steel, nickel plated.

## Build-A-Switch

To order, simply select desired option from each category and place in the appropriate box. Available options are shown and described on pages A-45 thru A-49. For additional options not shown in catalog, consult Customer Service Center. All models are process sealed to withstand machine soldering temperatures and pressure wash cleaning methods.

<p><b>Switch Function</b> _____</p> <p><b>E112</b> SPDT On-Mom.</p> <p><b>Plunger</b> _____</p> <p><b>S</b> .222" high</p> <p><b>L</b> .338" high</p> <p><b>M</b> .331" high, snap-fitting</p> <p><b>Bushing</b> _____</p> <p><b>D1</b> Unthreaded</p> <p><b>Y</b> Threaded, keyway</p>	<p><b>Terminations</b> _____</p> <p><b>A</b> Right angle, PC thru-hole</p> <p><b>AV2</b> Vertical right angle, PC thru-hole</p> <p><b>C</b> PC Thru-hole</p> <p><b>A3</b> Right angle, snap-in, PC thru-hole</p> <p><b>AV3</b> Vertical right angle, snap-in, PC thru-hole</p> <p><b>R2</b> Right angle with PCB</p> <p><b>V3</b> .460" high, V-bracket</p> <p><b>V4</b> .630" high, V-bracket</p> <p><b>V6</b> .460" high, V-bracket</p> <p><b>V8</b> .953" high, V-bracket</p> <p><b>V31</b> .460" high, snap-in V-bracket</p> <p><b>V81</b> .953" high, snap-in V-bracket</p> <p><b>V91</b> 1.150" high, snap-in V-bracket</p> <p><b>W</b> .750" long, wire wrap</p> <p><b>Z</b> Solder lug</p>	<p><b>Contact Material</b> _____</p> <p><b>B</b> Gold</p> <p><b>K</b> Gold, tin-lead</p> <p><b>P</b> Gold, matte-tin</p> <p><b>Q</b> Silver</p> <p><b>G</b> Gold over silver</p> <p><b>Seal</b> _____</p> <p><b>E</b> Epoxy</p>
---	--	---



Dimensions are shown: Inches (mm)  
Specifications and dimensions subject to change

# C&K E010 Series Sealed Momentary Pushbutton Switches

## SWITCH FUNCTION



NO. POLES	MODEL NO.	SWITCH FUNCTION		CONNECTED TERMINALS		SCHEMATIC
		POS. 1	POS. 2	POS. 1	POS. 2	
SP	<b>E112</b>	ON	MOM.	2-1	2-3	
<p><b>SPDT</b></p> <p>Part number shown: E112SD1CQE</p>						

MOM. = Momentary

All models with all options when ordered with G or Q contact material.

## PLUNGER



**S** .218" HIGH

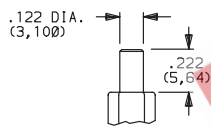

Standard with D1 bushing (as shown).  
† Subtract .100 (2,54) from plunger length when ordered with Y bushing.

**L** .338" HIGH

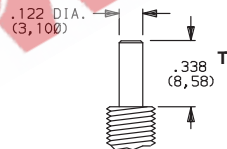

Standard with Y bushing (as shown).  
\*\* Add .100 (2,54) from plunger length when ordered with D1 bushing.

**M** .331" HIGH, SNAP-FITTING

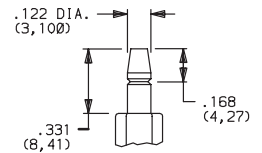

**NOTE:** Caps available for all plunger options, see pages A-48 and A-49.

## BUSHING



**D1** UNTHREADED

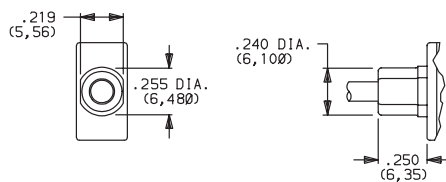

S plunger standard with D1 bushing.

**Y** THREADED, KEYWAY

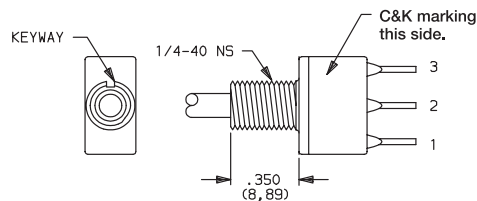

L plunger standard with Y bushing. Available only with C, Z terminations.  
Hardware: One dress nut part number 780701201, one hex nut and lockwasher supplied standard.  
**Withstands 4 in./lbs. without distortion.**

**PANEL MOUNTING**

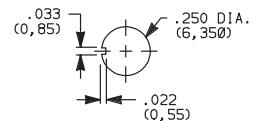

**NOTE:** Internal o-ring actuator seal standard for all bushing options.



Dimensions are shown: Inches (mm)  
Specifications and dimensions subject to change



# C&K E010 Series Sealed Momentary Pushbutton Switches

## TERMINATIONS

Pushbutton

### C PC THRU-HOLE

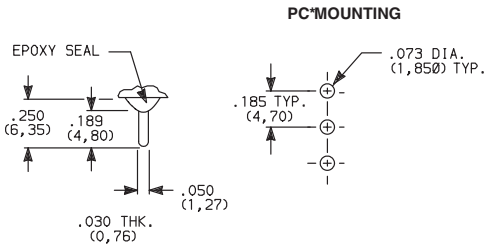

**SPDT**

### Z SOLDER LUG

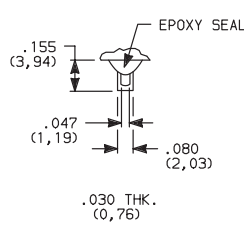

**SPDT** Not available with K contact materials.

### W WIRE WRAP

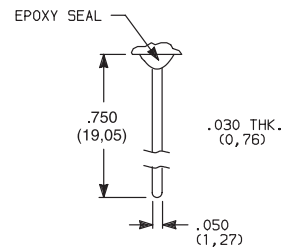

**SPDT**

### A RIGHT ANGLE, PC THRU-HOLE



**E112SD1ABE SPDT**

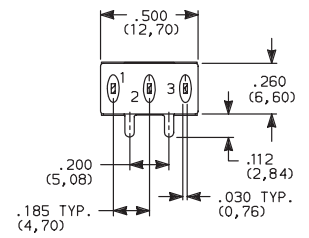
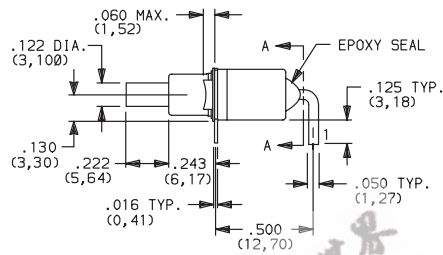
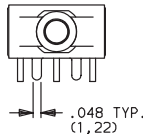

SECTION A-A

### A3 RIGHT ANGLE, SNAP-IN, PC THRU-HOLE

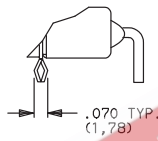
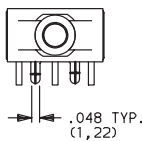

### AW RIGHT ANGLE, EXTENDED, PC THRU-HOLE

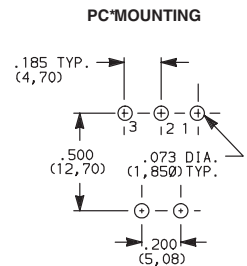
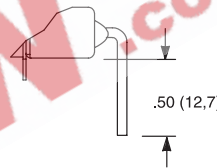

PC MOUNTING

**NOTE:** Terminal bend radii and lead-in manufacturing option. Available with D1 bushing only.

### AV2 VERTICAL RIGHT ANGLE, PC THRU-HOLE, .150" PITCH

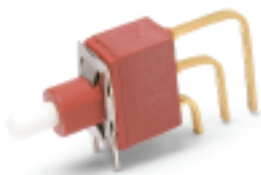

**E112SD1AV2BE SPDT**

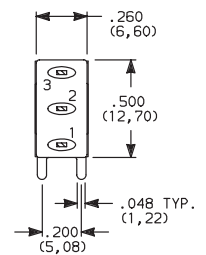
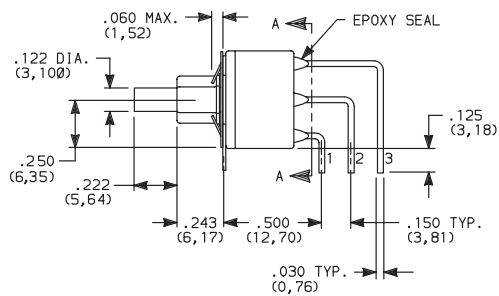
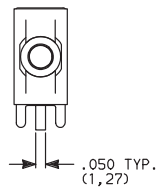

SECTION A-A

### AV3 VERTICAL RIGHT ANGLE, SNAP-IN, PC THRU-HOLE, .150" PITCH

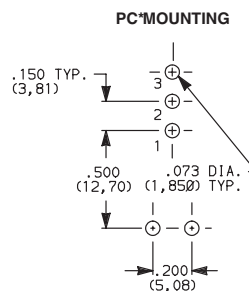
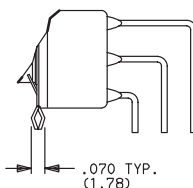
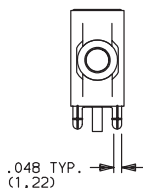

PC MOUNTING

**NOTE:** Terminal bend radii and lead-in manufacturing option. Available with D1 bushing only.



Dimensions are shown: Inches (mm)  
Specifications and dimensions subject to change



# C&K E010 Series Sealed Momentary Pushbutton Switches

## TERMINATIONS

### R2 RIGHT ANGLE WITH PCB

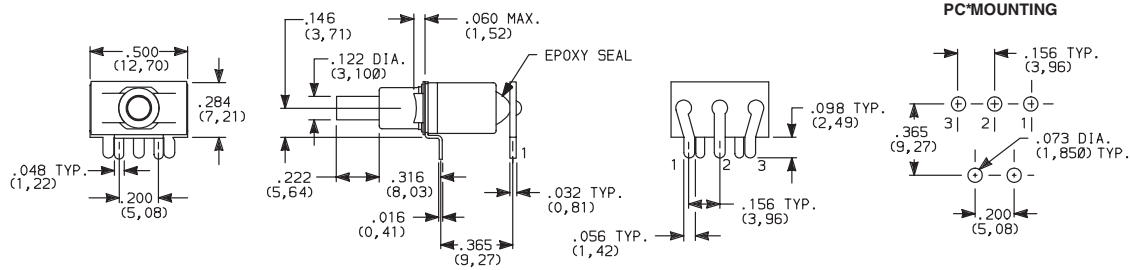

E112SD1R2BE  
SPDT

NOTE: Available with D1 bushing and B contact material only.

### V3, V4 VERTICAL MOUNT, V-BRACKET

### V31, V91 VERTICAL MOUNT, V-BRACKET, SNAP-IN

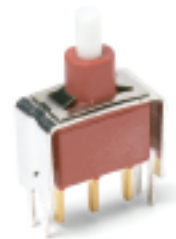
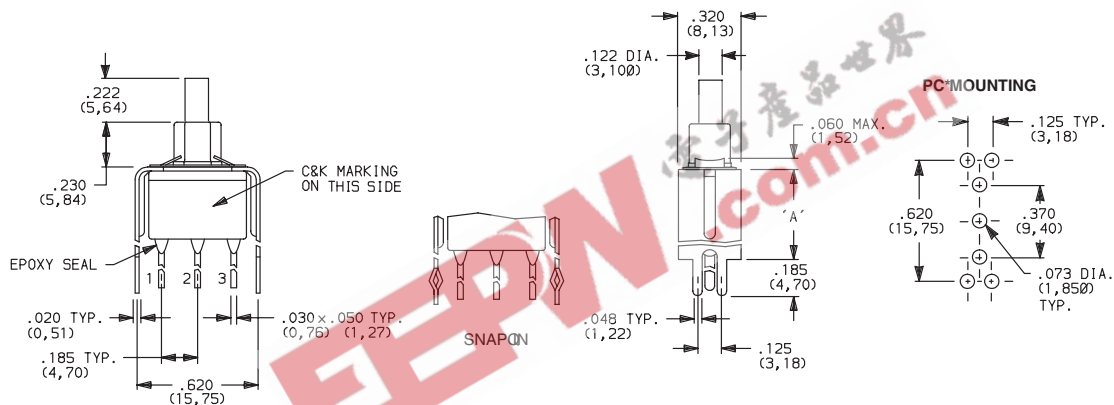

E112SD1\_BE  
SPDT

OPTION CODE	DIM 'A'
V3, V31	.460 (11,68)
V4	.630 (16,00)
V91	1.150 (29,21)

NOTE: Available with D1 bushing only.

### V6, V8 VERTICAL MOUNT, V-BRACKET

### V81 VERTICAL MOUNT, V-BRACKET, SNAP-IN

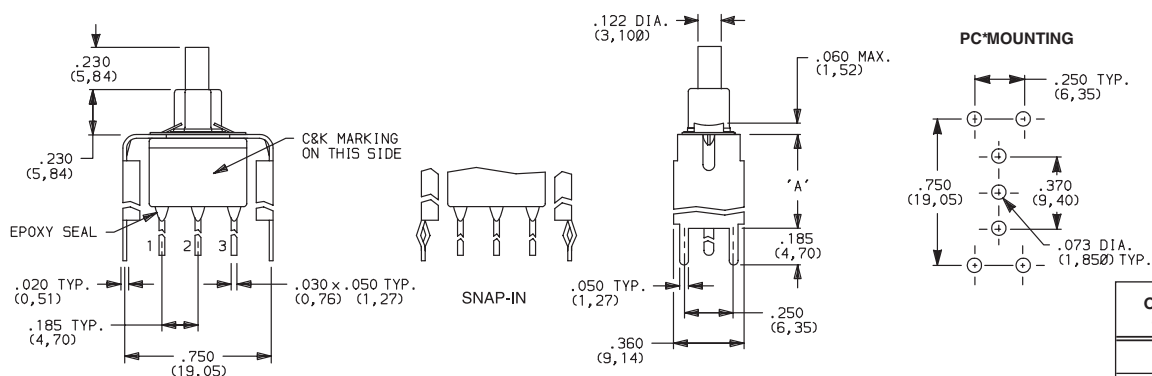

E112SD1\_BE  
SPDT

OPTION CODE	DIM 'A'
V6	.460 (11,68)
V8, V81	.953 (24,21)

NOTE: Available with D1 bushing only.

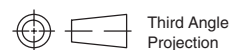

Third Angle Projection

Dimensions are shown: Inches (mm)  
Specifications and dimensions subject to change



# C&K E010 Series Sealed Momentary Pushbutton Switches

## AVAILABLE HARDWARE

Cap, Snap-fitting plunger

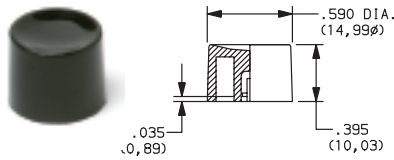

**PART NO.**  
**894001000** WHITE  
**894002000** BLACK  
**894003000** RED

Material: Nylon  
 Finish: Gloss

Cap, Snap-fitting plunger

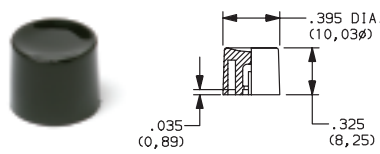

**PART NO.**  
**894101000** WHITE  
**894102000** BLACK  
**894103000** RED

Material: Nylon  
 Finish: Gloss

Cap

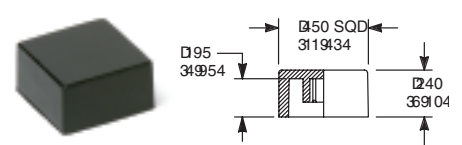

**PART NO.**  
**484601000** WHITE  
**484602000** BLACK  
**484603000** RED

Material: Nylon  
 Finish: Gloss

**PART NO.**  
**798201000** WHITE  
**798202263** BLACK  
**798203000** RED

Material: Nylon  
 Finish: Matte

**NOTE:** Additional nuts, locking rings and lockwashers available separately, see section "Technical Data and Additional Hardware". Other cap colors available, consult Customer Service Center.

Frames snap into panel opening and are independent from switch mounting. Accurate positioning of the PC mounted switch relative to the panel opening is necessary to provide proper clearance between actuator and frame. Available in two basic styles and four panel thicknesses .047-.125 in. Material: Nylon. Finish: Matte.

TYPICAL APPLICATION

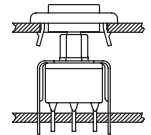

.047" (1,19) PANEL THK.	.062" (1,57) PANEL THK.	.090" (2,29) PANEL THK.	.125" (3,18) PANEL THK.
<b>PART NO.</b> <b>432501000</b> <b>432502263</b> <b>432503000</b>	<b>PART NO.</b> <b>432601000</b> <b>432602263</b> <b>432603000</b>	<b>PART NO.</b> <b>432701000</b> <b>432702263</b> <b>432703000</b>	<b>PART NO.</b> <b>432801000</b> WHITE <b>432802263</b> BLACK <b>432803000</b> RED

PANEL MOUNTING

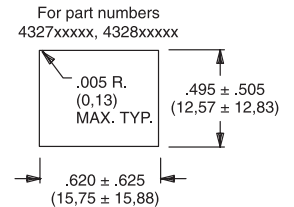
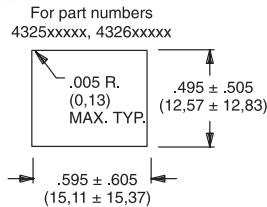

Panel Inserts

Above frames (part nos. 432XXXXXX) are also available with insert which accepts LED for indicator light assembly. Order insert separately from frame. Blank insert panel (without hole for LED) also available. **LED not included.**

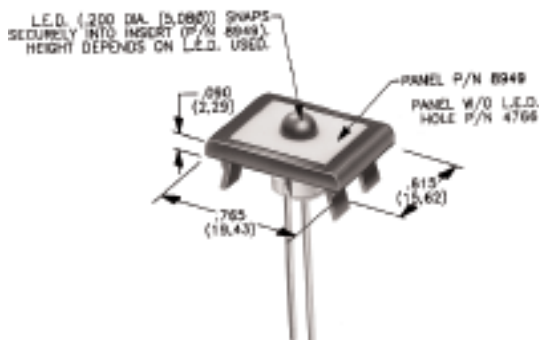

PANEL INSERT WITH HOLE FOR LED

**PART NO.**  
**894901000**  
**894902000**  
**894903000**

BLANK PANEL INSERT WITHOUT HOLE FOR LED

**PART NO.**  
**476601000** WHITE  
**476602000** BLACK  
**476603000** RED

Special colors, custom markings available, consult Customer Service Center.



Third Angle Projection

Dimensions are shown: Inches (mm)  
 Specifications and dimensions subject to change

