

Schottky Barrier Diodes 20V

Type No.	Parameter	Absolute Maximum Ratings					Electrical Characteristics (Ta=25°C)					Others			
		V _{RM} (V)	I _{F(AV)} (A) With Heatsink	I _{F(SM)} (A) 50Hz Half-cycle Sinewave Single Shot	T _J (°C)	T _{stg} (°C)	V _F (V) max per element	I _R (mA) V _R =V _{RM} max per element	I _{R(H)} (mA) V _R =V _{RM} , Ta=100°C max per element	t _{rr} (ns)	R _{th(j-c)} (°C/W)	Mass (g)	Remarks	Fig.	
FMB-G12L	20	20	5.0	100	-40 to +150	0.47	5.0	2.0	35	100	500/500	4.0	2.1	1 Chip	Ⓐ
FMB-G22H			10.0	200			10.0	5.0	65						
FMB-22L			10.0	100			5.0	2.0	35						
FMB-22H			15.0	150			7.5	3.0	50					Center-tap	Ⓑ
FMB-32			20.0	200			10.0	5.0	65						
FMB-32M			30.0	300			10.0	10.0	100						

FMB-G12L

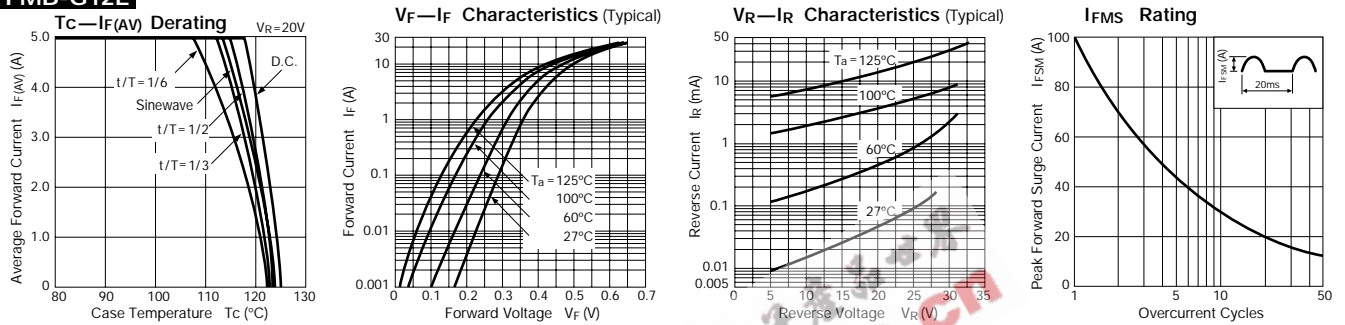

FMB-G22H

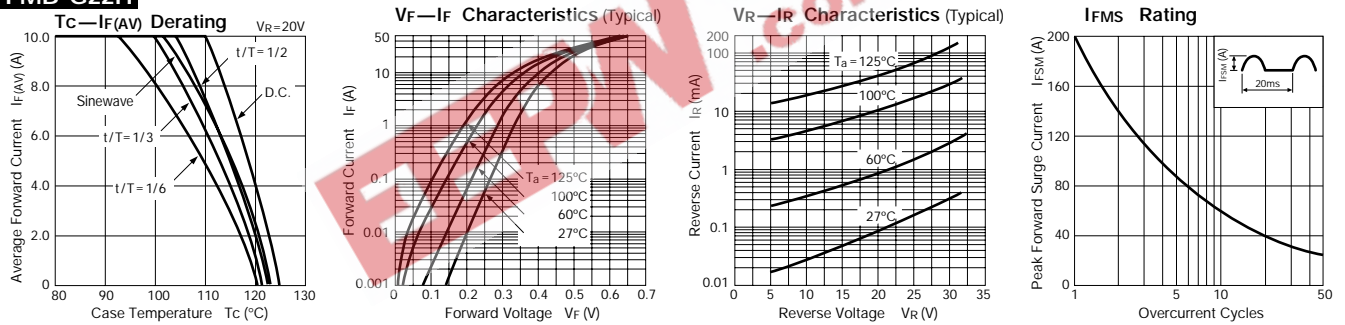

FMB-22L

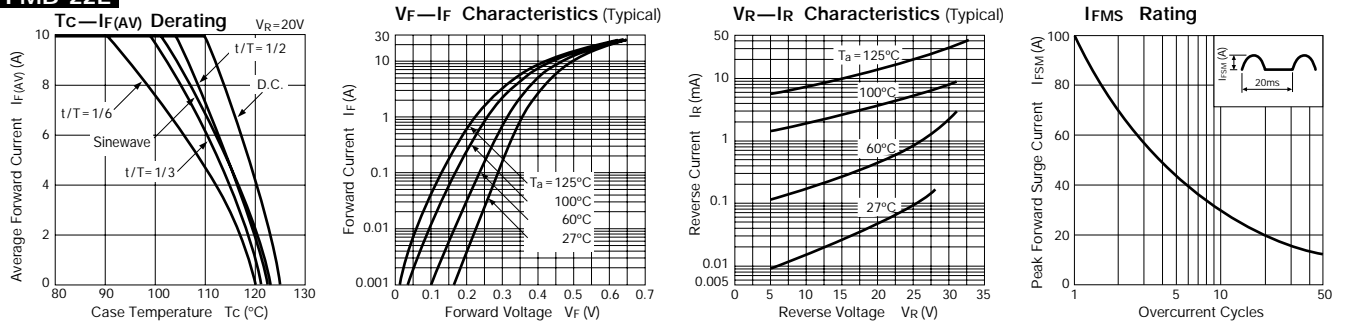

External Dimensions (Unit: mm)

Flammability:
UL94V-0 or Equivalent

Fig. Ⓐ

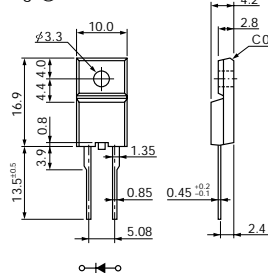

Fig. Ⓑ

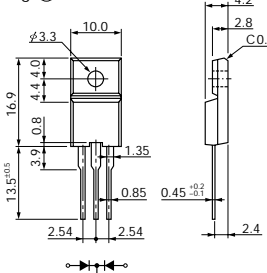
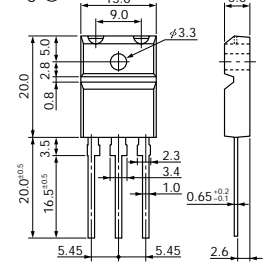
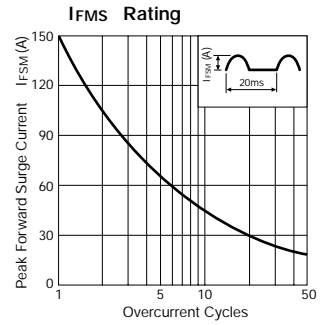
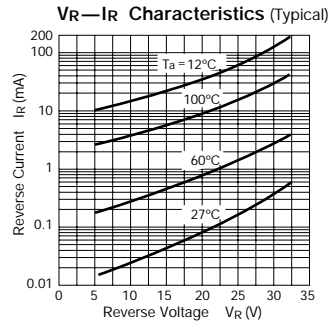
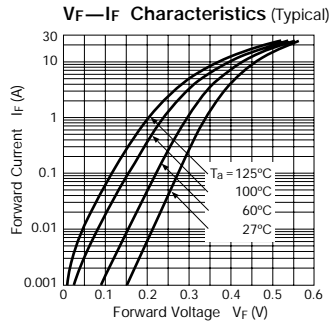
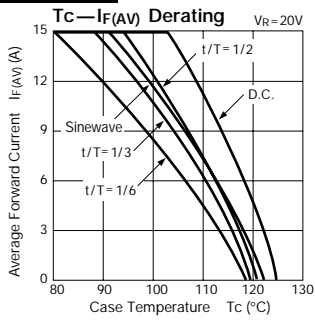

Fig. Ⓒ



FMB-22H



FMB-32

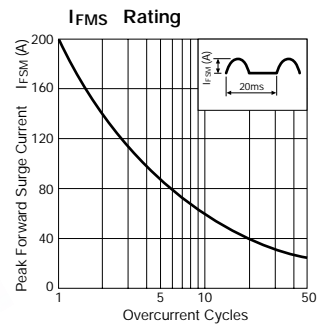
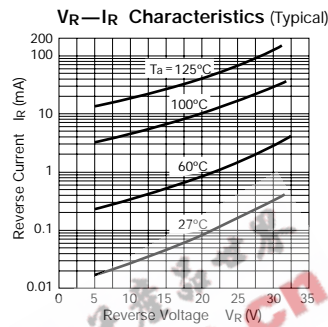
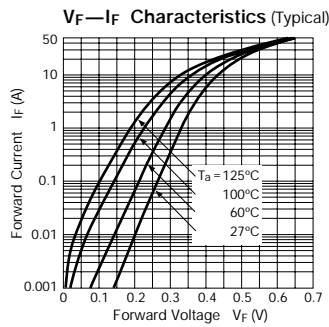
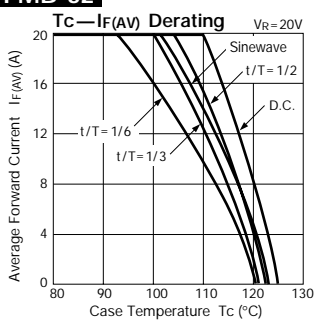

FMB-32M

