

## For Liquid/Gas Filter, Differential Pressure Pumping, Orifice for Mass Spectroscopy, Light/X-ray Collimator

### FEATURES

- Uniform capillary diameter
- Possible to make liquid laminar flow
- Possible to give charge particle or molecule directivity
- Good mechanical strength
- High heat resistance (430°C Max.)
- Possible to collimate light

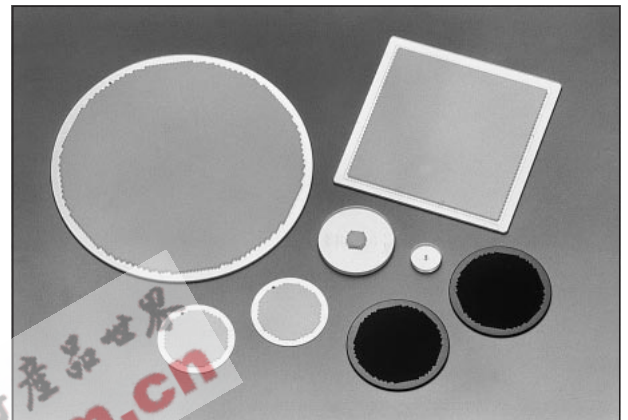

Capillary plate is a circular or rectangular plate where glass capillaries of channel diameter 6 to 25  $\mu\text{m}$  are regularly bundled in parallel. Depending on its channel diameter or thickness, capillary plate can control flow speed or flow quantity of gas or liquid and can be used as a gas filter or a window material for differential pressure pumping. Besides it can give directivity to charged particle and molecule, and can be also used as a light or X-ray collimator. Our capillary plate has as high as over 55 % open area ratio.

### DIMENSIONAL OUTLINES AND SPECIFICATIONS (Unit:mm)

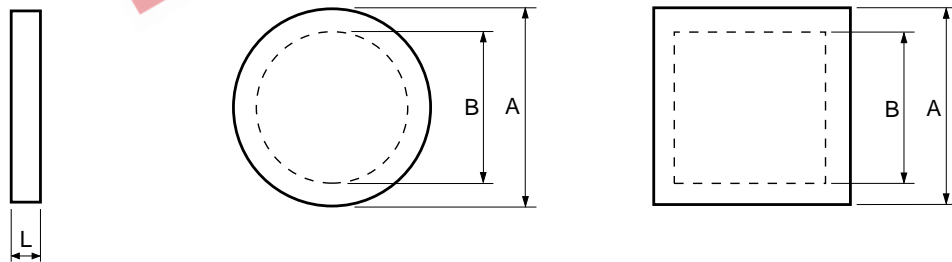

TMCPA0070EA

Type No.	Size A	Effective Area B (mm)	Channel Diameter D ( $\mu\text{m}$ )	Thickness L (mm)	L/D
J5022-01	$\phi$ 5	$\phi$ 0.8	12	1.0	83
J5022-09	$\phi$ 25	$\phi$ 20	6	1.0	167
J5022-11	$\phi$ 25	$\phi$ 20	10	0.4	40
J5022-16	$\phi$ 33	$\phi$ 27	10	1.0	100
J5022-21	$\phi$ 87	$\phi$ 77	25	1.0	40
J5022-19	60 $\times$ 60	53 $\times$ 53	20	1.0	50