

# C&K KM Series Subminiature Pushbutton Switches

## Features/Benefits

- **Reliable contact design**
- **Available with pretravel and overtravel**
- **Extended overtravel option**
- **RoHS compliant**

## Typical Applications

- **Alarm systems**
- **Computers**
- **Detector switch application**



Models Available

## Specifications

**CONTACT RATING:** Q contact material (KM11, KM12 Models): 0.25 AMPS @ 125 V AC or DC (UL); (KM33 Model): 1 AMP @ 125 V AC or 28 V DC. See page A-67 for additional ratings.

**ELECTRICAL LIFE:** 10,000 actuations min. at full load.

**CONTACT RESISTANCE:** Below 30 mΩ typ. initial @ 2-4 V DC, 100 mA, for both silver and gold plated contacts.

**INSULATION RESISTANCE:** 10<sup>9</sup>Ω min.

**DIELECTRIC STRENGTH:** 1,000 Vrms min. @ sea level.

**OPERATING TEMPERATURE:** -30°C to 85°C.

**CAP INSTALLATION FORCE:** 10 lbs. max. permissible.

**NOTE:** Any models supplied with Q or B contact material are RoHS compliant. For the latest information regarding RoHS compliance, please go to: [www.ittcannon.com/rohs](http://www.ittcannon.com/rohs).

**NOTE:** Specifications and materials listed above are for switches with standard options. For information on specific and custom switches, consult Customer Service Center.

## Materials

**HOUSING & BUSHING:** 6/6 nylon (UL94V-2), black.

**ACTUATOR:** 6/6 nylon (UL 94V-2), natural. Internal o-ring seal, available on KM11 & KM33 models.

**MOVABLE CONTACT:** B contact material: Bronze or copper, with gold plate over nickel plate. See page A-67 for additional contact materials.

**STATIONARY CONTACTS & TERMINALS:** B contact material: Copper, with gold plate over nickel plate. See page A-67 for additional contact materials.

**RETURN SPRING:** Music wire, phosphor coated.

**MOUNTING NUT:** Brass, nickel plated.

**TERMINAL SEAL:** Epoxy.

## Build-A-Switch

To order, simply select desired option from each category and place in the appropriate box. Available options are shown and described on pages A-66 and A-68. For additional options not shown in catalog, consult Customer Service Center.

<p><b>Switch Function</b></p> <p><b>KM12</b> On-Mom., SPDT</p> <p><b>KM11</b> Off-Mom., SPST, N.O.</p> <p><b>KM33</b> On-Mom., SPST, N.C.</p>	<p><b>Actuator</b></p> <p><b>02</b> .398" high, .122" dia. KM12</p> <p><b>01</b> .122" dia. KM11, Stepped, .108" dia. KM33</p>	<p><b>Bushing/Mounting Style</b></p> <p><b>A</b> Right angle</p> <p><b>RR</b> 1/4-40 thread, .225" high</p>	<p><b>Terminations</b></p> <p><b>05</b> .110" quick connect</p> <p><b>08</b> Right angle, PC thru-hole</p> <p><b>02</b> PC Thru-hole</p> <p><b>WC</b> Wire lead</p>	<p><b>Contact Material</b></p> <p><b>B</b> Gold</p> <p><b>Q</b> Silver</p>	<p><b>Seal</b></p> <p><b>NONE</b> No seal</p> <p><b>E</b> Epoxy</p>
---	--	---	---	--	---



Dimensions are shown: Inches (mm)  
Specifications and dimensions subject to change



# C&K KM Series Subminiature Pushbutton Switches

## SWITCH FUNCTION

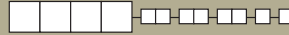

A

Pushbutton

NO. POLES	MODEL NO.	SWITCH FUNCTION		CONNECTED TERMINALS		SCHEMATIC
		POS. 1	POS. 2	POS. 1	POS. 2	
SP	<b>KM11</b>	OFF	MOM.	OPEN	2-1	SPST N.O.
	<b>KM33</b>	ON	MOM.	2-1	OPEN	SPST N.C.
<b>SPST</b> <p>Part number shown: KM1101RR05BE</p>						
SP	<b>KM12</b>	ON	MOM.	2-1	4-3	SPDT
<b>SPDT</b> <p>Part number shown: KM1202A08BE</p>						

## ACTUATOR



**02** .398" HIGH, .122" DIA.

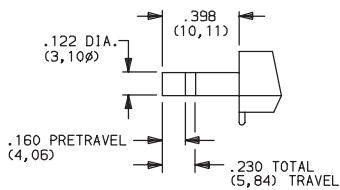

KM12 models only.

**01** .122" DIA.

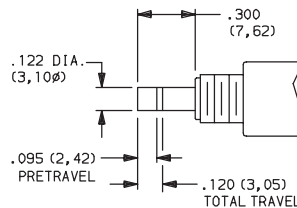

KM11 models only.

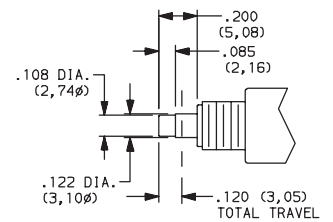

KM33 models only.

NOTE: Caps available for plunger options, see page A-68.



Dimensions are shown: Inches (mm)  
Specifications and dimensions subject to change



# C&K KM Series Subminiature Pushbutton Switches

## BUSHING/ MOUNTING STYLE

**A** RIGHT ANGLE

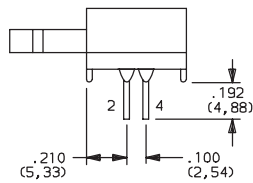

KM12 models only.

**RR** 1/4-40 THREAD, .225" HIGH

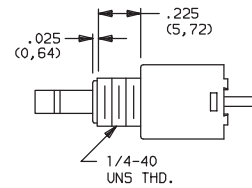

KM11 & KM33 models only.

### PANEL MOUNTING

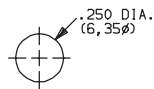

KM11 & KM33 models.

### PC MOUNTING

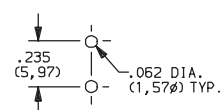

KM11 models only.

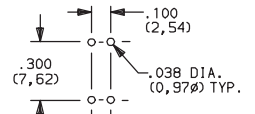

KM12 models only.

## TERMINATIONS

**05** .110" QUICK CONNECT

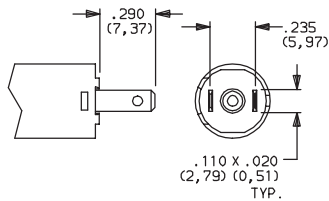

**08** RIGHT ANGLE, PC THRU-HOLE

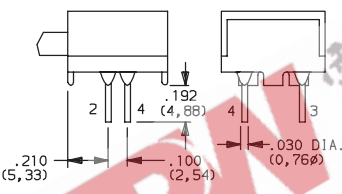

KM12 models only.

**02** PC THRU-HOLE

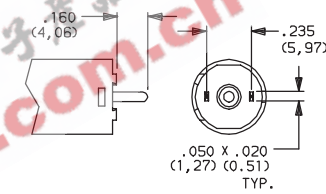

KM11 models only.

**WC** WIRE LEAD

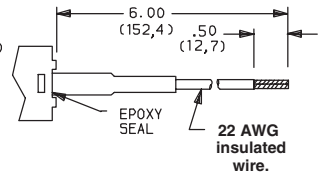

UL style 1015.

## CONTACT MATERIAL

OPTION CODE	RoHS COMPLIANT *	RoHS COMPATIBLE *	CONTACT AND TERMINAL MATERIAL	RATINGS	
				LOW LEVEL/DRY CIRCUIT	POWER
<b>B</b>	YES	YES	GOLD <sup>1</sup>	0.4 VA MAX. @ 20 V AC OR DC MAX.	
<b>Q</b>	YES	YES	SILVER <sup>2</sup>		0.25 AMPS @ 125 V AC OR DC (KM11, KM12) (UL) 1 AMP @ 125 V AC OR 28 V DC (KM33).

\* Note: See Technical Data section of this catalog for RoHS compliant and compatible definitions and specifications.

<sup>1</sup> STATIONARY CONTACTS & TERMINALS: Copper, with gold plate over nickel plate. MOVABLE CONTACT: Phosphor bronze or beryllium copper, with gold plate over nickel plate.

<sup>2</sup> STATIONARY CONTACTS & TERMINALS: Copper, silver plated (standard with all termination options). MOVABLE CONTACT: Phosphor bronze or beryllium copper, silver plated.

<sup>3</sup> STATIONARY CONTACTS & TERMINALS: Copper, with gold plate over nickel plate over silver plate. MOVABLE CONTACT: Phosphor bronze or beryllium copper, with gold plate over nickel plate over silver plate.

**NOTE:** Any models supplied with Q or B contact material are RoHS compliant. For the latest information regarding RoHS compliance, please go to: [www.ittcannon.com/rohs](http://www.ittcannon.com/rohs).

KM11, KM12 models  when ordered with 'Q' contact material.

## SEAL

**NONE** NO SEAL

**E** EPOXY SEAL

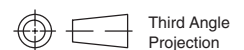
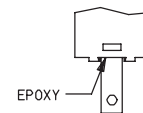

Dimensions are shown: Inches (mm)  
Specifications and dimensions subject to change





# C&K KM Series Subminiature Pushbutton Switches

## AVAILABLE HARDWARE

Pushbutton  
A

Cap, KM33 models

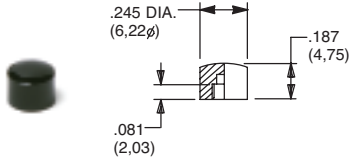

**PART NO.**

- 785101000** WHITE
- 785102000** BLACK
- 785103000** RED

Material: Nylon  
Finish: Gloss

Cap, KM11 models

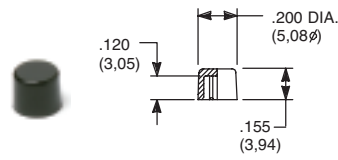

**PART NO.**

- 708901000** WHITE
- 708902000** BLACK
- 708903000** RED

Material: Nylon  
Finish: Gloss

Cap, KM11 models

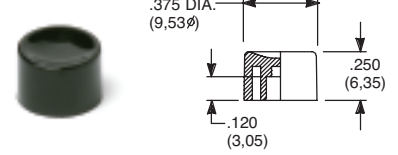

**PART NO.**

- 752701000** WHITE
- 752702000** BLACK
- 752703000** RED

Material: Nylon  
Finish: Gloss

Cap, KM11 models

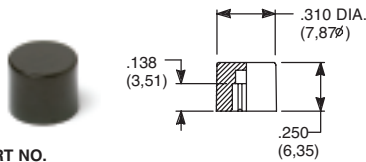

**PART NO.**

- 801801000** WHITE
- 801802000** BLACK
- 801803000** RED

Material: Nylon  
Finish: Gloss

Cap, KM11 models

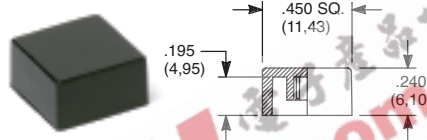

**PART NO.**

- 484601000** WHITE
- 484602000** BLACK
- 484603000** RED

Material: Nylon  
Finish: Gloss

**PART NO.**

- 798201000** WHITE
- 798202263** BLACK
- 798203000** RED

Material: Nylon  
Finish: Matte

**NOTE:** Other cap colors available, consult Customer Service Center.

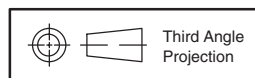

Dimensions are shown: Inches (mm)  
Specifications and dimensions subject to change