

C&K KM Series Subminiature Pushbutton Switches

Features/Benefits

- **Reliable contact design**
- **Available with pretravel and overtravel**
- **Extended overtravel option**
- **RoHS compliant**

Typical Applications

- **Alarm systems**
- **Computers**
- **Detector switch application**



Models Available

Specifications

CONTACT RATING: Q contact material (KM11, KM12 Models): 0.25 AMPS @ 125 V AC or DC (UL); (KM33 Model): 1 AMP @ 125 V AC or 28 V DC. See page A-67 for additional ratings.

ELECTRICAL LIFE: 10,000 actuations min. at full load.

CONTACT RESISTANCE: Below 30 mΩ typ. initial @ 2-4 V DC, 100 mA, for both silver and gold plated contacts.

INSULATION RESISTANCE: 10⁹Ω min.

DIELECTRIC STRENGTH: 1,000 Vrms min. @ sea level.

OPERATING TEMPERATURE: -30°C to 85°C.

CAP INSTALLATION FORCE: 10 lbs. max. permissible.

NOTE: Any models supplied with Q or B contact material are RoHS compliant. For the latest information regarding RoHS compliance, please go to: www.ittcannon.com/rohs.

NOTE: Specifications and materials listed above are for switches with standard options. For information on specific and custom switches, consult Customer Service Center.

Materials

HOUSING & BUSHING: 6/6 nylon (UL94V-2), black.

ACTUATOR: 6/6 nylon (UL 94V-2), natural. Internal o-ring seal, available on KM11 & KM33 models.

MOVABLE CONTACT: B contact material: Bronze or copper, with gold plate over nickel plate. See page A-67 for additional contact materials.

STATIONARY CONTACTS & TERMINALS: B contact material: Copper, with gold plate over nickel plate. See page A-67 for additional contact materials.

RETURN SPRING: Music wire, phosphor coated.

MOUNTING NUT: Brass, nickel plated.

TERMINAL SEAL: Epoxy.

Build-A-Switch

To order, simply select desired option from each category and place in the appropriate box. Available options are shown and described on pages A-66 and A-68. For additional options not shown in catalog, consult Customer Service Center.

Switch Function

KM12 On-Mom., SPDT

KM11 Off-Mom., SPST, N.O.

KM33 On-Mom., SPST, N.C.

Actuator

02 .398" high, .122" dia. KM12

01 .122" dia. KM11, Stepped, .108" dia. KM33

Bushing/Mounting Style

A Right angle

RR 1/4-40 thread, .225" high

Terminations

05 .110" quick connect

08 Right angle, PC thru-hole

02 PC Thru-hole

WC Wire lead

Contact Material

B Gold

Q Silver

Seal

NONE No seal

E Epoxy



Dimensions are shown: Inches (mm)
Specifications and dimensions subject to change



C&K KM Series Subminiature Pushbutton Switches

SWITCH FUNCTION

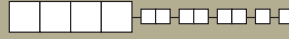

A

Pushbutton

| NO. POLES | MODEL NO. | SWITCH FUNCTION | | CONNECTED TERMINALS | | SCHEMATIC |
|--|-------------|-----------------|--------|---------------------|--------|-----------|
| | | POS. 1 | POS. 2 | POS. 1 | POS. 2 | |
| SP | KM11 | OFF | MOM. | OPEN | 2-1 | SPST N.O. |
| | KM33 | ON | MOM. | 2-1 | OPEN | SPST N.C. |
| SPST <p>Part number shown: KM1101RR05BE</p> | | | | | | |
| SP | KM12 | ON | MOM. | 2-1 | 4-3 | SPDT |
| SPDT <p>Part number shown: KM1202A08BE</p> | | | | | | |

ACTUATOR

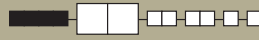

02 .398" HIGH, .122" DIA.

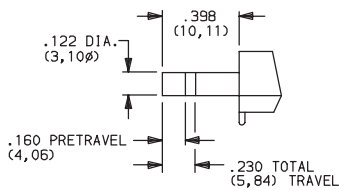

KM12 models only.

01 .122" DIA.

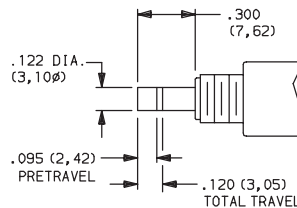

KM11 models only.

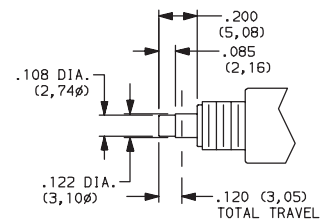

KM33 models only.

NOTE: Caps available for plunger options, see page A-68.



Dimensions are shown: Inches (mm)
Specifications and dimensions subject to change



C&K KM Series Subminiature Pushbutton Switches

BUSHING/ MOUNTING STYLE

A RIGHT ANGLE

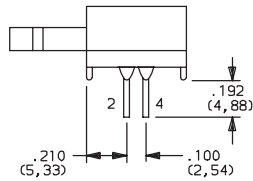

KM12 models only.

RR 1/4-40 THREAD, .225" HIGH

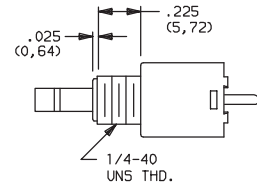

KM11 & KM33 models only.

PANEL MOUNTING

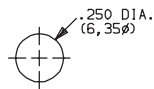

KM11 & KM33 models.

PC MOUNTING

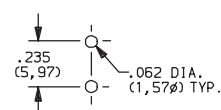

KM11 models only.

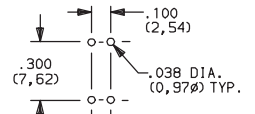

KM12 models only.

TERMINATIONS

05 .110" QUICK CONNECT

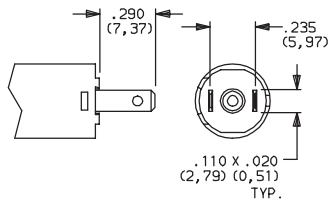

08 RIGHT ANGLE, PC THRU-HOLE

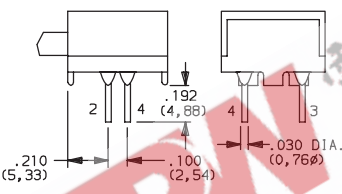

KM12 models only.

02 PC THRU-HOLE

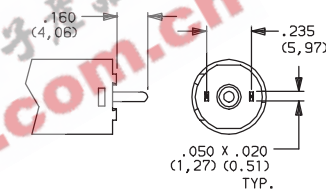

KM11 models only.

WC WIRE LEAD

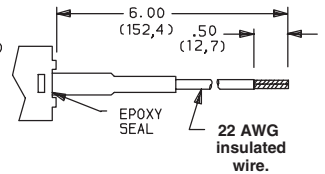

UL style 1015.

CONTACT MATERIAL

| OPTION CODE | RoHS COMPLIANT * | RoHS COMPATIBLE * | CONTACT AND TERMINAL MATERIAL | RATINGS | |
|-------------|------------------|-------------------|-------------------------------|---|-------|
| | | | | LOW LEVEL/DRY CIRCUIT | POWER |
| B | YES | YES | GOLD ¹ | 0.4 VA MAX. @ 20 V AC OR DC MAX. | |
| Q | YES | YES | SILVER ² | 0.25 AMPS @ 125 V AC OR DC (KM11, KM12) (UL) 1 AMP @ 125 V AC OR 28 V DC (KM33). | |

* Note: See Technical Data section of this catalog for RoHS compliant and compatible definitions and specifications.

¹ STATIONARY CONTACTS & TERMINALS: Copper, with gold plate over nickel plate. MOVABLE CONTACT: Phosphor bronze or beryllium copper, with gold plate over nickel plate.

² STATIONARY CONTACTS & TERMINALS: Copper, silver plated (standard with all termination options). MOVABLE CONTACT: Phosphor bronze or beryllium copper, silver plated.

³ STATIONARY CONTACTS & TERMINALS: Copper, with gold plate over nickel plate over silver plate. MOVABLE CONTACT: Phosphor bronze or beryllium copper, with gold plate over nickel plate over silver plate.

NOTE: Any models supplied with Q or B contact material are RoHS compliant. For the latest information regarding RoHS compliance, please go to: www.ittcannon.com/rohs.

KM11, KM12 models  when ordered with 'Q' contact material.

SEAL

NONE NO SEAL

E EPOXY SEAL

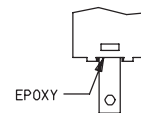

Dimensions are shown: Inches (mm)
Specifications and dimensions subject to change





C&K KM Series Subminiature Pushbutton Switches

AVAILABLE HARDWARE

A
Pushbutton

Cap, KM33 models

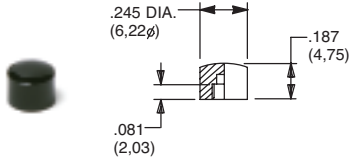

PART NO.

- 785101000** WHITE
- 785102000** BLACK
- 785103000** RED

Material: Nylon
Finish: Gloss

Cap, KM11 models

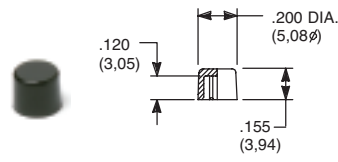

PART NO.

- 708901000** WHITE
- 708902000** BLACK
- 708903000** RED

Material: Nylon
Finish: Gloss

Cap, KM11 models

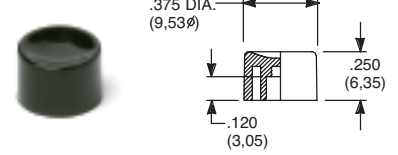

PART NO.

- 752701000** WHITE
- 752702000** BLACK
- 752703000** RED

Material: Nylon
Finish: Gloss

Cap, KM11 models

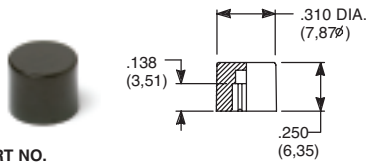

PART NO.

- 801801000** WHITE
- 801802000** BLACK
- 801803000** RED

Material: Nylon
Finish: Gloss

Cap, KM11 models

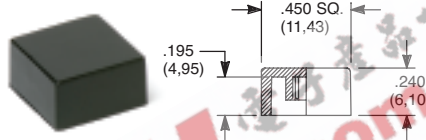

PART NO.

- 484601000** WHITE
- 484602000** BLACK
- 484603000** RED

Material: Nylon
Finish: Gloss

PART NO.

- 798201000** WHITE
- 798202263** BLACK
- 798203000** RED

Material: Nylon
Finish: Matte

NOTE: Other cap colors available, consult Customer Service Center.

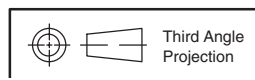

Dimensions are shown: Inches (mm)
Specifications and dimensions subject to change