

OM7621NM
OM7622NM

OM7623NM
OM7624NM

SURFACE MOUNT LOW DROPOUT POSITIVE ADJUSTABLE REGULATORS

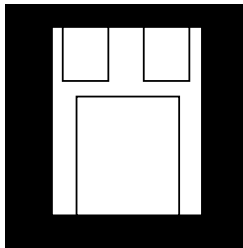

Three Terminal Adjustable Low Dropout
7.5A, 5A, 3A, 1.5A Positive Voltage Regulators

FEATURES

- Surface Mount Hermetic Package
- Operates Down to 1V Dropout, 1.5V @ Max. Current
- .015% Typical Line Regulation
- .01% Typical Load Regulation
- 1% Reference Voltage
- Electrically Equivalent to LT1083, 84, 85 and 86
- Available Hi-Rel Screened

DESCRIPTION

These three terminal positive adjustable voltage regulators in surface mount package are designed to provide 7.5A, 5A, 3A, and 1.5A with higher efficiency than conventional voltage regulators. The devices are designed to operate to 1 Volt input to output differential and the dropout voltage is specified as a function of load current. These devices are ideally suited for Military applications where surface mount, small size, hermeticity and high reliability are required.

ABSOLUTE MAXIMUM RATINGS

Input Voltage.....	35 V
Operating Junction Temperature Range	- 55°C to + 150°C
Storage Temperature.....	- 55°C to + 150°C
Output Current - OM7621NM.....	8.0 A
OM7622NM.....	5.5 A
OM7623NM.....	3.2 A
OM7624NM.....	1.5 A

PIN CONNECTION

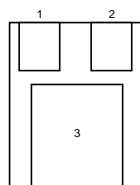

Pin 1: V_{IN}
Pin 2: Adjust
Pin 3: V_{OUT}

MECHANICAL OUTLINE

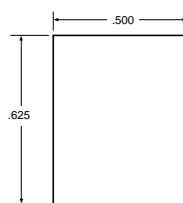

TOP VIEW

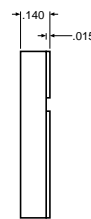

SIDE VIEW

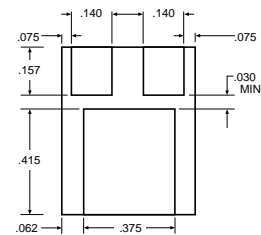

BOTTOM VIEW

3.5

OM7621NM - OM7624NM

ELECTRICAL CHARACTERISTICS $T_j = -55^{\circ}\text{C}$ to $+125^{\circ}\text{C}$

Parameter	Conditions	Min.	Typ.	Max.	Units
Reference Voltage	$I_{OUT} = 10\text{ mA}$, $T_j = 25^{\circ}\text{C}$ $(V_{IN} - V_{OUT}) = 3\text{ V}$	1.238		1.262	V
	10mA I_{OUT} $I_{FULL\ LOAD}$ 1.5 V $(V_{IN} - V_{OUT})$ 25 V (Note 3)	• 1.220		1.270	V
Line Regulation	$I_{LOAD} = 10\text{ mA}$, 1.5 V $(V_{IN} - V_{OUT})$ 15 V, $T_j = 25^{\circ}\text{C}$			0.25	%
	15 V $(V_{IN} - V_{OUT})$ 35 V (Notes 1 & 2)	•		0.55	%
Load Regulation	$(V_{IN} - V_{OUT}) = 3\text{ V}$ 10 mA I_{OUT} $I_{FULL\ LOAD}$ $T_j = 25^{\circ}\text{C}$ (Notes 1, 2, & 3)			0.9	%
		•		1.1	%
Dropout Voltage	$V_{REF} = 1\%$, $I_{OUT} = I_{FULL\ LOAD}$	•		1.5	V
Current Limit	OM7621NM $(V_{IN} - V_{OUT}) = 5\text{ V}$ $(V_{IN} - V_{OUT}) = 25\text{ V}$	• 8.0			A
		• 0.4			A
	OM7622NM $(V_{IN} - V_{OUT}) = 5\text{ V}$ $(V_{IN} - V_{OUT}) = 25\text{ V}$	• 5.5			A
		• 0.3			A
	OM7623NM $(V_{IN} - V_{OUT}) = 5\text{ V}$ $(V_{IN} - V_{OUT}) = 25\text{ V}$	• 3.2			A
		• 0.2			A
	OM7624NM $(V_{IN} - V_{OUT}) = 5\text{ V}$ $(V_{IN} - V_{OUT}) = 25\text{ V}$	• 1.5			A
		• 0.08			A
Minimum Load Current	$(V_{IN} - V_{OUT}) = 25\text{ V}$	•		20	mA
Thermal Regulation	$T_A = 25^{\circ}\text{C}$, 30 ms pulse			0.01	%/W
				.015	%/W
				0.02	%/W
				0.05	%/W
Ripple Rejection	$f = 120\text{ Hz}$ $C_{ADJ} = 25\text{ }\mu\text{F Tantalum}$ $I_{OUT} = I_{FULL\ LOAD}$ $(V_{IN} - V_{OUT}) = 3\text{ V}$	60			dB
Adjust Pin Current	$T_j = 25^{\circ}\text{C}$			80	μA
Adjust Pin Current Change	10mA I_{OUT} $I_{FULL\ LOAD}$ 1.5 V $(V_{IN} - V_{OUT})$ 25 V	•		5	μA
Temperature Stability	-55°C T_j $+150^{\circ}\text{C}$			1.5	%
Long Term Stability	$T_A = 125^{\circ}\text{C}$, 1000 Hrs.			1	%
Thermal Resistance	Junction-to-Case			2.1	$^{\circ}\text{C/W}$
	OM7621NM			3.1	$^{\circ}\text{C/W}$
	OM7622NM			4.1	$^{\circ}\text{C/W}$
	OM7624NM			5.3	$^{\circ}\text{C/W}$
Lead Temperature	5 Seconds at Case		225		$^{\circ}\text{C}$

Note 1: Load and line regulation are measured at a constant junction temperature by low duty cycle pulse testing.
Note 2: Line and load regulation are guaranteed up to the maximum power dissipation (OM7621/60W, OM7622/45W, OM7623/30W, OM7624/15W). Power dissipation is determined by the input/output differential and the output current. Guaranteed maximum power dissipation will not be available over the full input/output voltage range.
Note 3: $I_{FULL\ LOAD}$ curve is defined as the minimum value of current limit as a function of input to output voltage. Note that power dissipation is only achievable over a limited range of input to output voltage.
Note 4: Dropout voltage is specified over the full output current range of the device.
 The • denotes the specifications which apply over the full operating temperature range.