

# Silicon Power Rectifier S/R20 Series

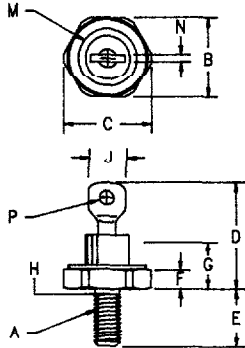

- Notes:
1. 10-32 UNF3A
  2. Full threads within 2 1/2 threads
  3. Standard Polarity: Stud Is Cathode  
Reverse Polarity: Stud is Anode

Dim.	Inches		Millimeter		Notes
	Minimum	Maximum	Minimum	Maximum	
A	---	---	---	---	1
B	.424	.437	10.77	11.10	
C	---	.505	---	12.82	
D	.600	.800	15.24	20.32	
E	.422	.453	10.72	11.50	
F	.075	.175	1.91	4.44	
G	---	.405	---	10.29	
H	.163	.189	4.15	4.80	2
J	---	.310	---	7.87	
M	---	.350	---	8.89	Dia
N	.020	.065	.510	1.65	
P	.070	.100	1.78	2.54	Dia

## DO203AA (DO4)

Microsemi Catalog Number Standard	JEDEC Numbers	Peak Reverse Voltage	
*S2020		200V	<ul style="list-style-type: none"> <li>• Glass Passivated Die</li> <li>• Low Forward Voltage</li> <li>• 200A Surge Rating</li> <li>• Glass to metal construction</li> <li>• <math>V_{RRM}</math> to 1200V</li> <li>• Excellent reliability</li> </ul>
*S2040	1N1126, 1N1346, 1N1346A, 1N1345B	400V	
*S2060	1N1128, 1N1348, 1N1348A, 1N1348B, 1N1587, 1N1616, 1N2238, 1N2497	600V	
*S2080	1N2240	800V	
*S20100		1000V	
*S20120		1200V	

\*Change S to R in part number for Reverse Polarity

### Electrical Characteristics

Average forward current	IF(AV) 16 Amps	$T_c = 153^\circ\text{C}$ , half sine wave, $R_{\theta JC} = 2.5^\circ\text{C/W}$
Maximum surge current	IFSM 200 Amps	8.3ms, half sine, $T_J = 200^\circ\text{C}$
Max $I^2t$ for fusing	$I^2t$ 165 A <sup>2</sup> s	
Max peak forward voltage	V <sub>FM</sub> 1.3 Volts	IFM = 30A; $T_J = 25^\circ\text{C}$ *
Max peak reverse current	IRM 10 $\mu\text{A}$	V <sub>RRM</sub> , $T_J = 25^\circ\text{C}$
Max peak reverse current	IRM 1.0 mA	V <sub>RRM</sub> , $T_J = 150^\circ\text{C}$
Max Recommended Operating Frequency	10kHz	

\*Pulse test: Pulse width 300  $\mu\text{sec}$ . Duty cycle 2%

### Thermal and Mechanical Characteristics

Storage temperature range	T <sub>STG</sub>	-65°C to 200°C
Operating junction temp range	T <sub>J</sub>	-65°C to 200°C
Maximum thermal resistance	R <sub><math>\theta</math>JC</sub>	2.5°C/W Junction to Case
Typical thermal resistance	R <sub><math>\theta</math>C</sub>	2.0°C/W Junction to Case
Mounting torque		30 inch pounds maximum
Weight		.16 ounces (5.0 grams) typical

**Microsemi Corp.**  
**Colorado**

# S/R20

Figure 1  
Typical Forward Characteristics

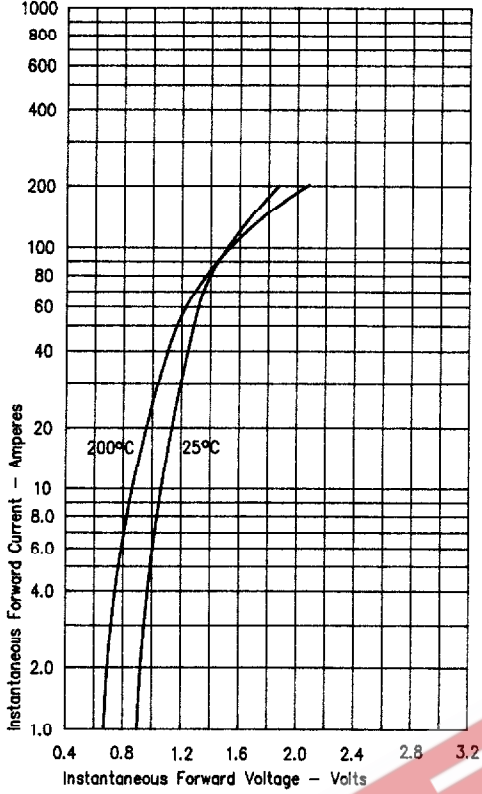

Figure 3  
Forward Current Derating

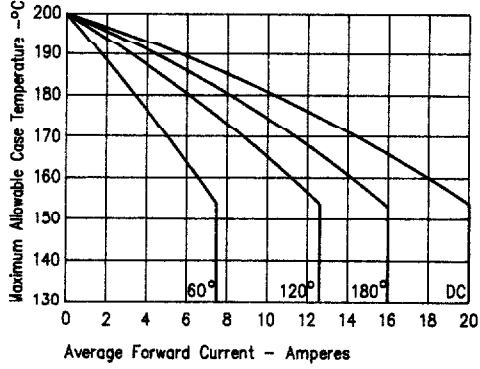

Figure 4  
Maximum Forward Power Dissipation

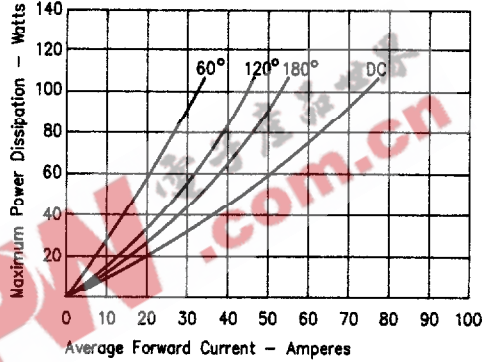

Figure 2  
Typical Reverse Characteristics

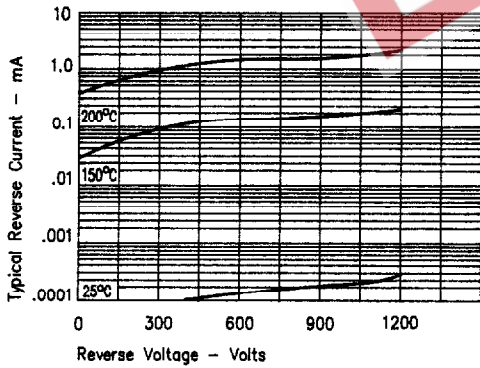
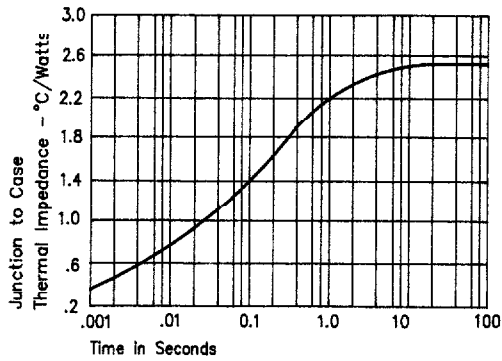
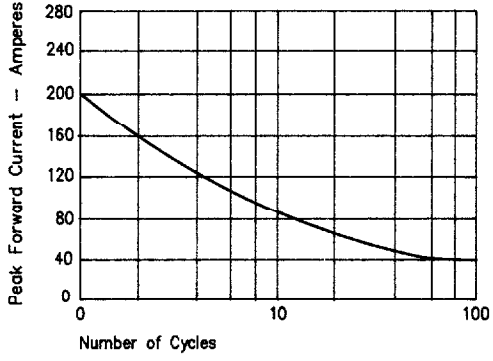

Figure 5  
Transient Thermal Impedance



# S/R20

Figure 6  
Maximum Nonrepetitive Surge Current



EEPW 电子产品世界  
.com.cn