

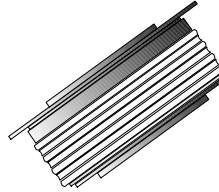

Transys
Electronics
LIMITED

SD1100C(*)L Series
STANDARD RECOVERY DIODE
 $I_{F(AV)} = 1170 \text{ A}$,



Case: B-Puk

MAXIMUM RATINGS (T _j = 25 °C unless stated otherwise)											
Parameter	Symbol	SD1100C 04L	SD1100C 08L	SD1100C 12L	SD1100C 16L	SD1100C 20L	SD1100C 25L	SD1100C 30L	SD1100C 32L	Unit	
Repetitive Peak Reverse Voltage	V _{RRM}	400	800	1200	1600	2000	2500	3000	3200	Volt	
Maximum Average On-State Current	I _{F(AV)}	1170 at TC=55°C					910 at TC=55°C				Amp
Peak Forward Surge Current	I _{FSM}	13600					11000				Amp
Maximum I ² T for Fusing	I ² T	772					503				A ² /S
Maximum Storage Temperature Range	T _(STG)	-55 to +200					-55 to +200				°C
Maximum Junction Temperature Range	T _j	-40 to +180					-40 to +150				°C

ELECTRICAL CHARACTERISTICS at 25 °C Maximum Unless Stated				Value			Unit
Parameter	Symbol	Condition	Min	Typ	Max		
Maximum Forward Voltage	V _{FM}	I _{pk} = 1500 Amps 400-2000V			1.31	Volt	
Maximum Forward Voltage	V _{FM}	I _{pk} = 1500 Amps 2500-3200V			1.44	Volt	
Repetitive Peak Off- State Current at TC=175°C	I _{RRM}	V _R = V _{RRM}			15.0	mA	
Thermal Resistance (Junction toHeatsink)	R _{TH (J-h)}				0.11	°C/W	
Mounting Torque	M _T				9800	NM	
Weight	Wt				250	grms	

Mechanical Dimensions

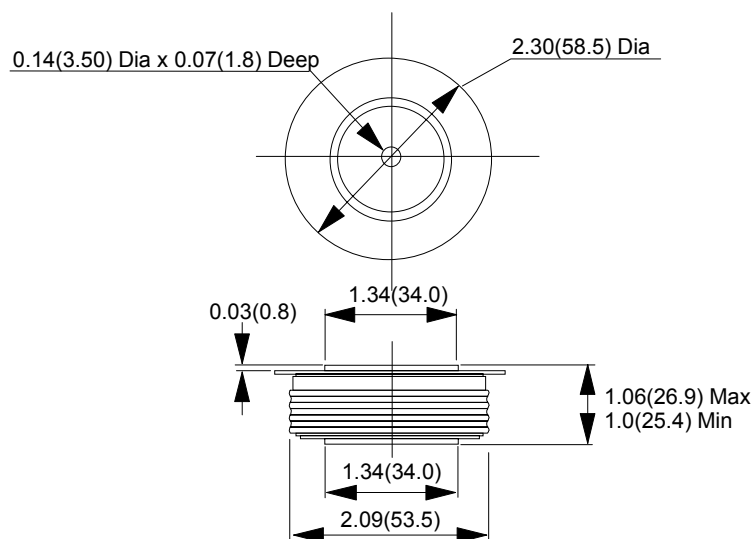

All Dimensions in Inches (Millimeters)
 Third Angle Projection