

Series

DC1390R DC1390

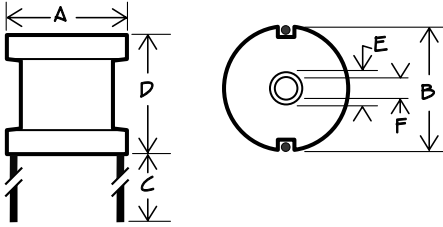

High Current Power Line Chokes

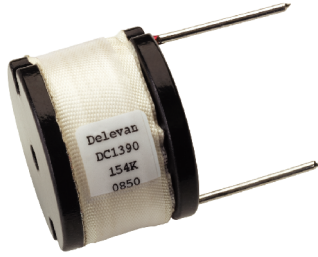

Physical Parameters

	Inches	Millimeters
A	1.338 to 1.418	34.0 to 36.0
B	See Characteristics Table	
C	0.750 Min.	19.05 Min.
D	0.925 to 1.043	23.5 to 26.5
E	0.189 to 0.191	4.80 to 4.86
F	0.189 to 0.191	4.80 to 4.86
G	See Characteristics Table	

Leads Tinned to within 1/16" of Body

Inductance Measured @ 1 kHz within 0 A DC on a GenRad 1658A Digibridge, or equivalent

Mechanical Configuration Center hole allows for mechanical mounting; insulated bobbins

Operating Temperature

-55°C to +125°C;
-55°C to +80°C @ full rated current

Incremental Current Minimum current which causes a 5% maximum decrease in Inductance

Power Dissipation at 80°C 3.30 Watts Max.

Dielectric Withstanding Voltage 1000 V RMS Min.

Marking Parts printed with DELEVAN and API Part Number

Packaging Bulk only

	DASH NUMBER*	NOMINAL INDUCTANCE (μH)	TOLERANCE	DC RESISTANCE MAX. (OHMS) @ 25°C	CURRENT RATING MAXIMUM (A DC)	INCREMENTAL CURRENT (A DC)	DIMENSION B (Inches, Reference)	LEAD DIAMETER (Inches, Reference)
SERIES DC1390 FERRITE CORE								
-153K	15.0	±10%	0.006	19.9	33.3	1.12	0.082	
-183K	18.0	±10%	0.008	17.3	30.4	1.20	0.082	
-223K	22.0	±10%	0.009	16.3	28.0	1.20	0.082	
-273K	27.0	±10%	0.010	15.4	25.9	1.20	0.082	
-333K	33.0	±10%	0.011	14.7	22.6	1.20	0.082	
-393K	39.0	±10%	0.012	14.1	21.2	1.20	0.082	
-473K	47.0	±10%	0.018	11.5	20.0	1.20	0.073	
-563K	56.0	±10%	0.019	11.2	27.9	1.17	0.073	
-683K	68.0	±10%	0.021	10.7	16.3	1.17	0.065	
-823K	82.0	±10%	0.023	10.2	14.9	1.22	0.065	
-104K	100	±10%	0.025	9.76	13.2	1.22	0.065	
-124K	120	±10%	0.028	9.23	12.3	1.22	0.065	
-154K	150	±10%	0.040	7.72	10.8	1.22	0.058	
-184K	180	±10%	0.045	7.28	9.86	1.19	0.058	
-224K	220	±10%	0.050	6.90	9.09	1.19	0.058	
-274K	270	±10%	0.056	6.52	8.05	1.25	0.058	
-334K	330	±10%	0.074	5.67	7.37	1.25	0.051	
-394K	390	±10%	0.082	5.39	6.80	1.22	0.051	
-474K	470	±10%	0.114	4.57	6.20	1.22	0.046	
-564K	560	±10%	0.125	4.37	5.69	1.24	0.046	
-684K	680	±10%	0.139	4.14	5.11	1.24	0.046	
-824K	820	±10%	0.154	3.93	4.70	1.24	0.046	
-105K	1000	±10%	0.216	3.32	4.24	1.24	0.041	
-125K	1200	±10%	0.232	3.21	3.87	1.25	0.041	
-155K	1500	±10%	0.324	2.71	3.45	1.25	0.036	
-185K	1800	±10%	0.360	2.57	3.14	1.22	0.036	
-225K	2200	±10%	0.494	2.20	2.86	1.26	0.031	
-275K	2700	±10%	0.555	2.07	2.58	1.23	0.031	
-335K	3300	±10%	0.773	1.76	2.33	1.26	0.029	
-395K	3900	±10%	0.845	1.68	2.14	1.23	0.029	
*Complete part # must include series # PLUS the dash #								
For further surface finish information, refer to TECHNICAL section of this catalog.								