

Surface Mount Fuse, 7 x 2.54 mm, Time-Lag T, 125 VAC, 125 VDC



IEC 60127-4 · 125 VAC · 125 VDC · Time-Lag T



Description

- Low Breaking Capacity
- Directly solderable on printed circuit boards

Standards

- IEC 60127-4/2
- UL 248-14
- CSA C22.2 no. 248.14

Approvals

- UL File Number: E42088

Applications

- Telecom
- Industrial electronic
- Household appliances

References

- [General Product Information](#)
- [Packaging Details](#)
- Round Solder Pads Type [MSB](#)

Weblinks

- [Approvals, RoHS, CHINA-RoHS, e-Store, Distributor-Stock-Check, Accessories, Product Change Notification \(PCN\)](#)

Technical Data

Rated Voltage	63 - 125 VAC, 65 - 125 VDC
Rated Current	2 - 15 A
Breaking Capacity	50 A - 150 A
Characteristic	Time-Lag T
Mounting	PCB, SMT
Admissible Ambient Air Temp.	-55 °C to 85 °C
Climatic Category	55/085/56 acc. to IEC 60068-1
Material: Tube	Ceramic
Material: Endcaps	Tin-Plated Copper Alloy
Unit Weight	0.15 g
Storage Conditions	0 °C to 60 °C, max. 70% r.h.
Product Marking	Current

Soldering Methods	Reflow, Wave
Solderability	235 °C / 2 sec acc. to IEC 60068-2-58, Test Td
Resistance to Soldering Heat	260 °C / 10 sec acc. to IEC 60068-2-58, Test Td

Dimensions

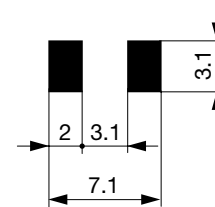
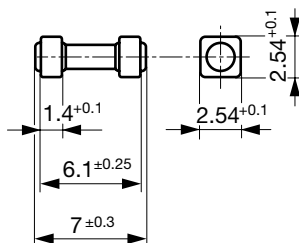
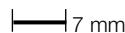

Soldering pads

Pre-Arcing Time

Rated Current In	1.1 x In min.	1.25 x In min.	2.0 x In max.	10.0 x In min.	10.0 x In max.
2 A - 8 A	-	60 min	120 s	10 ms	100 ms
10 A - 15 A	60 min	-	120 s	10 ms	100 ms

Variants

Rated Current [A]	Rated Voltage [VAC]	Rated Voltage [VDC]	Breaking Capacity	Voltage Drop 1.0 I _n typ. [mV]	Power Dissipation 1.1 I _n typ. [mW]	Power Dissipation 1.25 I _n typ. [mW]	Melting I ² t 10.0 Intyp. [A ² s]		Order Number
2	125	125	1)	85	-	300	4.1	●	7010.9513.xx
2.5	125	125	1)	82	-	360	6.9	●	7010.9514.xx
3.15	125	125	1)	79	-	440	12	●	7010.9515.xx
3.5	125	125	1)	78	-	485	15	●	7010.9516.xx
4	125	125	1)	76	-	540	21	●	7010.9517.xx
5	125	125	1)	87	-	600	29	●	7010.9518.xx
6.3	125	125	2)	85	-	810	51	●	7010.9519.xx
8	65	65	3)	81	-	1100	83	●	7010.9520.xx
10	65	65	3)	79	1000	-	140	●	7010.9521.xx
12	65	65	3)	77	1050	-	215	●	7010.9522.xx
15	65	65	3)	75	1700	-	360	●	7010.9523.xx

1) 50 A @ 125 VAC/DC

2) 63 A @ 125 VAC/DC

3) 150 A @ 65 VAC/DC

Packaging Unit

.xx = .03 Plastic Bag (100 pcs.)

.xx = .55 Blister Tape 18 cm Reel (500 pcs.)

.xx = .57 Blister Tape 18 cm Reel (1500 pcs.)

Time-Current-Curves

