

### Screw Terminal Type

Series:GNH

# Discontinued



- Features Endurance :105°C 2000 h  
High-voltage and large-capacitance
- Recommended Applications For general-purpose inverter, power supply for non-power failure, motor-control inverter

Japan  
U.S.A.

#### Specifications

|                       |  |                                    |
|-----------------------|--|------------------------------------|
| Category temp. range  | -25 to + 105°C   |                                    |
| Rated W.V. Range      | 160 to 400 V .DC   |                                    |
| Nominal Cap. Range    | 390 to 22000 μF  |                                    |
| Capacitance Tolerance | -10 to +30% (120Hz/+20°C)  |                                    |
| DC Leakage Current    | 3√CV (μA) max.after 5 minutes application of rated working voltage at +20°C<br>C:Capacitance(μF) V:W.V.(V.DC)  |                                    |
| Dissipation Factor    | Please see the attached standard products list   |                                    |
| Endurance             | After 2000 hours application of DC voltage with specified ripple current (≤ rated DC working voltage ) at +105°C, the capacitor shall meet the following limits.                         |                                    |
|                       | Capacitance change   | ±20% of initial measured value     |
|                       | D.F.   | ≤ 150 % of initial specified value |
| Shelf Life            | After storage for 1000hours at +105±2 °C with no voltage applied and then being stabilized at +20 °C, capacitors shall meet the limits specified in "Endurance".(With voltage treatment) |                                    |

#### Frequency Correction Factor for Ripple Current

| W.V.(V)  | φD(mm) | Freq.(Hz) | 50   | 60   | 120  | 300  | 360  | 1k   | 10k to |
|----------|--------|-----------|------|------|------|------|------|------|--------|
| 160, 200 | 36     | 50        | 0.80 | 0.86 | 1.00 | 1.07 | 1.08 | 1.12 | 1.17   |
|          |        | 60        | 0.86 | 0.91 | 1.00 | 1.05 | 1.06 | 1.08 | 1.10   |
|          |        | 90        | 0.90 | 0.95 | 1.00 | 1.05 | 1.06 | 1.08 | 1.10   |
| 250, 350 | 36     | 50        | 0.71 | 0.79 | 1.00 | 1.09 | 1.10 | 1.15 | 1.21   |
|          |        | 60        | 0.83 | 0.88 | 1.00 | 1.07 | 1.08 | 1.13 | 1.20   |
|          |        | 90        | 0.85 | 0.90 | 1.00 | 1.05 | 1.06 | 1.11 | 1.20   |
| 400      | 36     | 50        | 0.65 | 0.74 | 1.00 | 1.09 | 1.10 | 1.16 | 1.22   |
|          |        | 60        | 0.81 | 0.87 | 1.00 | 1.07 | 1.08 | 1.13 | 1.21   |
|          |        | 90        | 0.85 | 0.90 | 1.00 | 1.05 | 1.06 | 1.11 | 1.20   |

#### Dimensions in mm(not to scale)

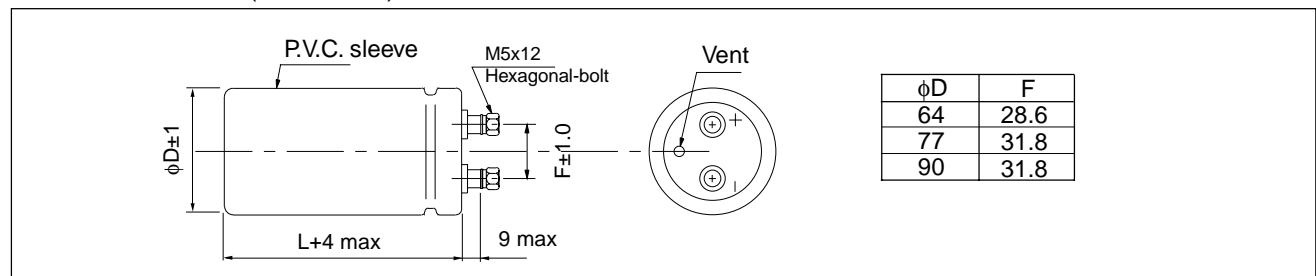

#### Mounting clamp

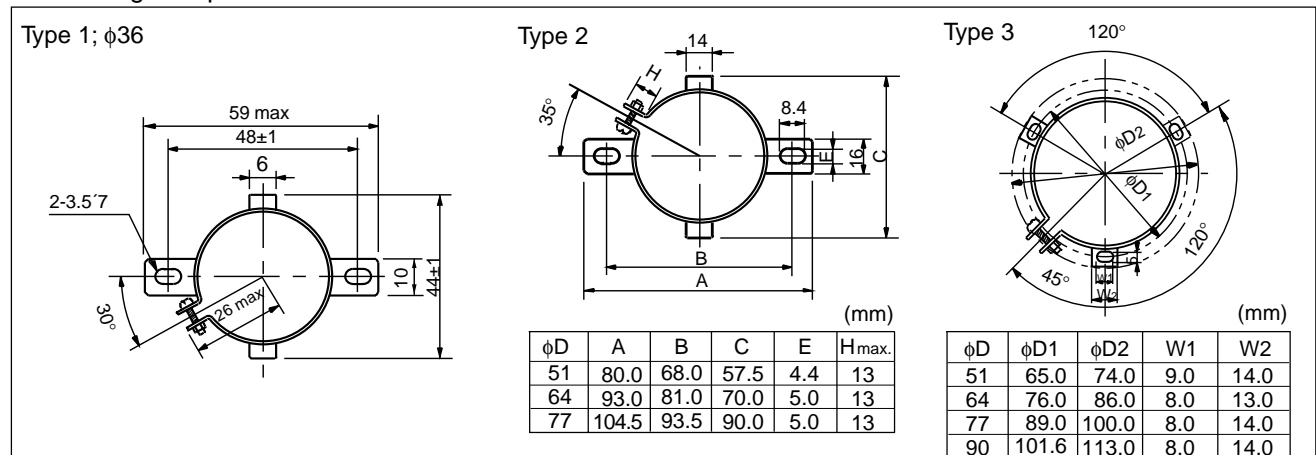

Design, Specifications are subject to change without notice. Ask factory for technical specifications before purchase and/or use. Whenever a doubt about safety arises from this product, please inform us immediately for technical consultation without fail.

Discontinued

■ Standard Products

| W.V.<br>(V) | Cap.<br>(10 to +30%)<br>(μF) | Case size    |                | Specification                                   |                            | Terminal<br>Pitch<br>(mm) | Part No.       | (:) Mounting Clamp |                 |                 |
|-------------|------------------------------|--------------|----------------|---|----------------------------|---------------------------|----------------|--------------------|-----------------|-----------------|
|             |                              | Dia.<br>(mm) | Length<br>(mm) | Ripple<br>current<br>(120Hz)<br>(+105°C)<br>(A) | D.F.<br>(120Hz)<br>(+20°C) |                           |                | No                 | 2point<br>clamp | 3point<br>clamp |
|             |                              |              |                |   |                            |                           |                |                    |                 |                 |
| 160         | 1800                         | 36           | 83             | 1.98  | 0.1                        | 13.0                      | ECEG2CG182P( ) | N                  | F               |                 |
|             | 2200                         | 36           | 103            | 2.50  | 0.1                        | 13.0                      | ECEG2CG222N( ) | N                  | F               |                 |
|             | 2700                         | 36           | 125            | 3.02  | 0.1                        | 13.0                      | ECEG2CG272M( ) | N                  | F               | F               |
|             | 3300                         | 51           | 83             | 3.63  | 0.1                        | 22.0                      | ECEG2CG332L( ) | N                  | C               | F               |
|             | 4700                         | 51           | 103            | 4.84  | 0.1                        | 22.0                      | ECEG2CG472K( ) | N                  | C               | F               |
|             | 5600                         | 51           | 125            | 5.93  | 0.1                        | 22.0                      | ECEG2CG562J( ) | N                  | C               | F               |
|             | 6800                         | 51           | 145            | 7.03  | 0.1                        | 22.0                      | ECEG2CG682H( ) | N                  | C               | F               |
|             |                              | 64           | 103            | 7.03  | 0.1                        | 28.6                      | ECEG2CG682G( ) | N                  | C               | F               |
|             | 8200                         | 64           | 125            | 9.01  | 0.1                        | 28.6                      | ECEG2CG822F( ) | N                  | C               | F               |
|             | 10000                        | 64           | 145            | 10.5  | 0.1                        | 28.6                      | ECEG2CG103E( ) | N                  | C               | F               |
|             | 12000                        | 77           | 125            | 12.5  | 0.1                        | 31.8                      | ECEG2CG123D( ) | N                  | C               | F               |
|             | 15000                        | 77           | 145            | 14.8  | 0.1                        | 31.8                      | ECEG2CG153C( ) | N                  | C               | F               |
| 22000       | 90                           | 150          | 20.0           | 0.1   | 31.8                       | ECEG2CG223A( )            | N              |                    | F               |                 |
| 200         | 1500                         | 36           | 83             | 1.81  | 0.1                        | 13.0                      | ECEG2DG152P( ) | N                  | F               |                 |
|             | 1800                         | 36           | 103            | 2.21  | 0.1                        | 13.0                      | ECEG2DG182N( ) | N                  | F               |                 |
|             | 2200                         | 36           | 125            | 2.73  | 0.1                        | 13.0                      | ECEG2DG222M( ) | N                  | F               |                 |
|             | 2700                         | 51           | 83             | 3.30  | 0.1                        | 22.0                      | ECEG2DG272L( ) | N                  | C               | F               |
|             | 3900                         | 51           | 103            | 4.95  | 0.1                        | 22.0                      | ECEG2DG392K( ) | N                  | C               | F               |
|             | 4700                         | 51           | 125            | 5.83  | 0.1                        | 22.0                      | ECEG2DG472J( ) | N                  | C               | F               |
|             | 5600                         | 51           | 145            | 6.37  | 0.1                        | 22.0                      | ECEG2DG562H( ) | N                  | C               | F               |
|             |                              | 64           | 103            | 6.37  | 0.1                        | 28.6                      | ECEG2DG562G( ) | N                  | C               | F               |
|             | 6800                         | 64           | 125            | 8.24  | 0.1                        | 28.6                      | ECEG2DG682F( ) | N                  | C               | F               |
|             | 8200                         | 64           | 145            | 9.67  | 0.1                        | 28.6                      | ECEG2DG822E( ) | N                  | C               | F               |
|             | 12000                        | 77           | 125            | 12.5  | 0.1                        | 31.8                      | ECEG2DG123D( ) | N                  | C               | F               |
|             | 15000                        | 77           | 145            | 14.8  | 0.1                        | 31.8                      | ECEG2DG153C( ) | N                  | C               | F               |
| 18000       | 90                           | 150          | 19.0           | 0.1   | 31.8                       | ECEG2DG183A( )            | N              |                    | F               |                 |
| 250         | 1000                         | 36           | 83             | 1.62  | 0.1                        | 13.0                      | ECEG2EG102P( ) | N                  | F               |                 |
|             | 1200                         | 36           | 103            | 1.77  | 0.1                        | 13.0                      | ECEG2EG122N( ) | N                  | F               |                 |
|             | 1500                         | 36           | 125            | 2.47  | 0.1                        | 13.0                      | ECEG2EG152M( ) | N                  | F               |                 |
|             | 1800                         | 51           | 83             | 2.78  | 0.1                        | 22.0                      | ECEG2EG182L( ) | N                  | C               | F               |
|             | 2700                         | 51           | 103            | 3.81  | 0.1                        | 22.0                      | ECEG2EG272K( ) | N                  | C               | F               |
|             | 3300                         | 51           | 125            | 4.77  | 0.1                        | 22.0                      | ECEG2EG332J( ) | N                  | C               | F               |
|             | 3900                         | 51           | 145            | 5.68  | 0.1                        | 22.0                      | ECEG2EG392H( ) | N                  | C               | F               |
|             |                              | 64           | 103            | 5.68  | 0.1                        | 28.6                      | ECEG2EG392G( ) | N                  | C               | F               |
|             | 4700                         | 64           | 125            | 7.16  | 0.1                        | 28.6                      | ECEG2EG472F( ) | N                  | C               | F               |
|             | 5600                         | 64           | 145            | 8.30  | 0.1                        | 28.6                      | ECEG2EG562E( ) | N                  | C               | F               |
|             | 8200                         | 77           | 125            | 10.3  | 0.1                        | 31.8                      | ECEG2EG822D( ) | N                  | C               | F               |
|             | 10000                        | 77           | 145            | 12.3  | 0.1                        | 31.8                      | ECEG2EG103C( ) | N                  | C               | F               |
| 12000       | 90                           | 150          | 15.8           | 0.1   | 31.8                       | ECEG2EG123A( )            | N              |                    | F               |                 |
| 350         | 470                          | 36           | 83             | 1.10  | 0.1                        | 13.0                      | ECEG2VG471P( ) | N                  | F               |                 |
|             | 680                          | 36           | 103            | 1.52  | 0.1                        | 13.0                      | ECEG2VG681N( ) | N                  | F               |                 |
|             | 820                          | 36           | 125            | 1.84  | 0.1                        | 13.0                      | ECEG2VG821M( ) | N                  | F               |                 |

Endurance : 105°C 2000 h

Design, Specifications are subject to change without notice. Ask factory for technical specifications before purchase and/or use. Whenever a doubt about safety arises from this product, please inform us immediately for technical consultation without fail.

■ Standard Products

Discontinued

| W.V.<br>(V) | Cap.<br>(10 to +30%)<br>( $\mu$ F) | Case size    |                | Specification                                |                            | Terminal       | Part No.       | (:) Mounting Clamp |    |                 |                 |
|-------------|------------------------------------|--------------|----------------|--|----------------------------|----------------|----------------|--------------------|----|-----------------|-----------------|
|             |                                    | Dia.<br>(mm) | Length<br>(mm) | Ripple current<br>(120Hz)<br>(+105°C)<br>(A) | D.F.<br>(120Hz)<br>(+20°C) | Pitch<br>(mm)  |                |                    | No | 2point<br>clamp | 3point<br>clamp |
|             |                                    |              |                |  |                            |                |                |                    |    |                 |                 |
| 350         | 1000                               | 51           | 83             | 2.07   | 0.1                        | 22.0           | ECEG2VG102L( ) | N                  | C  | F               |                 |
|             | 1200                               | 51           | 103            | 2.52   | 0.1                        | 22.0           | ECEG2VG122K( ) | N                  | C  | F               |                 |
|             | 1500                               | 51           | 125            | 3.18   | 0.1                        | 22.0           | ECEG2VG152J( ) | N                  | C  | F               |                 |
|             | 1800                               | 51           | 145            | 3.75   | 0.1                        | 22.0           | ECEG2VG182H( ) | N                  | C  | F               |                 |
|             |                                    |              | 64             | 103  | 3.75                       | 0.1            | 28.6           | ECEG2VG182G( )     | N  | C               | F               |
|             | 2200                               | 64           | 125            | 4.89   | 0.1                        | 28.6           | ECEG2VG222F( ) | N                  | C  | F               |                 |
|             | 2700                               | 64           | 145            | 5.74   | 0.1                        | 28.6           | ECEG2VG272E( ) | N                  | C  | F               |                 |
|             | 3900                               | 77           | 125            | 7.16   | 0.1                        | 31.8           | ECEG2VG392D( ) | N                  | C  | F               |                 |
|             | 4700                               | 77           | 145            | 8.53   | 0.1                        | 31.8           | ECEG2VG472C( ) | N                  | C  | F               |                 |
| 6800        | 90                                 | 150          | 12.1           | 0.1  | 31.8                       | ECEG2VG682A( ) | N              |                    | F  |                 |                 |
| 400         | 390                                | 36           | 83             | 1.08   | 0.1                        | 13.0           | ECEG2GG391P( ) | N                  | F  |                 |                 |
|             | 470                                | 36           | 103            | 1.32   | 0.1                        | 13.0           | ECEG2GG471N( ) | N                  | F  |                 |                 |
|             | 560                                | 36           | 125            | 1.62   | 0.1                        | 13.0           | ECEG2GG561M( ) | N                  | F  |                 |                 |
|             | 820                                | 51           | 83             | 1.90   | 0.1                        | 22.0           | ECEG2GG821L( ) | N                  | C  | F               |                 |
|             | 1000                               | 51           | 103            | 2.41   | 0.1                        | 22.0           | ECEG2GG102K( ) | N                  | C  | F               |                 |
|             | 1200                               | 51           | 125            | 2.83   | 0.1                        | 22.0           | ECEG2GG122J( ) | N                  | C  | F               |                 |
|             | 1500                               | 51           | 145            | 3.45   | 0.1                        | 22.0           | ECEG2GG152H( ) | N                  | C  | F               |                 |
|             | 1800                               | 64           | 103            | 4.08   | 0.1                        | 28.6           | ECEG2GG182G( ) | N                  | C  | F               |                 |
|             | 2200                               | 64           | 125            | 4.94   | 0.1                        | 28.6           | ECEG2GG222F( ) | N                  | C  | F               |                 |
|             | 2700                               | 64           | 145            | 5.75   | 0.1                        | 28.6           | ECEG2GG272E( ) | N                  | C  | F               |                 |
|             | 3300                               | 77           | 125            | 6.63   | 0.1                        | 31.8           | ECEG2GG332D( ) | N                  | C  | F               |                 |
|             | 3900                               | 77           | 145            | 7.79   | 0.1                        | 31.8           | ECEG2GG392C( ) | N                  | C  | F               |                 |
| 5600        | 90                                 | 150          | 11.1           | 0.1  | 31.8                       | ECEG2GG562A( ) | N              |                    | F  |                 |                 |

Endurance : 105°C 2000 h