

**PLEASE CHECK WWW.MOLEX.COM FOR LATEST PART INFORMATION**

**Part Number:** [0681830001](#)  
**Status:** **Active**  
**Description:** 6.25 mm (.246") Pitch, 24 Pin DVI Single Link Digital Plug, Transmitter

**Documents:**

[Drawing \(PDF\)](#) [RoHS Certificate of Compliance \(PDF\)](#)  
[Product Specification PS-68183-001 \(PDF\)](#)

**General**

Product Family	I/O Connectors
Series	<a href="#">68183</a>
Application	Wire-to-Board
Component Type	Plug, Transmitter
Product Name	N/A
Type	N/A

**Physical**

Boot Color	N/A
Circuits (Loaded)	24
Circuits (maximum)	24
Durability (mating cycles max)	200
Gender	Plug
Keying to Mating Part	None
Lock to Mating Part	No
Material - Plating Mating	Gold
Number of Rows	3
Orientation	Vertical
PCB Locator	No
PCB Retention	Yes
PCB Thickness Recommended (in)	0.063 In
PCB Thickness Recommended (mm)	1.60 mm
Packaging Type	Bag
Panel Mount	Yes
Pitch - Mating Interface (in)	0.246 In
Pitch - Mating Interface (mm)	6.25 mm
Pitch - Term. Interface (in)	0.246 In
Pitch - Term. Interface (mm)	6.25 mm
Polarized to Mating Part	Yes
Polarized to PCB	N/A
Ports	1
Surface Mount Compatible (SMC)	No
Temperature Range - Operating	0°C to +50°C
Termination Interface: Style	Through Hole
Waterproof / Dustproof	No
Wire Insulation Diameter	N/A
Wire Size AWG	N/A

**Electrical**

Current - Maximum per Contact	0.36A
Grounding to Panel	Yes
Shielded	No
Voltage - Maximum	5.5V

**Material Info**

**Reference - Drawing Numbers**

Product Specification	PS-68183-001
-----------------------	--------------

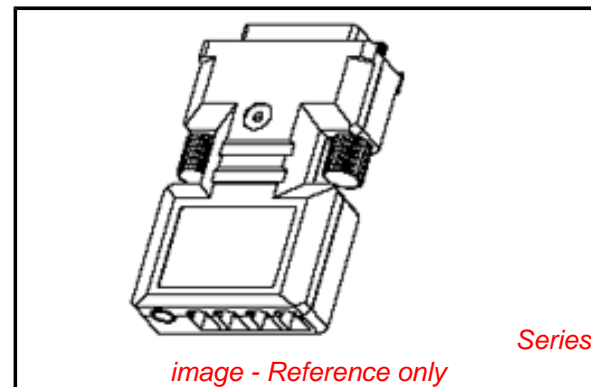

**EU RoHS**

**ELV and RoHS  
Compliant**  
**REACH SVHC**  
 Not Reviewed  
**Halogen-Free**  
**Status**  
 Not Reviewed

**China RoHS**



**Need more information on product  
environmental compliance?**

Email [productcompliance@molex.com](mailto:productcompliance@molex.com)  
 For a multiple part number RoHS Certificate of  
 Compliance, [click here](#)

Please visit the [Contact Us](#) section for any  
 non-product compliance questions.

**Search Parts in this Series**

[68183Series](#)

**Use With**

This document was generated on 04/02/2010

**PLEASE CHECK [WWW.MOLEX.COM](http://WWW.MOLEX.COM) FOR LATEST PART INFORMATION**

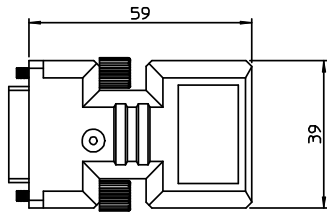

24PIN DVI  
Single Link Digital Plug

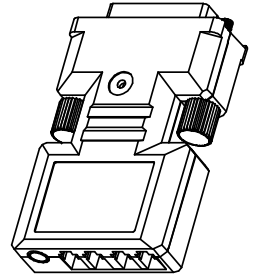
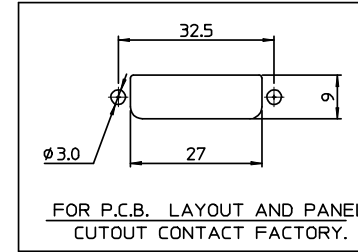
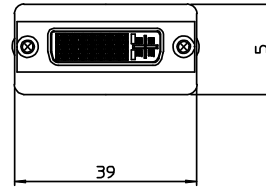

ISOMETRIC VIEW

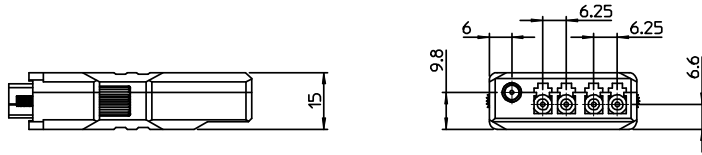

NOTES

- PRODUCT SPECIFICATION NO. : PS-68183-001
- APPLICATION  
 BESIDES THE TRANSMITTER, RECEIVER,  
 FOLLOWING ACCESSARIES ARE NECESSARY  
 TO USE.  
 - AC-DC POWER ADAPTER : 68183-0005 (USA)  
   68183-0006 (UK)  
   68183-0007 (EUROPE)  
 (POWER ADAPTERS MUST BE PURCHASED SEPERATELY)
- LC DUPLEX CABLE ASSEMBLY : CONTACT FACTORY OR REFER TO PS.

AC-DC POWER  
ADAPTER

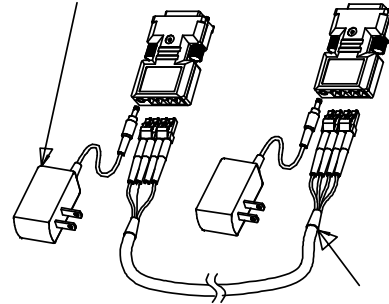

Application Example

LC DUPLEX  
CABLE ASS'Y"

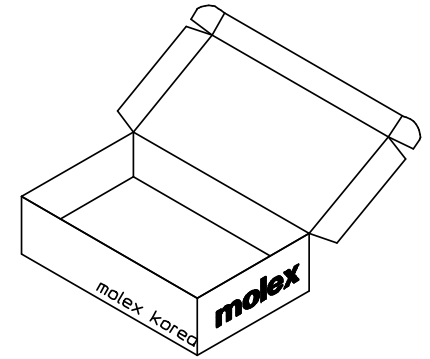
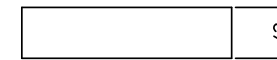
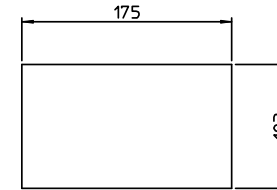

Packaging BOX Dimension  
Scale 0.5:1

TABLE A

NO	DISCRIPTION	ENG NO	MATERIAL NO	CABLE LENGTH
2	RECEIVER	68183-0002	681830002	500 Meter MAX.
1	TRANSMITTER	68183-0001	681830001	

REVISED EC NO: KOR2008-0177 DRWN:HJJEONG 2008/06/11 CHKD:YSOOKIM 2008/06/11 APPR:YUNSIKKIM 2008/06/12	DESCRIPTION REV	QUALITY SYMBOLS $\nabla=0$ $\nabla=0$	GENERAL TOLERANCES (UNLESS SPECIFIED)	DIMENSION STYLE MM ONLY	SCALE 1:1	DESIGN UNITS METRIC	THIRD ANGLE PROJECTION
		mm    INCH	DRAWN BY    DATE YSOOKIM    020330	TITLE OPTICAL GRAPHIC EXTENSION MODULE TX			
		4 PLACES $\pm$ --- $\pm$ --- 3 PLACES $\pm$ --- $\pm$ --- 2 PLACES $\pm$ --- $\pm$ --- 1 PLACE $\pm$ --- $\pm$ ---	CHECKED BY    DATE YSIKKIM    020330	MOLEX INCORPORATED			
		ANGULAR $\pm$ --- °	APPROVED BY    DATE CWLEE    020330	MATERIAL NO. SEE TABLE	DOCUMENT NO. SD-68183-001	SHEET NO. 1 OF 1	

DRAFT WHERE APPLICABLE  
MUST REMAIN  
WITHIN DIMENSIONS

SIZE  
A2  
THIS DRAWING CONTAINS INFORMATION THAT IS PROPRIETARY TO MOLEX  
INCORPORATED AND SHOULD NOT BE USED WITHOUT WRITTEN PERMISSION