

# Sharma Potentiometers

## WIW3362 Trimmer Potentiometer

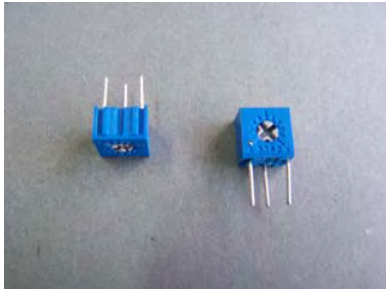

### Features

- 6mm Single Turn
- Cermet / Industrial / Sealed
- Top and side adjust types (P,U, W,S most popular)

### Electrical Characteristics

Standard Resistance Range  
100 to 2 Megohms  
(see standard resistance table)  
Resistance Tolerance:  $\pm 10\%$  std.  
(tighter tolerance available)  
Absolute Minimum Resistance:  
1% or 2 ohms max.  
(whichever is greater)  
Contact Resistance Variation  
3% or 3 ohms max.  
(whichever is greater)  
Adjustability  
Voltage  $\pm 0.05\%$   
Resistance  $\pm 0.15\%$   
Resolution: Infinite  
Insulation Resistance  
500 vdc  
1,000 Megohms min.  
Dielectric Strength  
101.3 kPa 500 vac  
8.5 kPa 315 vac  
Adjustment Angle:  $210^\circ$  nom.

### Environmental Characteristics

Power Rating (250 volts max.)  
0.5 watt ( $70^\circ\text{C}$ ), 0 watt ( $125^\circ\text{C}$ )  
Temperature Range  
 $-55^\circ\text{C}$  to  $+125^\circ\text{C}$   
Temperature Coefficient:  $\pm 100\text{ppm}/^\circ\text{C}$   
Vibration:  $98\text{ m/s}^2$   
(1%  $\Delta$  TR; 2%  $\Delta$  VR)  
Shock:  $390\text{ m/s}^2$   
(1%  $\Delta$  TR; 1%  $\Delta$  VR)  
Load Life  
1,000 hours 0.5 watt @  $70^\circ\text{C}$   
(3%  $\Delta$  TR; 4% or 4 ohm)  
Rotational Life: 200 cycles  
(3%  $\Delta$  TR; 4% or 4 ohm.)

### Physical Characteristics

Mechanical Angle  
 $250^\circ$  nom.  
Torque  
20 mN • m max.  
Stop Strength  
50 mN • m min.  
Terminals  
Solderable pins  
Standard Packaging  
50 pcs. per tube

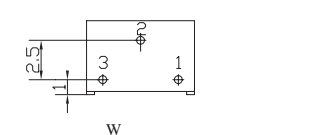
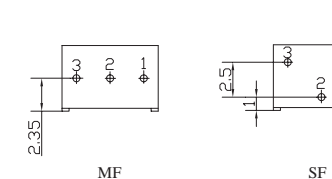
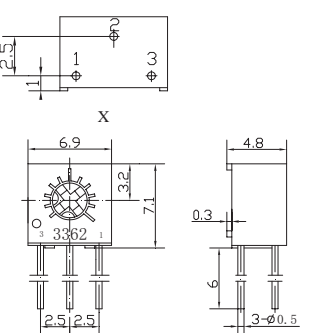
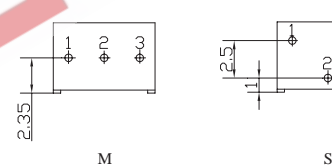
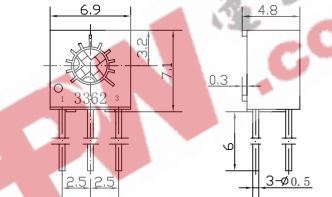
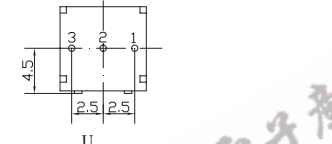
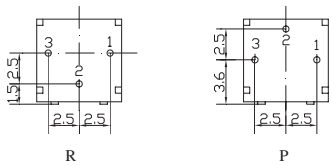
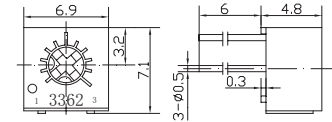

### How to order

WIW3362-P-102

Model

Style

Resistance Code

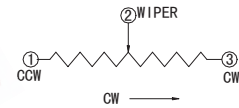

### Standard Resistance Table

| Resistance (Ohms) | Resistance Code |
|-------------------|-----------------|
| 100               | 101             |
| 200               | 201             |
| 500               | 501             |
| 1,000             | 102             |
| 2,000             | 202             |
| 5,000             | 502             |
| 10,000            | 103             |
| 20,000            | 203             |
| 25,000            | 253             |
| 50,000            | 503             |
| 100,000           | 104             |
| 200,000           | 204             |
| 250,000           | 254             |
| 500,000           | 504             |
| 1,000,000         | 105             |
| 2,000,000         | 205             |

Special resistance available

Detail Specification: Q/Ry260A-2000